

**PROFESSIONAL ENGINEER**

I hereby certify that this plan, specification, or report was prepared by me or under my direct supervision and that I am a duly Licensed Professional Engineer under the laws of the State of Minnesota.

Print Name: Thomas J. Neigum

Signature: *Thomas J. Neigum*

Date: April 10, 2006 License # 43736

SEE APPROACH SURFACE SHEETS FOR CLOSE IN APPROACH OBSTRUCTIONS.

THIS DRAWING WAS PRODUCED IN PART FROM A PHOTOGRAPHIC REPRODUCTION OF THE CURRENT U.S.G.S. QUAD MAPS THAT COVER THIS AREA.

ALL AIR CLEARANCE DATA APPLIED TO THIS DRAWING WAS TAKEN FROM PART 77 OF THE F.A.R.'s.

Rev'd.		SHEET NO.	
MAHNOMEN COUNTY AIRPORT		1-3	
MAHNOMEN COUNTY MAHNOMEN, MINNESOTA			
Kadmas Lee & Jackson		AIRSPACE ZONING PLAN (PART 77)	
Engineers, Surveyors and Planners		DRWN. BY C.A.S.	CHK'D BY TJN
		COMPUTER NO. 50504100	LAST REVISED 04/10/2006
J:\airport\50504100\CAD\plan\50504100_zone.dwg		(airspace)	
Plotted-4/10/2006-10:50am		© Kadmas, Lee & Jackson 2006	



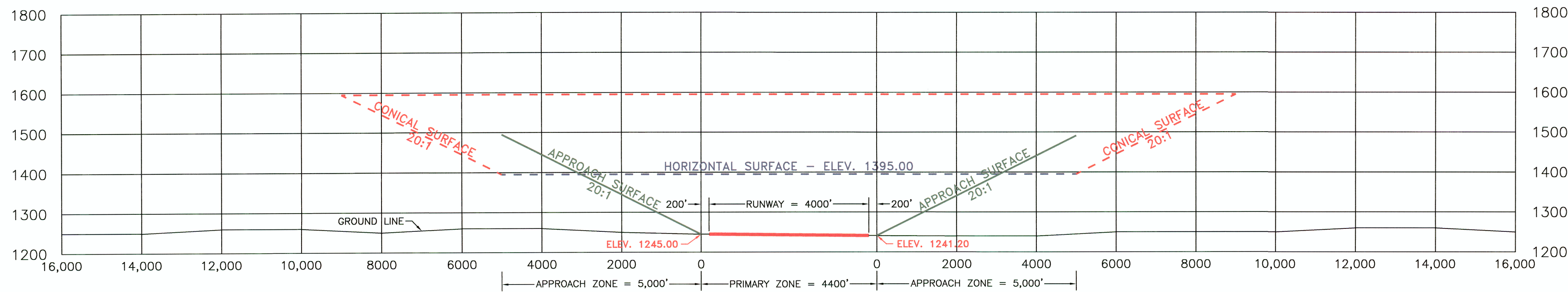

SECTION A-A

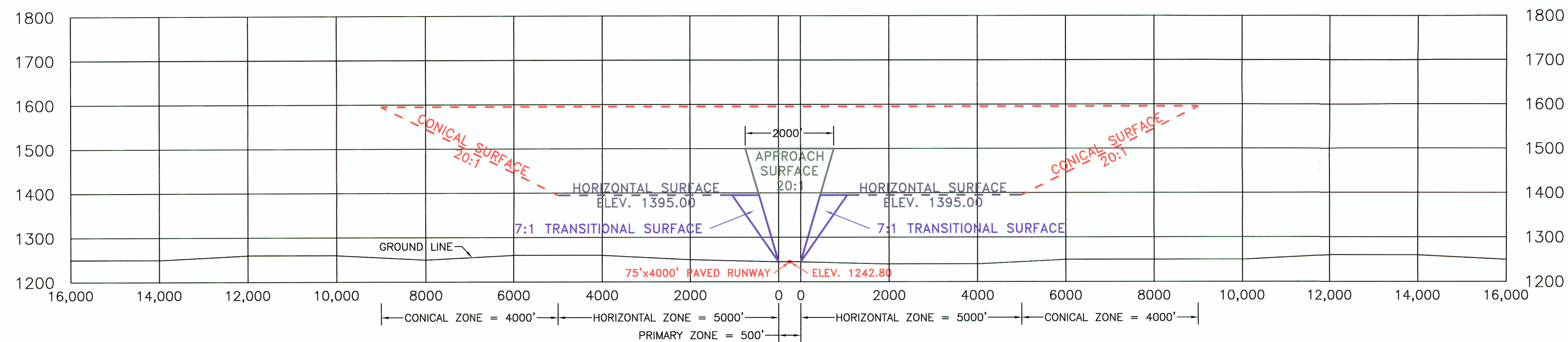

SECTION B-B

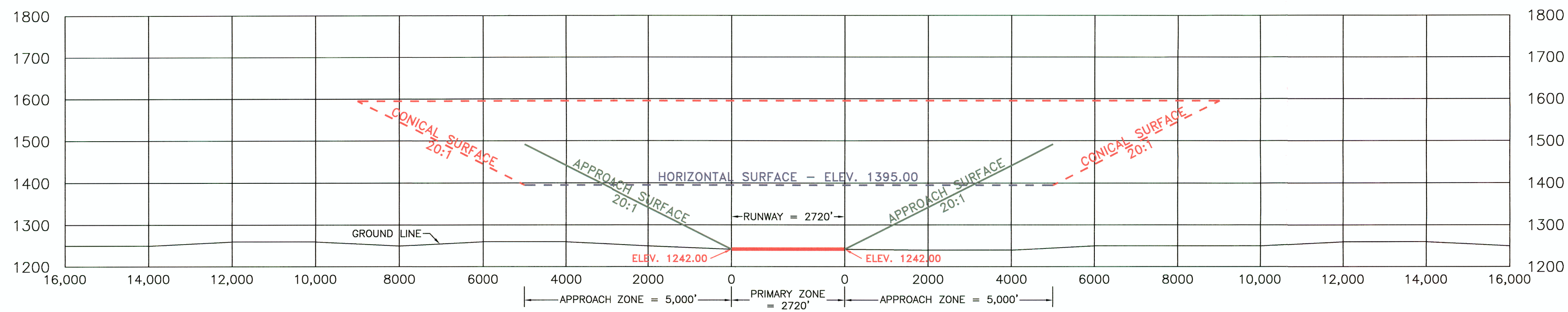

SECTION C-C

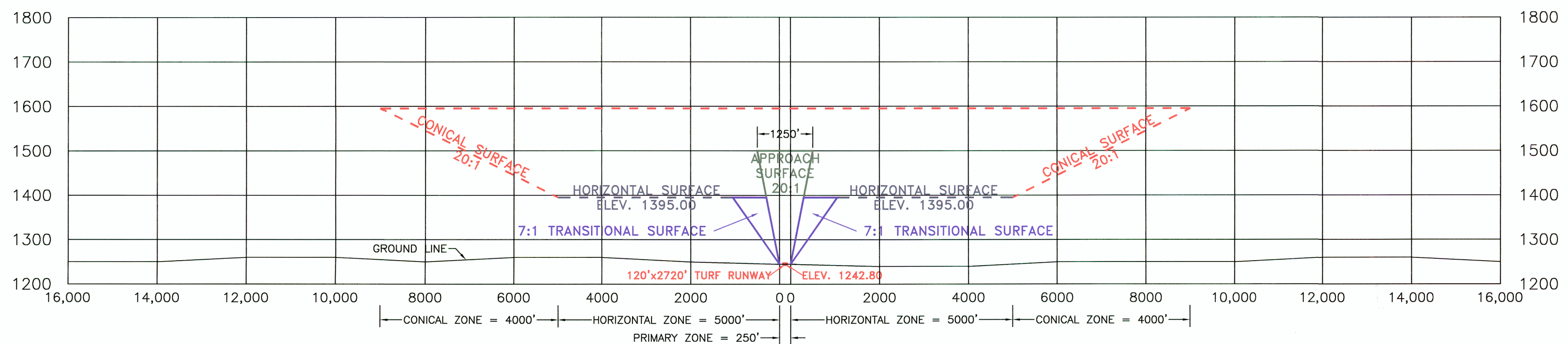

SECTION D-D

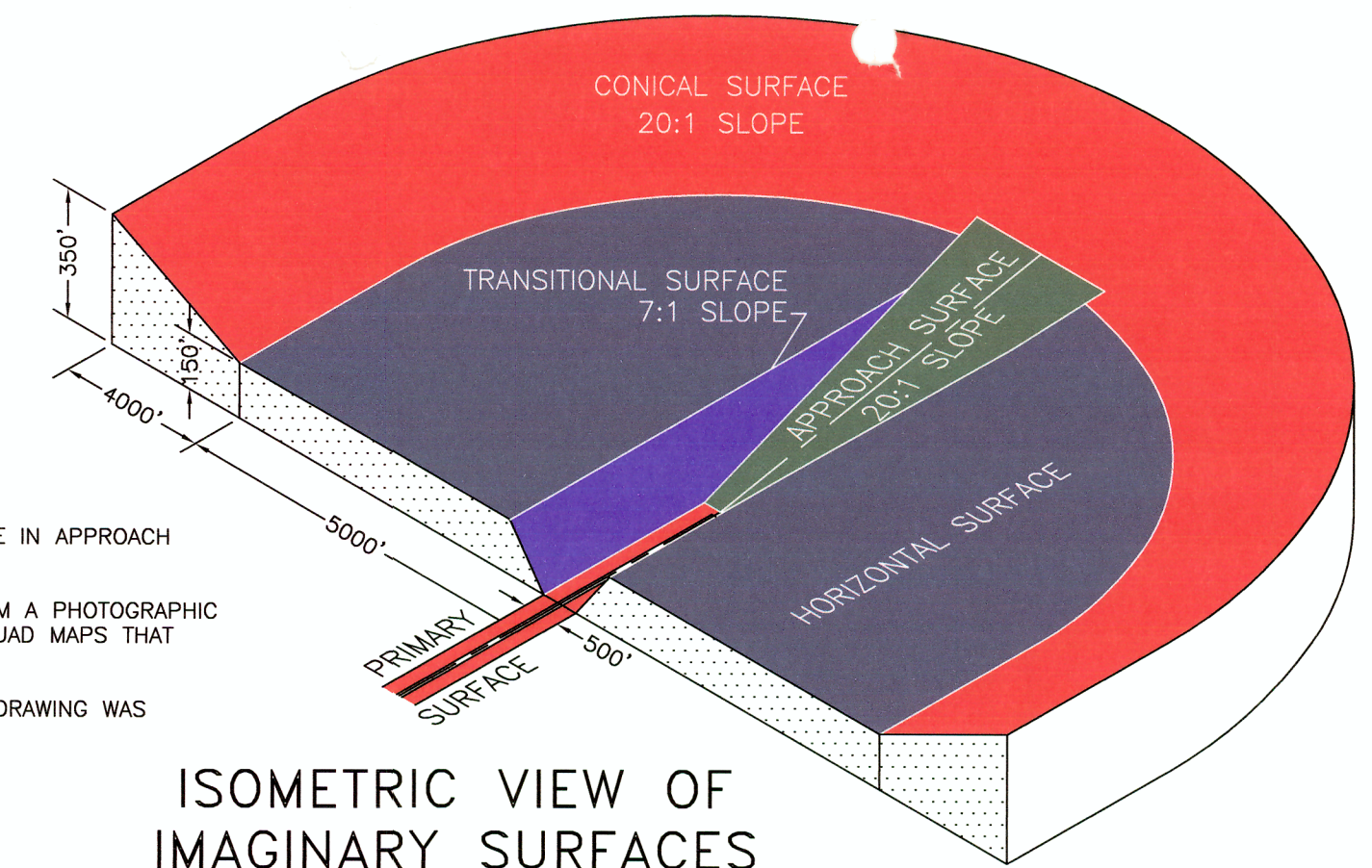

ISOMETRIC VIEW OF  
IMAGINARY SURFACES

SEE APPROACH SURFACE SHEETS FOR CLOSE IN APPROACH OBSTRUCTIONS.  
THIS DRAWING WAS PRODUCED IN PART FROM A PHOTOGRAPHIC REPRODUCTION OF THE CURRENT U.S.G.S. QUAD MAPS THAT COVER THIS AREA.  
ALL AIR CLEARANCE DATA APPLIED TO THIS DRAWING WAS TAKEN FROM PART 77 OF THE F.A.R.'s.

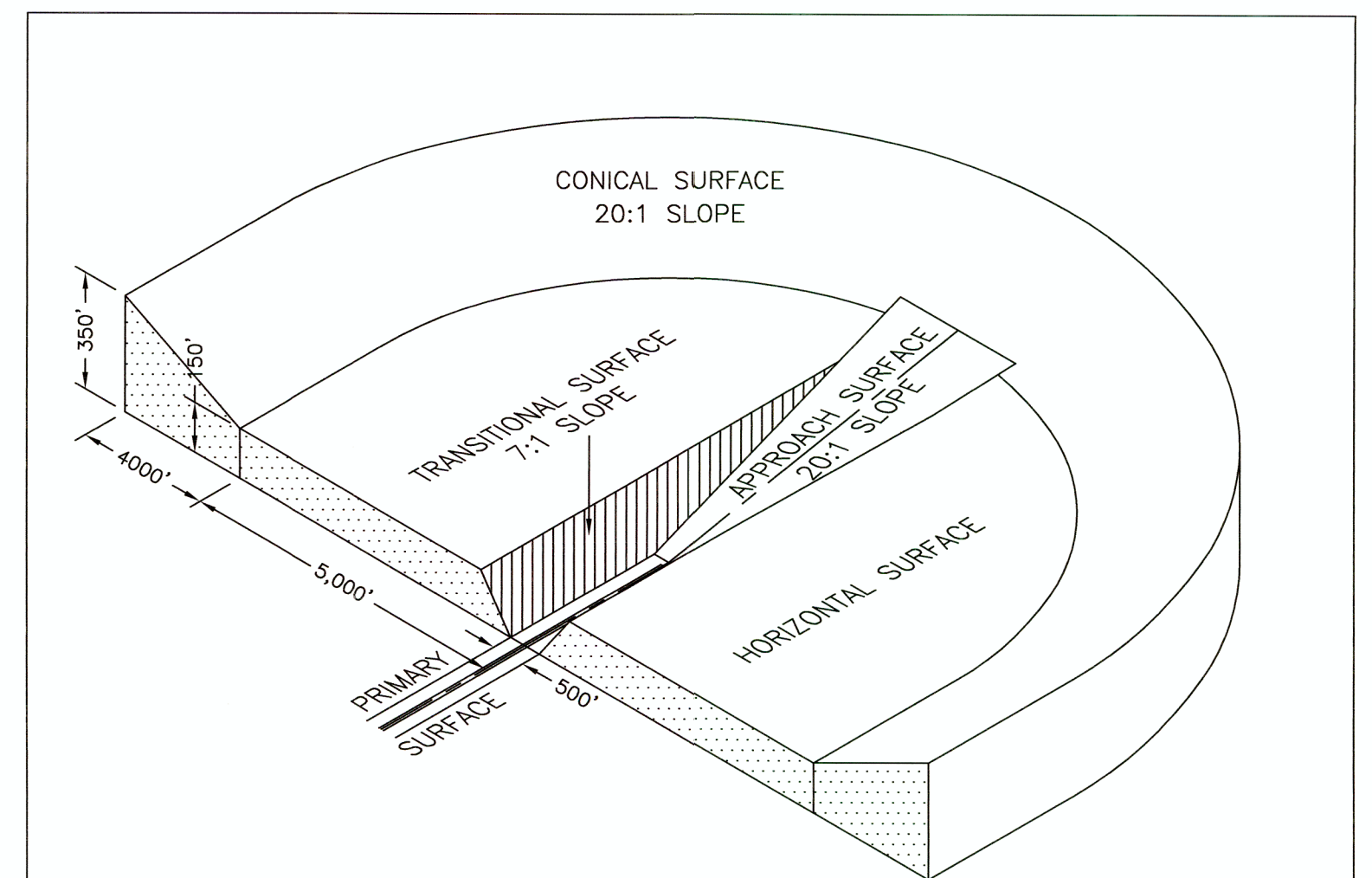

UTILITY RUNWAY  
WITH NONPRECISION INSTRUMENT APPROACH

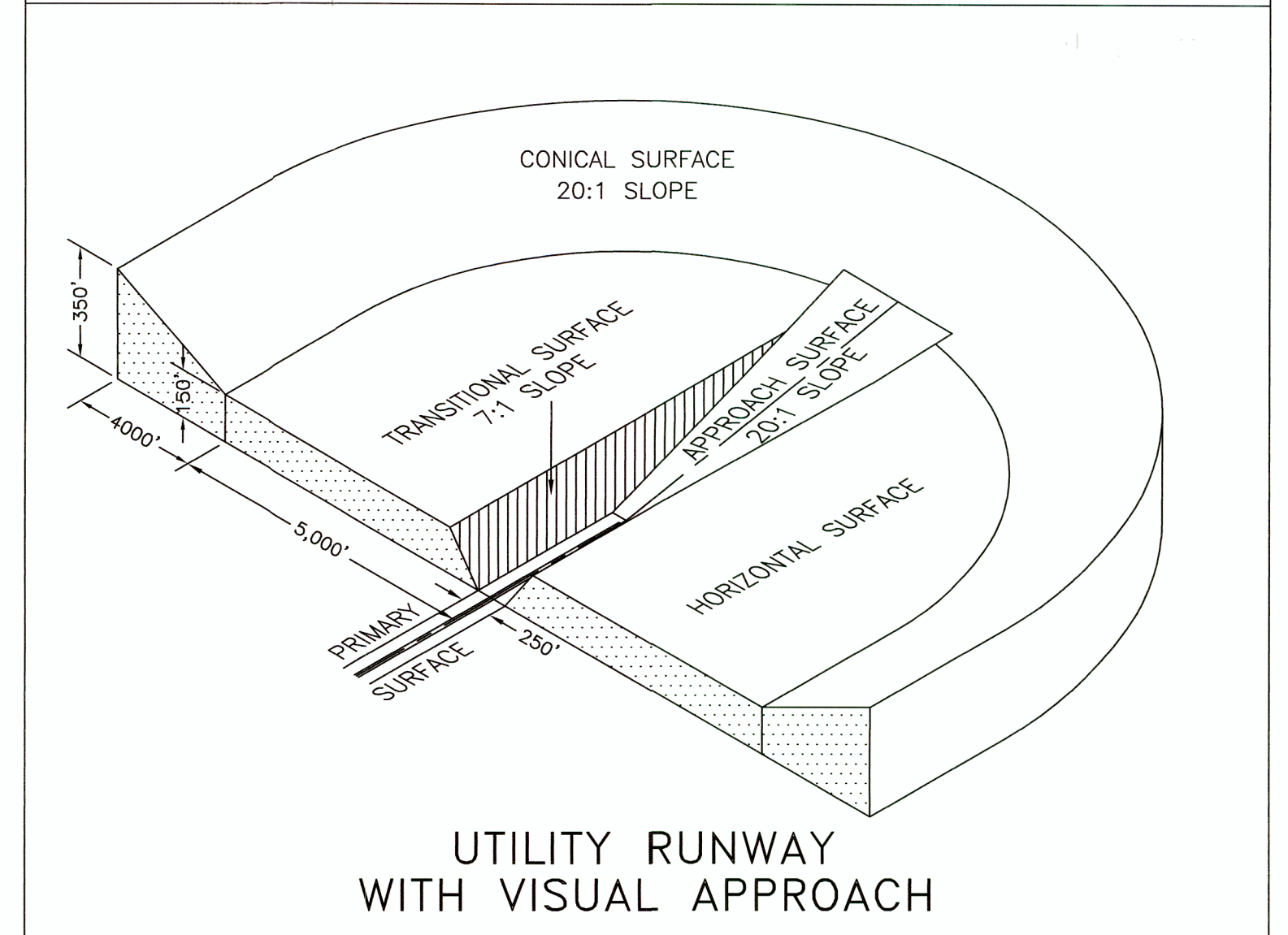

UTILITY RUNWAY  
WITH VISUAL APPROACH

### PROFESSIONAL ENGINEER

I hereby certify that this plan, specification, or report was prepared by me or under my direct supervision and that I am a duly Licensed Professional Engineer under the laws of the State of Minnesota.

Print Name: Thomas J. Neigum

Signature: *Thomas J. Neigum*

Date: *April 10, 2006* License # 43736

Rev'd.		SHEET NO.	
MAHNOMEN COUNTY AIRPORT		2-3	
MAHNOMEN COUNTY MAHNOMEN, MINNESOTA			
Kadmas Lee & Jackson		AIRSPACE SECTIONS (PART 77)	
Engineers, Surveyors and Planners			
DRWN. BY C.A.S.	CHK'D BY TJN	COMPUTER NO. 50504100	LAST REVISED 04/10/2006
J:\airport\50504100\CAD\plan\50504100_zone.dwg		(airspace)	
Plotted-4/10/2006-10:50am		© Kadmas, Lee & Jackson 2006	



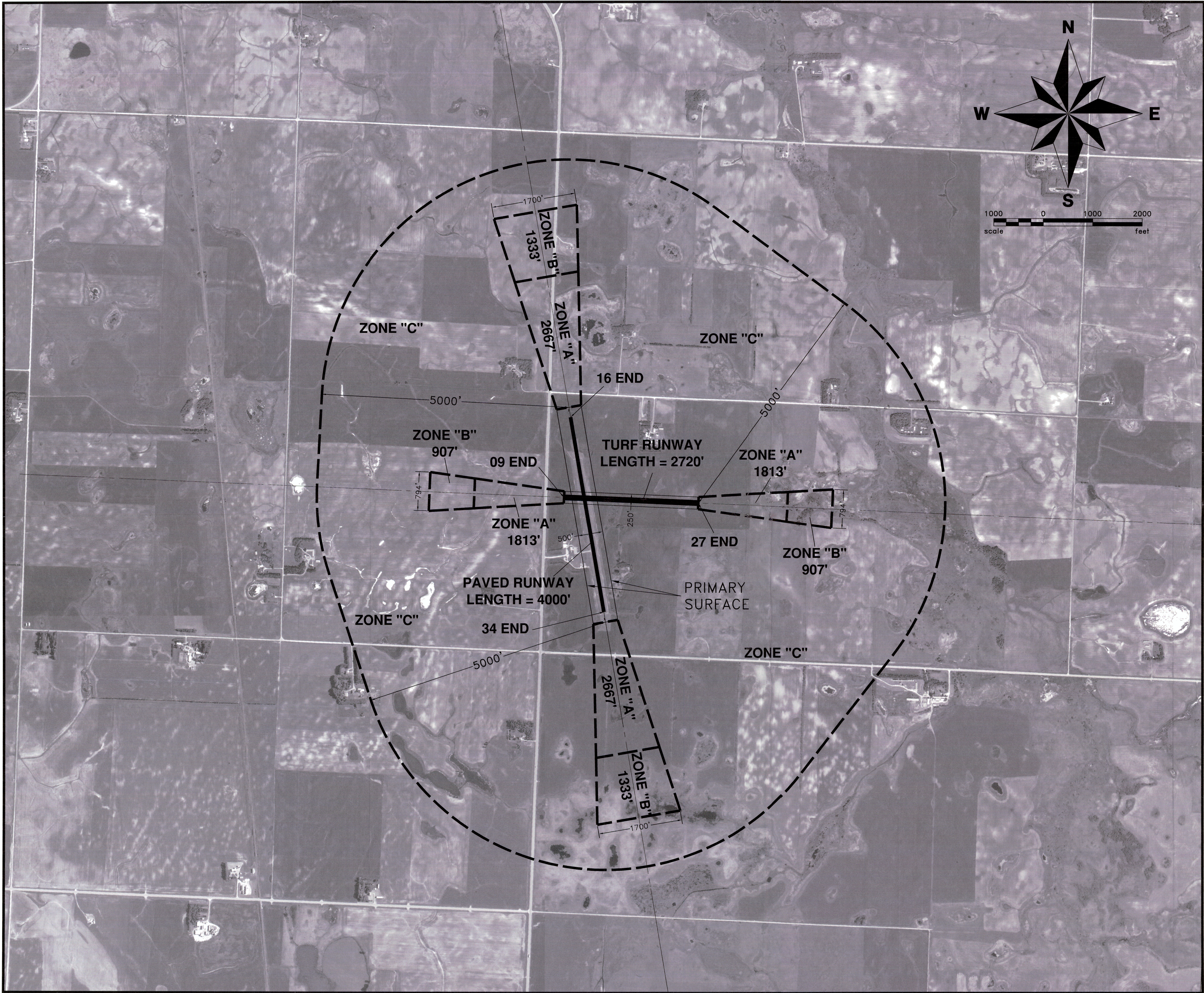

PROFESSIONAL ENGINEER

I hereby certify that this plan, specification, or report was prepared by me or under my direct supervision and that I am a duly Licensed Professional Engineer under the laws of the State of Minnesota.

Print Name: Thomas J. Neigum

Signature: *Thomas J. Neigum*

Date: *April 10, 2006* License # 43736

GENERAL RESTRICTIONS  
NO USE SHALL BE MADE OF ANY LAND IN ANY OF THE SAFETY ZONES WHICH CREATES OR CAUSES INTERFERENCE WITH THE OPERATION OF RADIO OR ELECTRONIC FACILITIES ON THE AIRPORT OR WITH RADIO OR ELECTRONIC COMMUNICATIONS BETWEEN THE AIRPORT AND AIRCRAFT, MAKES IT DIFFICULT FOR PILOTS TO DISTINGUISH BETWEEN AIRPORT LIGHTS AND OTHER LIGHTS, RESULTS IN GLARE IN THE EYES OF PILOTS USING THE AIRPORT, IMPAIRS VISIBILITY IN THE VICINITY OF THE AIRPORT, OR OTHERWISE ENDANGERS THE LANDING, TAKE OFF, OR MANEUVERING OF AIRCRAFT.

SAFETY ZONE "A"  
SHALL CONTAIN NO BUILDINGS, TEMPORARY STRUCTURES, EXPOSED TRANSMISSION LINES, OR OTHER SIMILAR LAND USE STRUCTURAL HAZARDS, AND SHALL BE RESTRICTED TO THOSE USES WHICH WILL NOT CREATE, ATTRACT, OR BRING TOGETHER AN ASSEMBLY OF PERSONS THEREON. PERMITTED USES MAY INCLUDE, BUT ARE NOT LIMITED TO SUCH USES AS AGRICULTURE (SEASONAL CROPS), HORTICULTURE, RAISING OF LIVESTOCK, ANIMAL HUSBANDRY, WILDLIFE HABITAT, LIGHT OUTDOOR RECREATION (NONSPECTATOR), CEMETERIES, AND AUTO PARKING.

SAFETY ZONE "B"  
SHALL BE RESTRICTED IN USE AS FOLLOWS. EACH USE SHALL BE ON A SITE WHOSE AREA SHALL NOT BE LESS THAN THREE ACRES. EACH USE SHALL NOT CREATE, ATTRACT, OR BRING TOGETHER A SITE POPULATION THAT WOULD EXCEED 15 TIMES THAT OF THE SITE ACREAGE. EACH SITE SHALL HAVE NO MORE THAN ONE BUILDING PLOT UPON WHICH ANY NUMBER OF STRUCTURES MAY BE ERECTED.  
THE FOLLOWING USES ARE SPECIFICALLY PROHIBITED IN ZONE "B": CHURCHES, HOSPITALS, SCHOOLS, THEATERS, STADIUMS, HOTELS AND MOTELS, TRAILER COURTS, CAMP GROUNDS, AND OTHER PLACES OF PUBLIC OR SEMIPUBLIC ASSEMBLY.

SAFETY ZONE "C"  
IS SUBJECT ONLY TO THE GENERAL RESTRICTIONS. SAFETY ZONE "C" IS ENCLOSED WITHIN THE PERIMETER OF THE HORIZONTAL ZONE.

AIRPORT ZONING DIMENSIONS						
RWY. END	LENGTH ZONE A	INNER WIDTH ZONE A	OUTER WIDTH ZONE A	LENGTH ZONE B	INNER WIDTH ZONE B	OUTER WIDTH ZONE B
16	2,667'	500'	1,300'	1,333'	1,300'	1,700'
34	2,667'	500'	1,300'	1,333'	1,300'	1,700'
9	1,813'	250'	613'	907'	613'	794'
27	1,813'	250'	613'	907'	613'	794'
ZONE C HEIGHT RESTRICTION - NO OBJECT SHALL EXCEED 1,395' MSL						

SEE APPROACH SURFACE SHEETS FOR CLOSE IN APPROACH OBSTRUCTIONS.

THIS DRAWING WAS PRODUCED IN PART FROM A PHOTOGRAPHIC REPRODUCTION OF THE CURRENT U.S.G.S. QUAD MAPS THAT COVER THIS AREA.

ALL AIR CLEARANCE DATA APPLIED TO THIS DRAWING WAS TAKEN FROM PART 77 OF THE F.A.R.'s.

Rev'd.	MAHNOMEN COUNTY AIRPORT MAHNOMEN COUNTY MAHNOMEN, MINNESOTA			SHEET NO. <b>3-3</b>
<u>Kadmas</u> <u>Lee &amp;</u> <u>Jackson</u> Engineers, Surveyors and Planners		LAND USE ZONING PLAN		
DRWN. BY C.A.S.	CHK'D BY <i>TJN</i>	COMPUTER NO. 50504100	LAST REVISED 04/10/2006	
J:\airport\50504100\CAD\plan\50504100_zone.dwg		(land_use)		
Plotted-4/10/2006-10:51am		© Kadmas, Lee & Jackson 2006		