

TOPOGRAPHICAL CONTOURS ARE AT 10' INTERVALS; INFORMATION TAKEN FROM U.S.G.S. QUADRANGLE

I HEREBY CERTIFY THAT THIS PLAN, SPECIFICALLY OR HERETOBY REFERRED TO, WAS PREPARED BY ME OR UNDER MY DIRECT SUPERVISION AND THAT I AM A FULLY LICENSED PROFESSIONAL ENGINEER UNDER THE LAWS OF THE STATE OF MINNESOTA.
William R. Meyer
 DATE 6-30-78 REG. NO. 7252

CITY OF PINE RIVER
 MUNICIPAL AIRPORT
LAND USE ZONING PLAN
 LANDECKER & ASSOC., INC.
 PEQUOT LAKES, MINNESOTA 56472

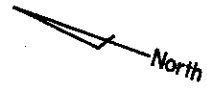
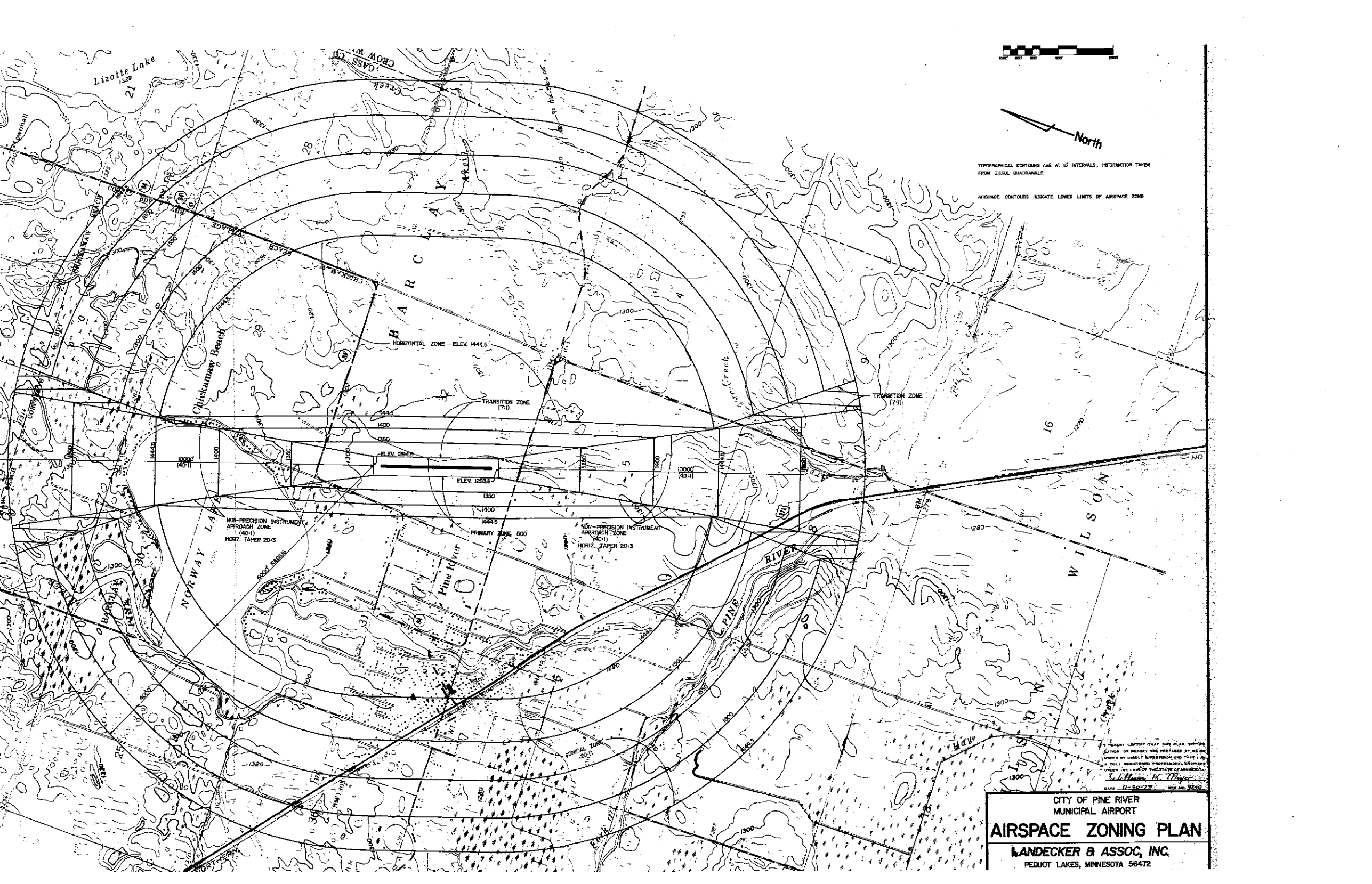

TOPOGRAPHICAL CONTOURS ARE AT 10' INTERVALS, INFORMATION TAKEN FROM U.S.G.S. QUADRANGLE

AIRSPACE CONTOURS INDICATE LOWER LIMITS OF AIRSPACE ZONE

NON-PRECISION INSTRUMENT
APPROACH ZONE
(40:1)
HORIZ. TAPER 20:5

NON-PRECISION INSTRUMENT
APPROACH ZONE
(40:1)
HORIZ. TAPER 20:5

I HEREBY CERTIFY THAT THIS PLAN, SPECIFIC
SECTION, OR PART THEREOF WAS PREPARED BY ME OR
UNDER MY DIRECT SUPERVISION AND THAT I AM
A duly registered professional engineer
under the laws of the State of Minnesota.
William H. Meyer
DATE: 11-20-72 REG. NO. 3240

CITY OF PINE RIVER
MUNICIPAL AIRPORT
AIRSPACE ZONING PLAN
LANDECKER & ASSOC, INC.
PEDIOT LAKES, MINNESOTA 56472

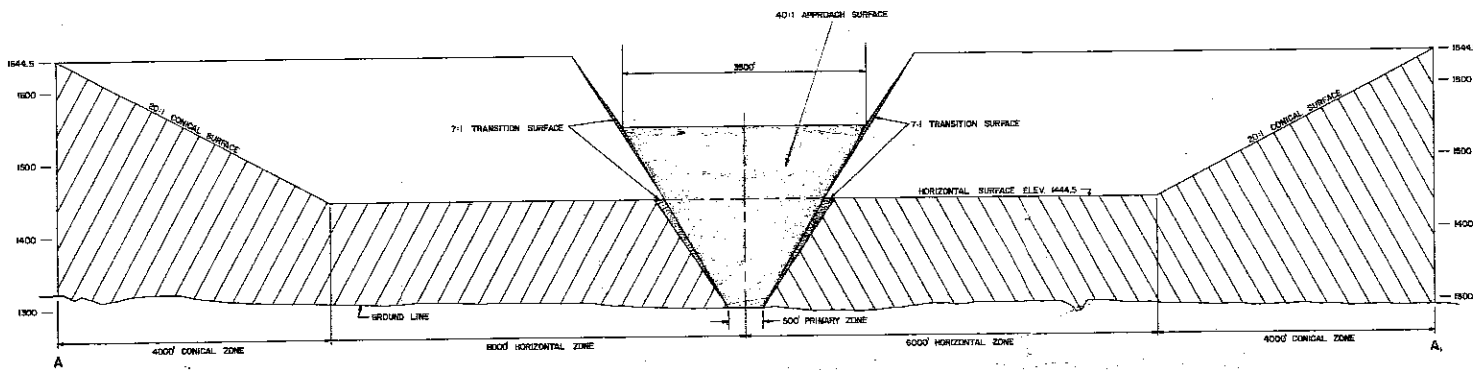

SECTION A-A

SLOPES SHOWN AS HORIZONTAL/VERTICAL

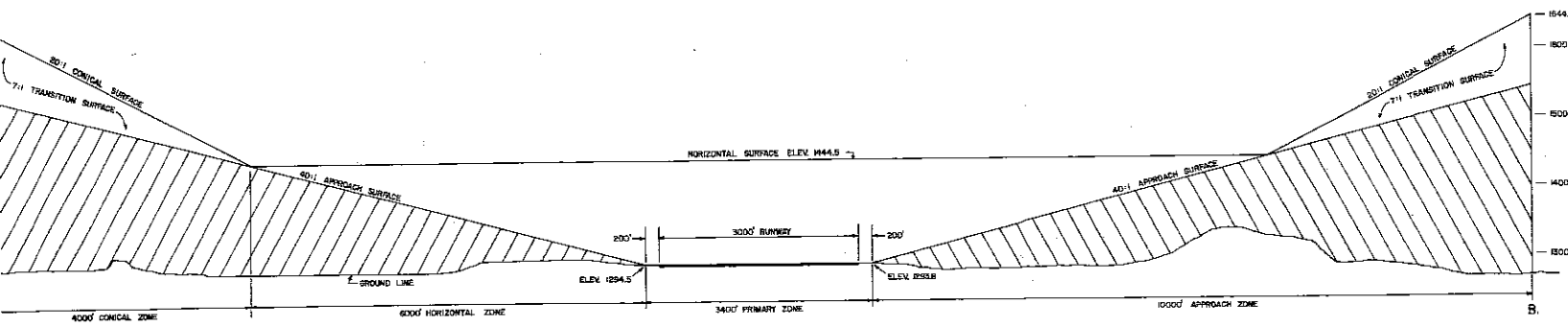

SECTION B-B

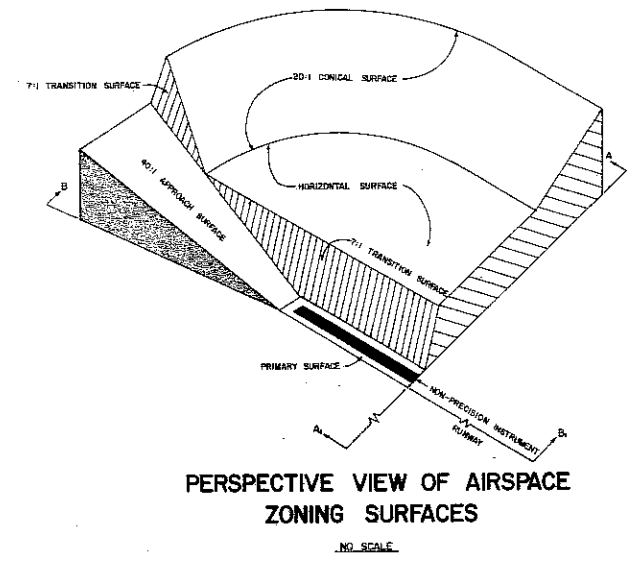

PERSPECTIVE VIEW OF AIRSPACE ZONING SURFACES

I HEREBY CERTIFY THAT THIS PLAN, SPECIFICATION OR REPORT WAS PREPARED BY ME OR UNDER MY DIRECT SUPERVISION AND THAT I AM A duly REGISTERED PROFESSIONAL ENGINEER UNDER THE LAWS OF THE STATE OF MINNESOTA.
William K. Meyer
 DATE 11-20-79 REV. NO. 0229

CITY OF PINE RIVER
 MUNICIPAL AIRPORT
AIRSPACE SECTIONS
LANDECKER & ASSOC, INC.
 PEQUOT LAKES, MINNESOTA 56472