

MUNICIPALITY OF MILAN

PREPARED BY THE
MINNESOTA DEPARTMENT OF TRANSPORTATION
OFFICE OF TRANSPORTATION SYSTEM MANAGEMENT

IN COOPERATION WITH
U.S. DEPARTMENT OF TRANSPORTATION
FEDERAL HIGHWAY ADMINISTRATION

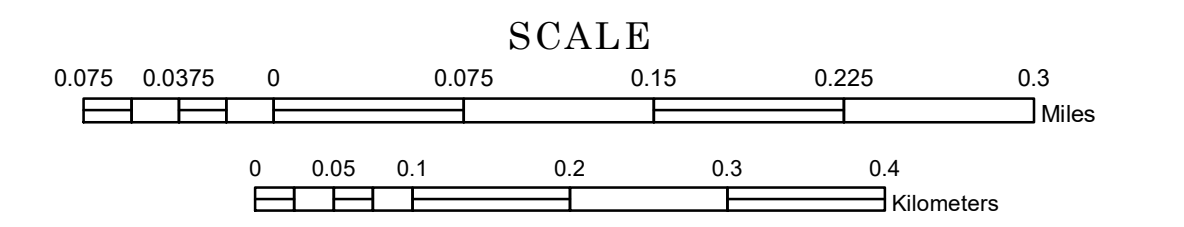

1 in = 400 ft
2023

Projection:
Transverse Mercator
NAD 1986
UTM Zone 15



North American Datum
of 1986

ROAD AND ROADWAY FEATURES	PUBLIC SERVICE FEATURES	
INTERSTATE	MINOT OFFICE	
US HIGHWAY	MINOT TRUCK STATION	
MIN HIGHWAY	HIGHWAY PATROL DISTRICT OFFICE	
COUNTY STATE AID HIGHWAY	STATE TRAVEL INFORMATION CENTER	
COUNTY ROAD	REST AREA (Full Service)	
MUNICIPAL STREET	REST AREA (Quick Turn)	
MUNICIPAL STATE AID STREET	WAYSIDE (Only on Pkwy/Torq)	
PRIVATE STREET/ROAD	PUBLIC ACCESS POINT	
TOWNSHIP ROAD	LOCAL PARK	
UNORGANIZED TERRITORY ROAD	FARMLANDS	
RAMP OR CONNECTOR	PORT OF ENTRY	
INTERSTATE EXIT	PARK AND RIDE LOT	
GREAT RIVER ROAD	PUBLIC UNIVERSITY/COLLEGE	
OTHER ROADS	PRIVATE UNIVERSITY/COLLEGE	
Farm Road	ELEMENTARY SCHOOL	
State Park	MIDDLE SCHOOL	
National Park	National Wildlife State Game	HIGH SCHOOL
State Forest		
State Game		
RAILROAD AND RAILWAY FEATURES	AVIATION FEATURES	
RAILROAD	COMMERCIAL AIRPORT	
EMPIRE BUILDER STATION (Amtrak)	GENERAL AIRPORT	
NORTHSTAR STATION (Commuter)	ARSTRIP	
LIGHT RAIL	SEAPLANE	
BLUE LINE STATION	AIRPORT RUNWAY	
GREEN LINE STATION		
INFRASTRUCTURE FEATURES	CULTURAL FEATURES	
LONG BRIDGE (100' or Greater Span)	STATE HISTORIC MARKER	
MAJOR BRIDGE (20' to 100' Span)	HISTORIC DISTRICT	
MINOR BRIDGE (0' to 20' Span)	HISTORIC SITE	
ROAD TUNNEL (100' or Greater Span)	MONUMENT	
RAILROAD TUNNEL (100' or Greater Span)	CEMETERY	
RAILROAD BRIDGE (Lesser than 100' Span)		
SKYWAY	TRIBAL LAND	
PEDESTRIAN BRIDGE	COUNTY	
PEDESTRIAN TUNNEL	MUNICIPALITY	
DAM	ADJACENT MUNICIPALITY	
LOCK AND DAM	FEDERAL ADJUSTED URBAN AREA (2014)	
PUBLIC FACILITIES	PUBLIC FACILITIES	
STATE CAPITOL	MILITARY	
FEDERAL COURTHOUSE	STATE PARK	
COUNTY COURTHOUSE	REGIONAL PARK	
ARMORY	NATIONAL FOREST	
CITY HALL	NATIONAL AND STATE FOREST	
TOWN HALL	STATE FOREST	
COMMUNITY CENTER	NATIONAL TRAIL	
ARENA	WILDLIFE REFUGE AREA	
STADIUM	WILDLIFE MANAGEMENT AREA	
POST OFFICE		
POLICE STATION		
FIRE STATION		
PUBLIC LIBRARY		
PUBLIC MUSEUM		
EVENT CENTER		
CITY CENTERS	HYDROLOGIC FEATURES	
TRIBAL GOVERNMENT CENTER	RIVER OR STREAM (Perennial)	
CITY CENTER	LAKE, POND OR RESERVOIR	
LOCALLY INCORPORATED PLACE	STREAM (Intermittent)	
UNINCORPORATED COMMUNITY	DRAINAGE DITCH	
	WETLAND	
	ISLAND OR LAND	
	REGIONAL WATERSHED	

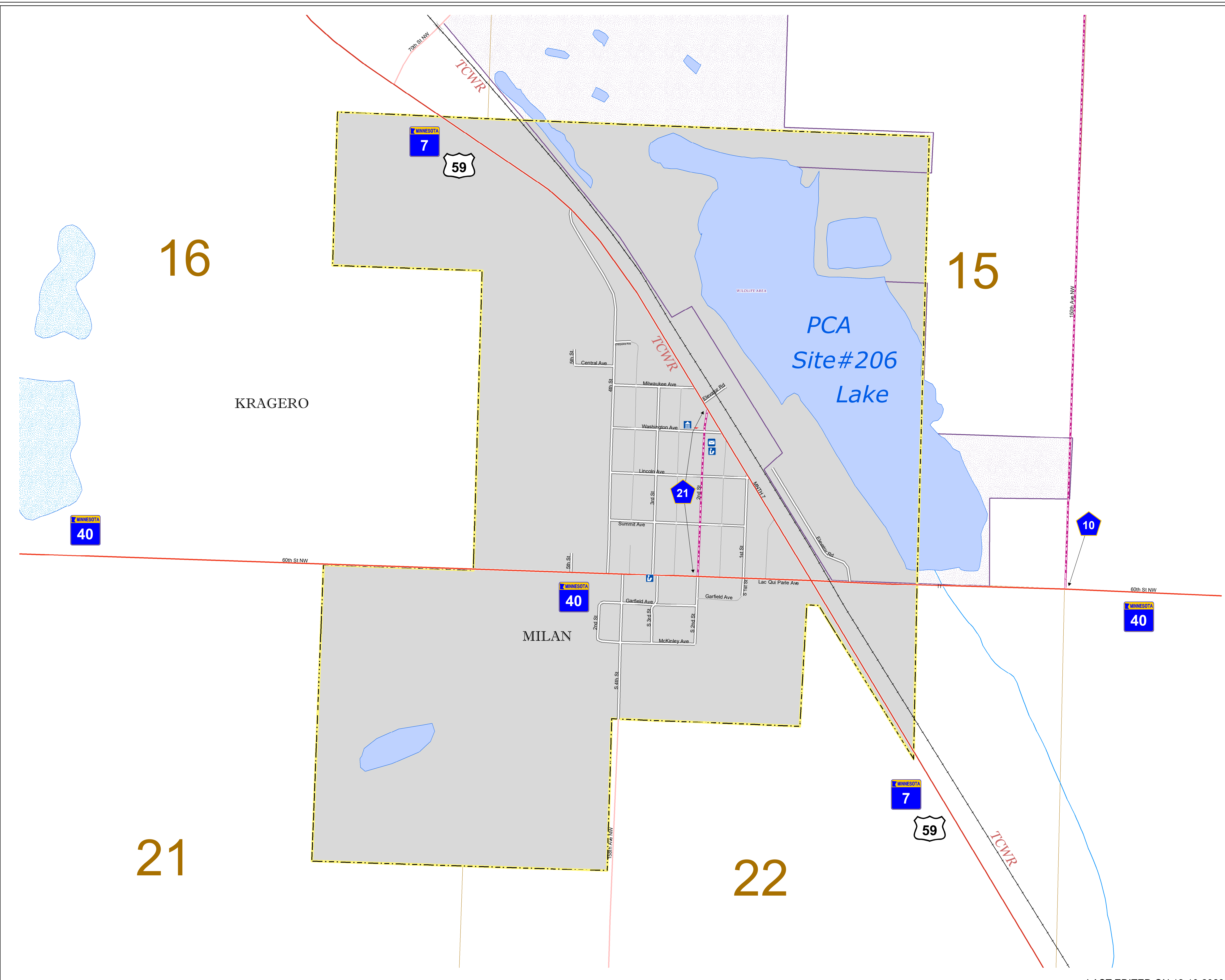
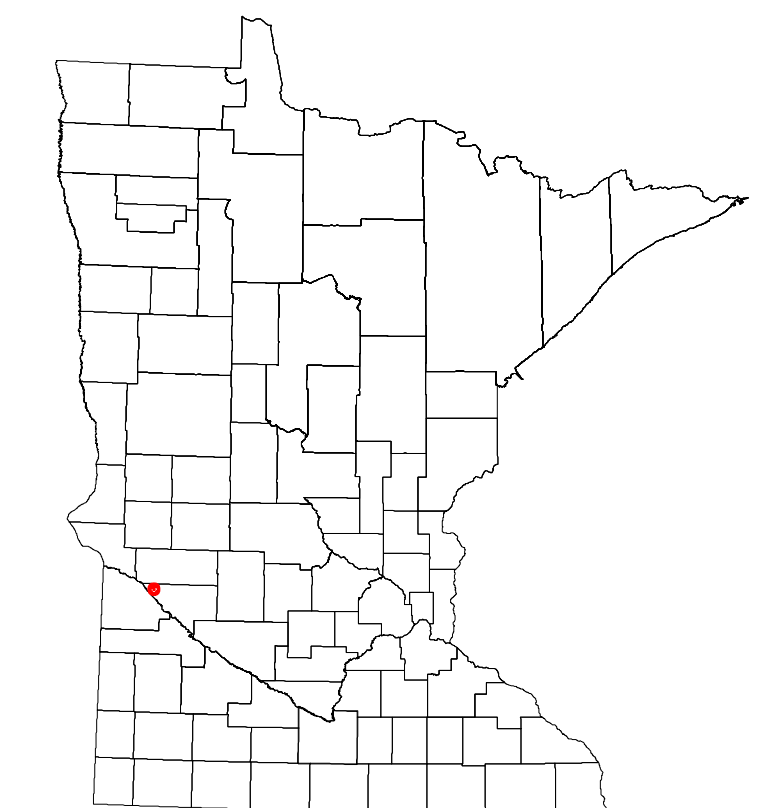

LAST EDITED ON 12-10-2023

Population (U.S. Census 2020): 428

To request information from this document in an alternative format, call 651-366-4718 or 1-800-657-3774 (Greater Minnesota); 711 or 1-800-627-3529 (Minnesota Relay). You may also send an e-mail to ADarequest.dot@state.mn.us. (Please request at least one week in advance.)