

# MUNICIPALITY OF LENGBY

PREPARED BY THE  
MINNESOTA DEPARTMENT OF TRANSPORTATION  
OFFICE OF TRANSPORTATION SYSTEM MANAGEMENT

IN COOPERATION WITH  
U.S. DEPARTMENT OF TRANSPORTATION  
FEDERAL HIGHWAY ADMINISTRATION



2023

Projection:  
Transverse Mercator  
NAD 1986  
UTM Zone 15



North American Datum  
of 1986

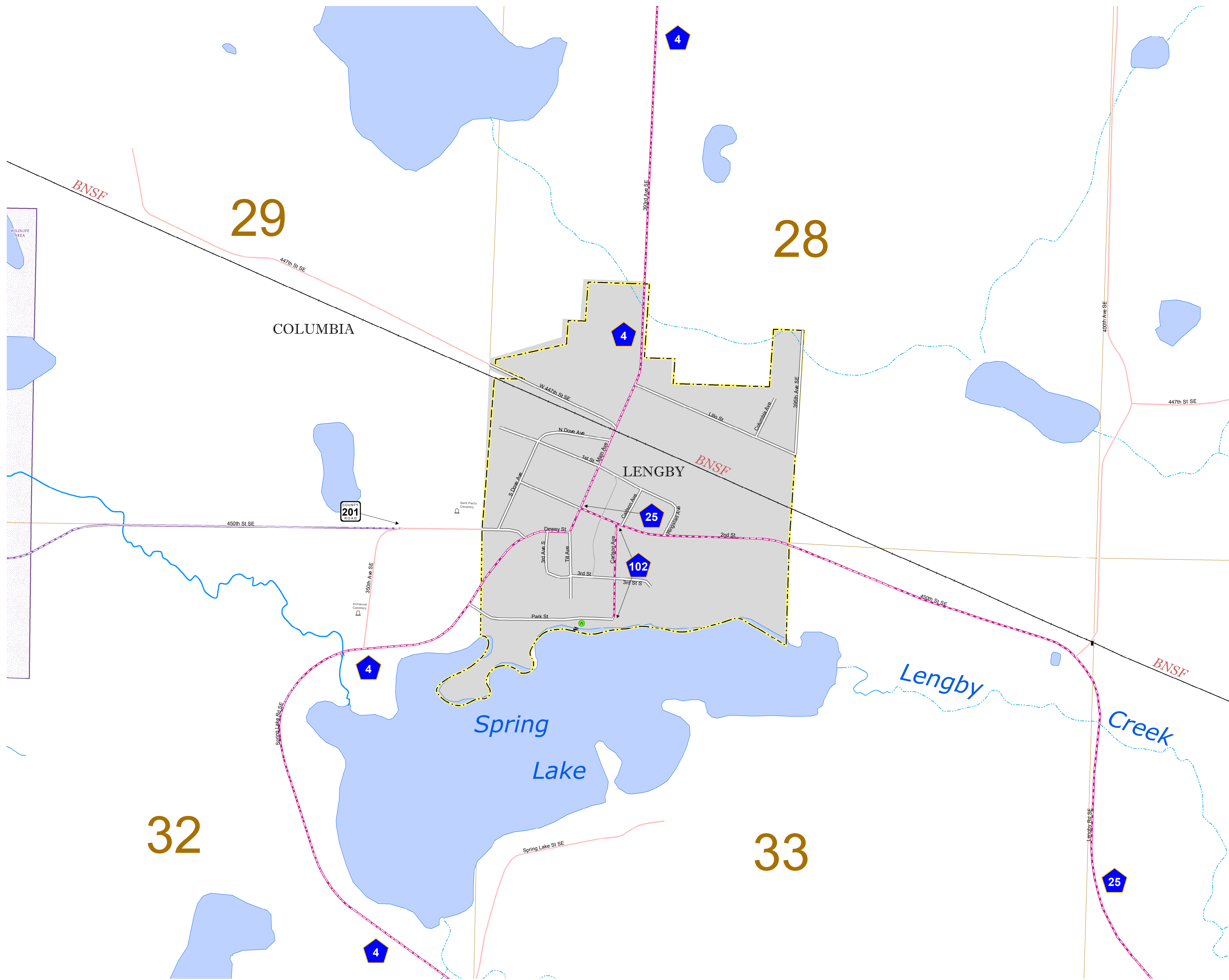

ROAD AND ROADWAY FEATURES	PUBLIC SERVICE FEATURES
INTERSTATE	MINOT OFFICE
US HIGHWAY	MINOT TRUCK STATION
BN HIGHWAY	HIGHWAY PATROL DISTRICT OFFICE
COUNTY STATE AID HIGHWAY	STATE TRAVEL INFORMATION CENTER
COUNTY ROAD	REST AREA (Full Service)
MUNICIPAL STREET	REST AREA (Quick Turn)
MUNICIPAL STATE AID STREET	WAYSIDE (Only on Pk Trunk)
PRIVATE STREET/ROAD	PUBLIC ACCESS POINT
TOWNSHIP ROAD	LOCAL PARK
UNORGANIZED TERRITORY ROAD	FARBOUNDS
RAMP OR CONNECTOR	PORT OF ENTRY
INTERSTATE EXIT	PARK AND RIDE LOT
GREAT RIVER ROAD	PUBLIC UNIVERSITY/COLLEGE
OTHER ROADS	PRIVATE UNIVERSITY/COLLEGE
FARMROAD	ELEMENTARY SCHOOL
STATE PARK	MIDDLE SCHOOL
NATIONAL MONUMENT	HIGH SCHOOL
NATIONAL FOREST	AVIATION FEATURES
STATE FOREST	COMMERCIAL AIRPORT
STATE GAME	GENERAL AIRPORT
RAILROAD AND RAILWAY FEATURES	AIRSTRIP
RAILROAD	SEAPLANE
EMPIRE BUILDER STATION (ARTIKS)	AIRPORT RUNWAY
NORTHSTAR STATION (COMMUTERS)	CULTURAL FEATURES
LIGHT RAIL	STATE HISTORIC MARKER
BLUE LINE STATION	HISTORIC DISTRICT
GREEN LINE STATION	HISTORIC SITE
INFRASTRUCTURE FEATURES	MONUMENT
LONG BRIDGE (100' OR GREATER SPAN)	CEMETERY
MAJOR BRIDGE (20' TO 100' SPAN)	BOUNDARY FEATURES
MINOR BRIDGE (5' TO 20' SPAN)	TRIBAL LAND
ROAD TUNNEL (100' OR GREATER SPAN)	COUNTY
RAILROAD TUNNEL (100' OR GREATER SPAN)	MUNICIPALITY
RAILROAD BRIDGE (LARGER THAN 100' SPAN)	ADJACENT MUNICIPALITY
SKYWAY	FEDERAL ADJUSTED URBAN AREA (2014)
PEDESTRIAN BRIDGE	MILITARY
PEDESTRIAN TUNNEL	STATE PARK
DAM	REGIONAL PARK
LOCK AND DAM	NATIONAL FOREST
PUBLIC FACILITIES	NATIONAL AND STATE FOREST
STATE CAPITOL	STATE FOREST
FEDERAL COURTHOUSE	NATIONAL TRAIL
COUNTY COURTHOUSE	WILDLIFE REFUGE AREA
ARMORY	WILDLIFE MANAGEMENT AREA
CITY HALL	HYDROLOGIC FEATURES
TOWN HALL	RIVER OR STREAM (PERENNIAL)
COMMUNITY CENTER	LAKE, POND OR RESERVOIR
ARENA	STREAM (INTERMITTENT)
STADIUM	DRAINAGE DITCH
POST OFFICE	WETLAND
POLICE STATION	ISLAND OR LAND
FIRE STATION	REGIONAL WATERSHED
PUBLIC LIBRARY	
PUBLIC MUSEUM	
EVENT CENTER	
CITY CENTERS	
TRIBAL GOVERNMENT CENTER	
CITY CENTER	
LOCALLY INCORPORATED PLACE	
UNINCORPORATED COMMUNITY	

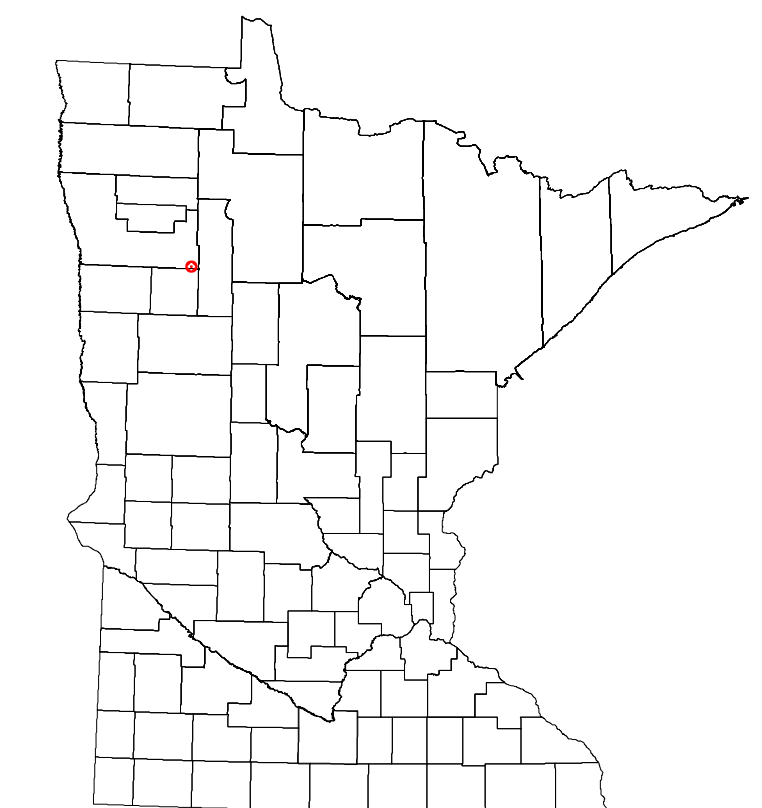

LAST EDITED ON 12-10-2023

Population (U.S. Census 2020): 92

To request information from this document in an alternative format, call 651-366-4718 or 1-800-657-3774 (Greater Minnesota); 711 or 1-800-627-3529 (Minnesota Relay). You may also send an e-mail to ADARquest.dot@state.mn.us. (Please request at least one week in advance.)