

MCGREGOR

CLARK

LAKEVIEW

TOWNSHIP OF SALO

PREPARED BY THE
MINNESOTA DEPARTMENT OF TRANSPORTATION
OFFICE OF TRANSPORTATION SYSTEM MANAGEMENT

IN COOPERATION WITH
U.S. DEPARTMENT OF TRANSPORTATION
FEDERAL HIGHWAY ADMINISTRATION

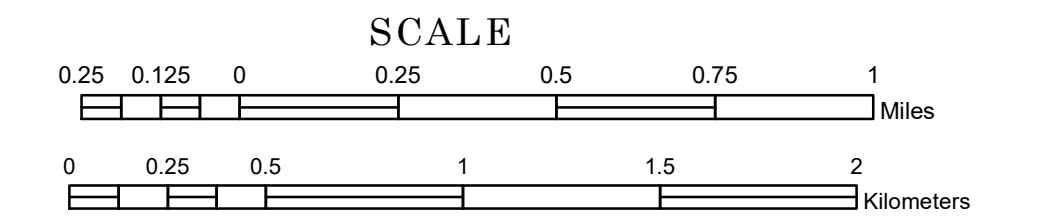

1 in = 1,600 ft
2022

Projection:
Transverse Mercator
NAD 1986
UTM Zone 15

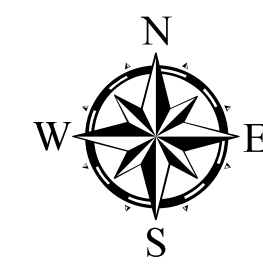

North American Datum
of 1986

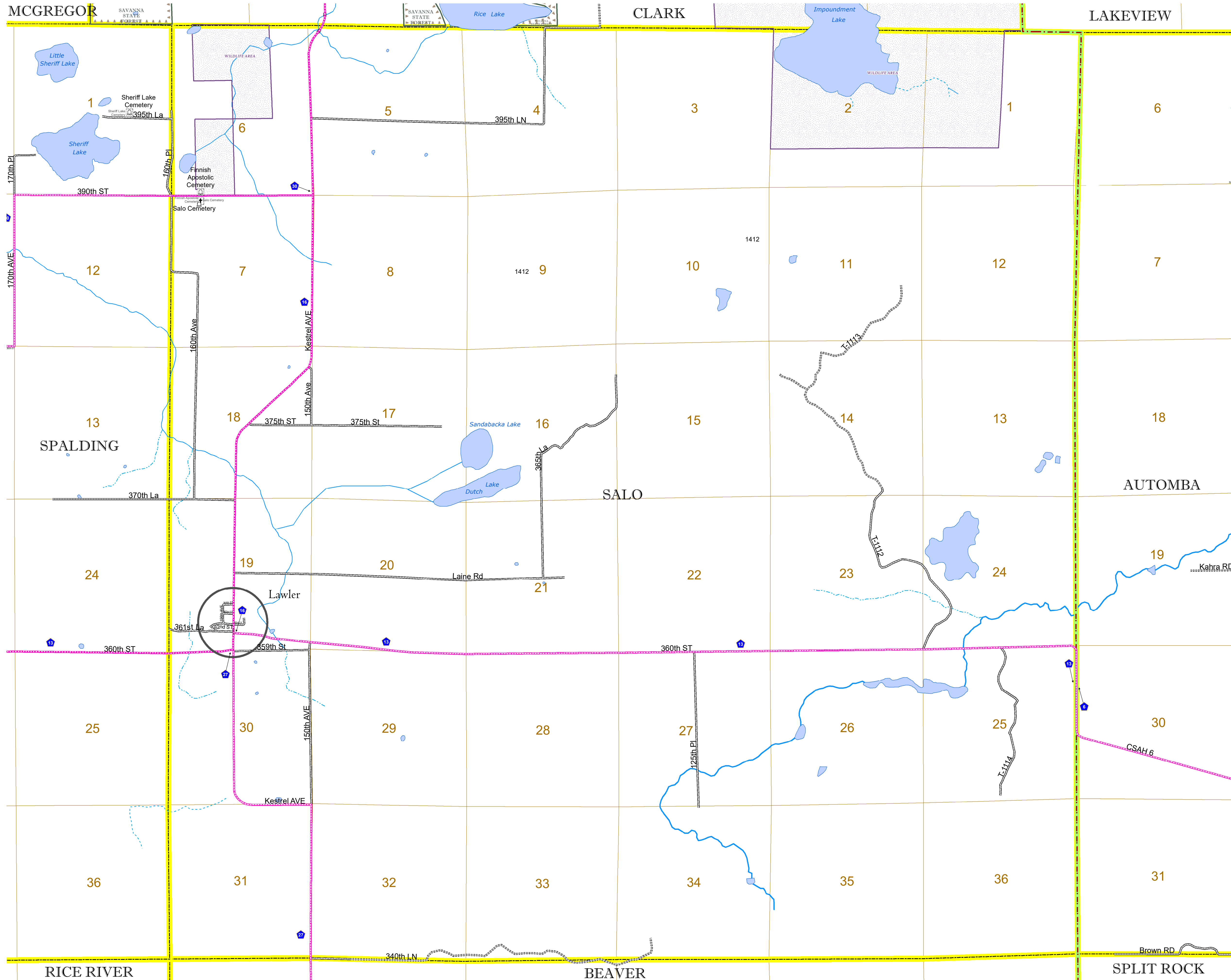

ROAD AND ROADWAY FEATURES	AVIATION FEATURES
INTERSTATE	COMMERCIAL AIRPORT
US HIGHWAY	GENERAL AIRPORT
MN HIGHWAY	AIRSTRIP
COUNTY STATE AID HIGHWAY	SEAPLANE
COUNTY ROAD	AIRPORT RUNWAY
TOWNSHIP ROAD	
UNORGANIZED TERRITORY ROAD	
OTHER ROADS	
Municipal	
Private	
National Monument	
State Forest	
Nature Service	
National Park	
National Wildlife	
State Game	
National Forest	
State Park	
Preserve	
RAILROAD AND RAILWAY FEATURES	BOUNDARY FEATURES
EMPIRE BUILDER STATION (AMTRAK)	TRIBAL LAND
NORTHSTAR STATION (COMMUTER)	STATE OF MINNESOTA
LIGHT RAIL	COUNTY
BLUE LINE	MUNICIPALITY
GREEN LINE	UNORGANIZED TERRITORY
INFRASTRUCTURE FEATURES	FEDERAL ADJUSTED URBAN AREA (2014)
LONG BRIDGE (200' OR GREATER SPAN)	CIVIL TOWNSHIP
MAJOR BRIDGE (20' TO 200' SPAN)	CONGRESSIONAL TOWNSHIP
MINOR BRIDGE (5' TO 20' SPAN)	SECTION
DAM	MILITARY
LOCK AND DAM	VOYAGEURS NATIONAL PARK
CITY CENTERS	BOUNDARY WATERS CANOE AREA WILDERNESS
STATE CAPITAL	STATE PARK
COUNTY SEAT	REGIONAL PARK
CITY CENTER	NATIONAL FOREST
UNINCORPORATED COMMUNITY	NATIONAL AND STATE FOREST
PUBLIC SERVICE FEATURES	STATE FOREST
MNDOT OFFICE	NATIONAL TRAIL
MNDOT TRUCK STATION	WILDLIFE REFUGES AREA
HIGHWAY PATROL DISTRICT OFFICE	WILDLIFE MANAGEMENT AREA
STATE TRAVEL INFORMATION CENTER	HYDROLOGIC FEATURES
REST AREA (FULL SERVICE)	RIVER OR STREAM (PERENNIAL)
REST AREA (VAULT TOILET)	LAKE, POND OR RESERVOIR
WAYSIDE (VAULT OR PIT TOILET)	STREAM (INTERMITTENT)
PARK AND RIDE LOT	DRAINAGE DITCH
PORT OF ENTRY	WETLAND
PUBLIC ACCESS POINT	ISLAND OR LAND
MN STATE COLLEGE AND UNIVERSITY SYSTEM (MNSCU)	REGIONAL WATERSHED
UNIVERSITY OF MN SYSTEM	
FAIRGROUNDS	
CULTURAL FEATURES	
STATE HISTORICAL MARKER	
HISTORIC DISTRICT	
HISTORIC SITE	
MONUMENT	

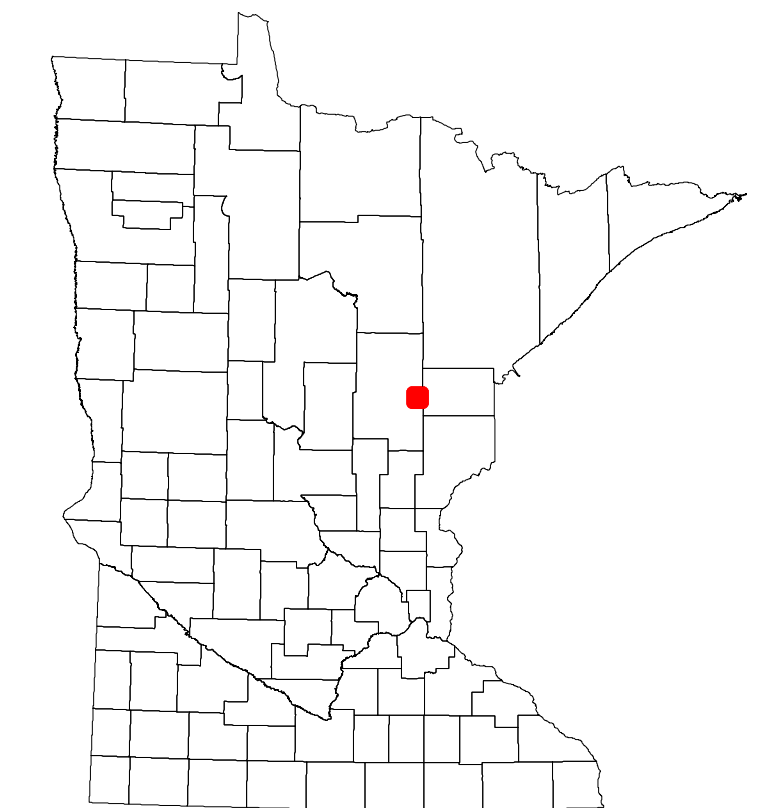

Population (U.S. Census 2010): 102

To request information from this document in an alternative format, call 651-366-4718 or 1-800-657-3774 (Greater Minnesota); 711 or 1-800-627-3529 (Minnesota Relay). You may also send an e-mail to ADARrequest.dot@state.mn.us. (Please request at least one week in advance.)