

# TOWNSHIP OF WEALTHWOOD

PREPARED BY THE  
MINNESOTA DEPARTMENT OF TRANSPORTATION  
OFFICE OF TRANSPORTATION SYSTEM MANAGEMENT

IN COOPERATION WITH  
U.S. DEPARTMENT OF TRANSPORTATION  
FEDERAL HIGHWAY ADMINISTRATION

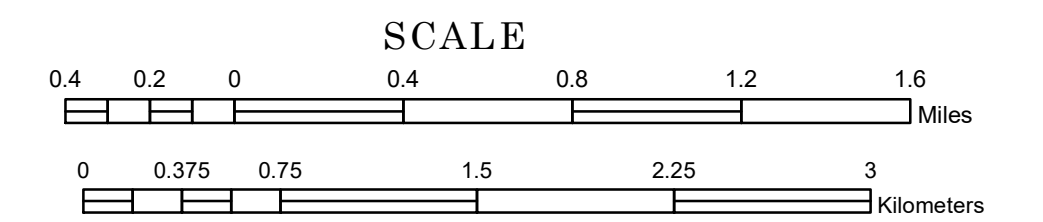

1 in = 2,400 ft

2022

Projection:  
Transverse Mercator  
NAD 1986  
UTM Zone 15

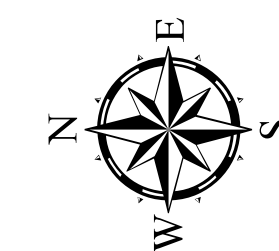

North American Datum  
of 1986

| ROAD AND ROADWAY FEATURES          |                                       | AVIATION FEATURES        |                                       |
|------------------------------------|---------------------------------------|--------------------------|---------------------------------------|
| INTERSTATE                         | CONCRETE                              | COMMERCIAL AIRPORT       | GENERAL AIRPORT                       |
| US HIGHWAY                         | BITUMINOUS                            | AIRSTRIP                 | AIRSTRIP                              |
| MN HIGHWAY                         | GRAVEL                                | SEAPLANE                 | SEAPLANE                              |
| COUNTY STATE AID HIGHWAY           | DIRT/UNIMPROVED                       | AIRPORT RUNWAY           | AIRPORT RUNWAY                        |
| COUNTY ROAD                        | OTHER                                 | BOUNDARY FEATURES        |                                       |
| TOWNSHIP ROAD                      | UNKNOWN                               | TRIBAL LAND              | STATE OF MINNESOTA                    |
| UNORGANIZED TERRITORY ROAD         |                                       | COUNTY                   | MUNICIPALITY                          |
| OTHER ROADS                        |                                       | UNORGANIZED TERRITORY    | FEDERAL ADJUSTED URBAN AREA (2014)    |
| Municipal                          | Private                               | CITY CENTER              | CIVIL TOWNSHIP                        |
| Nature Service                     | National Monument                     | CITY CENTER              | CONGRESSIONAL TOWNSHIP                |
| Military                           | National Wildlife Refuge              | UNINCORPORATED COMMUNITY | SECTION                               |
|                                    | State Game Preserve                   |                          | MILITARY                              |
|                                    | State Park Preserve                   |                          | VOYAGEURS NATIONAL PARK               |
| RAILROAD AND RAILWAY FEATURES      |                                       |                          | BOUNDARY WATERS CANOE AREA WILDERNESS |
| EMPIRE BUILDER STATION (AMTRAK)    | COMMERCIAL AIRPORT                    |                          | STATE PARK                            |
| NORTHSTAR STATION (COMMUTER)       | GENERAL AIRPORT                       |                          | REGIONAL PARK                         |
| LIGHT RAIL                         | AIRSTRIP                              |                          | NATIONAL FOREST                       |
| BLUE LINE                          | SEAPLANE                              |                          | NATIONAL AND STATE FOREST             |
| GREEN LINE                         | AIRPORT RUNWAY                        |                          | STATE FOREST                          |
|                                    |                                       |                          | NATIONAL TRAIL                        |
| INFRASTRUCTURE FEATURES            |                                       |                          | WILDLIFE REFUGUE AREA                 |
| LONG BRIDGE (200' OR GREATER SPAN) | TRIBAL LAND                           |                          | WILDLIFE MANAGEMENT AREA              |
| MAJOR BRIDGE (20' TO 200' SPAN)    | STATE OF MINNESOTA                    |                          | HYDROLOGIC FEATURES                   |
| MINOR BRIDGE (5' TO 20' SPAN)      | COUNTY                                |                          | RIVER OR STREAM (PERENNIAL)           |
| DAM                                | MUNICIPALITY                          |                          | LAKE, POND OR RESERVOIR               |
| LOCK AND DAM                       | UNORGANIZED TERRITORY                 |                          | STREAM (INTERMITTENT)                 |
|                                    | FEDERAL ADJUSTED URBAN AREA (2014)    |                          | DRAINAGE DITCH                        |
|                                    | CIVIL TOWNSHIP                        |                          | WETLAND                               |
|                                    | CONGRESSIONAL TOWNSHIP                |                          | ISLAND OR LAND                        |
|                                    | SECTION                               |                          | REGIONAL WATERSHED                    |
|                                    | MILITARY                              |                          |                                       |
|                                    | VOYAGEURS NATIONAL PARK               |                          |                                       |
|                                    | BOUNDARY WATERS CANOE AREA WILDERNESS |                          |                                       |
|                                    | STATE PARK                            |                          |                                       |
|                                    | REGIONAL PARK                         |                          |                                       |
|                                    | NATIONAL FOREST                       |                          |                                       |
|                                    | NATIONAL AND STATE FOREST             |                          |                                       |
|                                    | STATE FOREST                          |                          |                                       |
|                                    | NATIONAL TRAIL                        |                          |                                       |
|                                    | WILDLIFE REFUGUE AREA                 |                          |                                       |
|                                    | WILDLIFE MANAGEMENT AREA              |                          |                                       |
|                                    | HYDROLOGIC FEATURES                   |                          |                                       |
|                                    | RIVER OR STREAM (PERENNIAL)           |                          |                                       |
|                                    | LAKE, POND OR RESERVOIR               |                          |                                       |
|                                    | STREAM (INTERMITTENT)                 |                          |                                       |
|                                    | DRAINAGE DITCH                        |                          |                                       |
|                                    | WETLAND                               |                          |                                       |
|                                    | ISLAND OR LAND                        |                          |                                       |
|                                    | REGIONAL WATERSHED                    |                          |                                       |

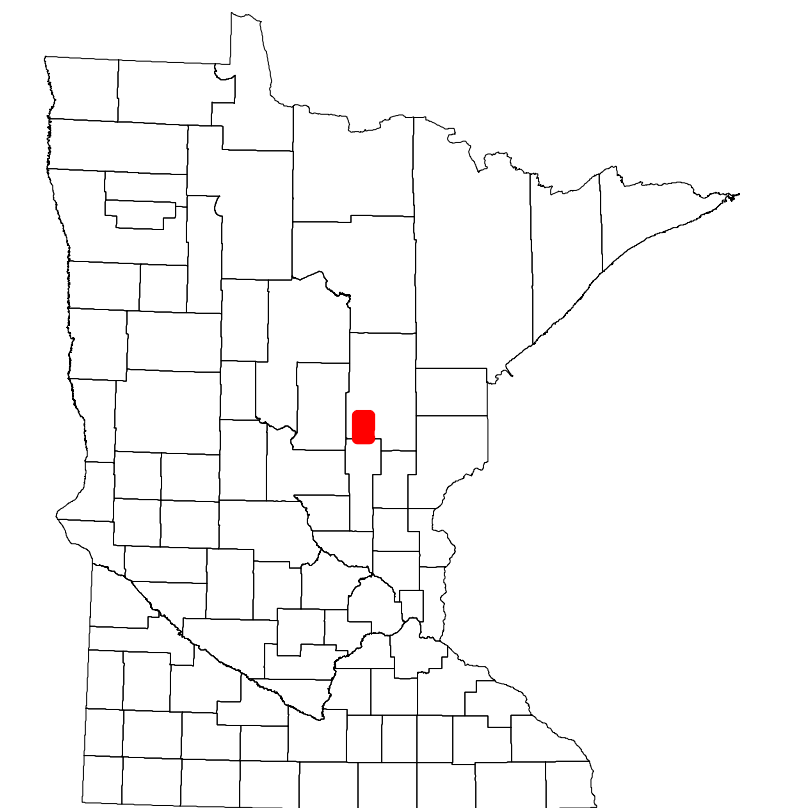

Population (U.S. Census 2010): 268

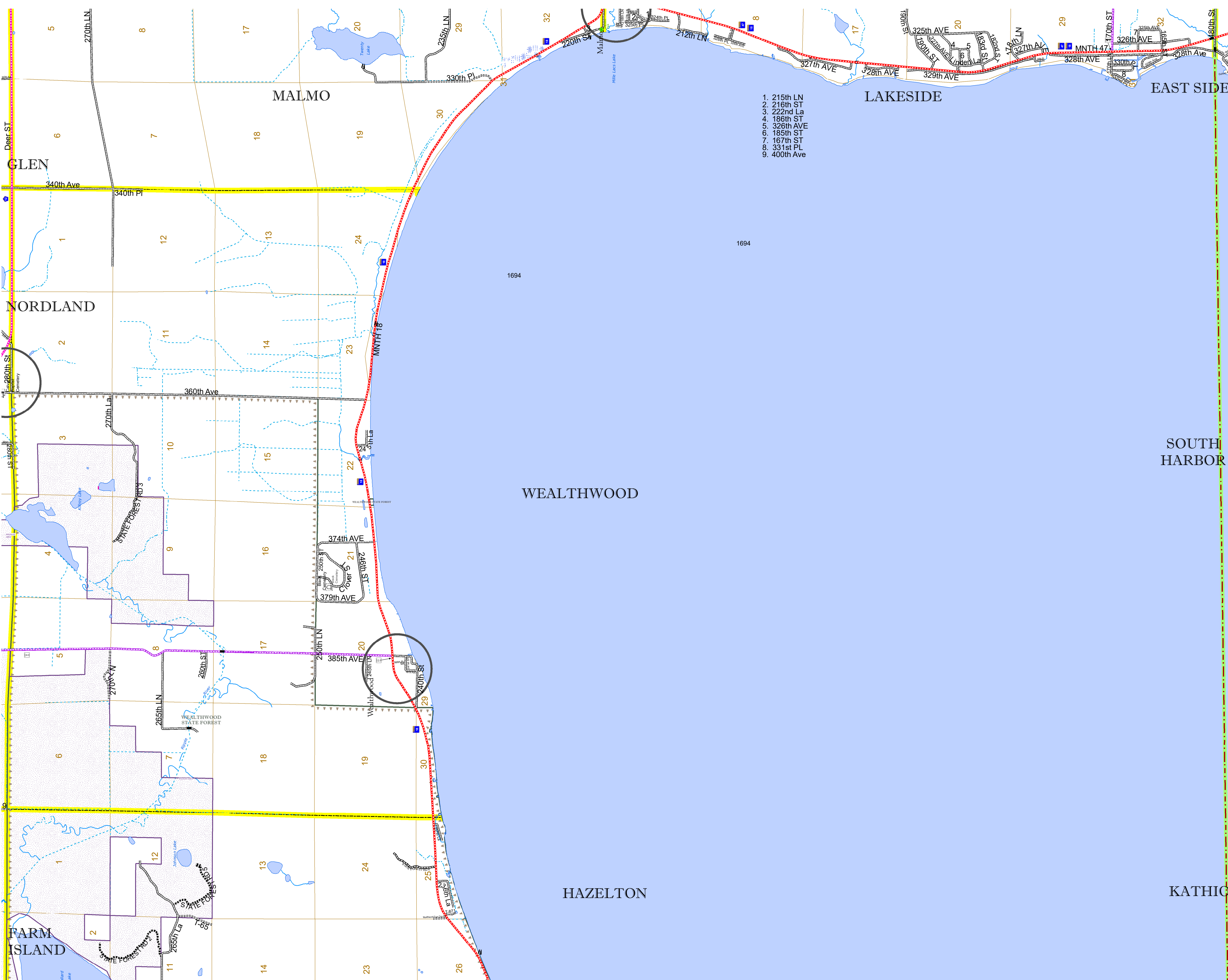

- 215th LN
- 216th ST
- 222nd La
- 186th ST
- 326th AVE
- 185th ST
- 167th ST
- 331st PL
- 400th Ave

To request information from this document in an alternative format, call 651-366-4718 or 1-800-657-3774 (Greater Minnesota); 711 or 1-800-627-3529 (Minnesota Relay). You may also send an e-mail to ADRequest.dot@state.mn.us. (Please request at least one week in advance.)