

TOWNSHIP OF LANGOLA

PREPARED BY THE
MINNESOTA DEPARTMENT OF TRANSPORTATION
OFFICE OF TRANSPORTATION SYSTEM MANAGEMENT

IN COOPERATION WITH
U.S. DEPARTMENT OF TRANSPORTATION
FEDERAL HIGHWAY ADMINISTRATION

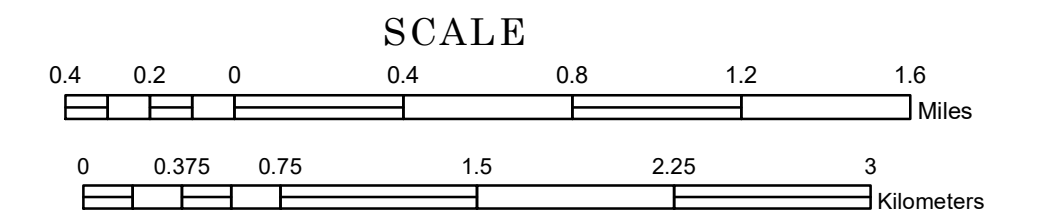

1 in = 2,400 ft

2022

Projection:
Transverse Mercator
NAD 1986
UTM Zone 15



North American Datum
of 1986

| ROAD AND ROADWAY FEATURES | | AVIATION FEATURES | |
|------------------------------------------------|-------------------|--------------------|-----------------|
| INTERSTATE | CONCRETE | COMMERCIAL AIRPORT | GENERAL AIRPORT |
| US HIGHWAY | BITUMINOUS | AIRSTRIP | SEAPLANE |
| MN HIGHWAY | GRAVEL | SEA PLANE | AIRPORT RUNWAY |
| COUNTY STATE AID HIGHWAY | DIRT/UNIMPROVED | OTHER | UNKNOWN |
| COUNTY ROAD | OTHER | UNKNOWN | UNKNOWN |
| TOWNSHIP ROAD | UNKNOWN | UNKNOWN | UNKNOWN |
| UNORGANIZED TERRITORY ROAD | UNKNOWN | UNKNOWN | UNKNOWN |
| OTHER ROADS | RAMP OR CONNECTOR | UNKNOWN | UNKNOWN |
| Municipal | INTERSTATE EXIT | UNKNOWN | UNKNOWN |
| Private | GREAT RIVER ROAD | UNKNOWN | UNKNOWN |
| National Monument | UNKNOWN | UNKNOWN | UNKNOWN |
| State Forest | UNKNOWN | UNKNOWN | UNKNOWN |
| Nature Service | UNKNOWN | UNKNOWN | UNKNOWN |
| Mulden | UNKNOWN | UNKNOWN | UNKNOWN |
| National Forest | UNKNOWN | UNKNOWN | UNKNOWN |
| State Park | UNKNOWN | UNKNOWN | UNKNOWN |
| Preserve | UNKNOWN | UNKNOWN | UNKNOWN |
| RAILROAD AND RAILWAY FEATURES | UNKNOWN | UNKNOWN | UNKNOWN |
| EMPIRE BUILDER STATION (AMTRAK) | UNKNOWN | UNKNOWN | UNKNOWN |
| NORTHSTAR STATION (COMPUTER) | UNKNOWN | UNKNOWN | UNKNOWN |
| LIGHT RAIL | UNKNOWN | UNKNOWN | UNKNOWN |
| BLUE LINE | UNKNOWN | UNKNOWN | UNKNOWN |
| GREEN LINE | UNKNOWN | UNKNOWN | UNKNOWN |
| LONG BRIDGE (200' OR GREATER SPAN) | UNKNOWN | UNKNOWN | UNKNOWN |
| MAJOR BRIDGE (20' TO 200' SPAN) | UNKNOWN | UNKNOWN | UNKNOWN |
| MINOR BRIDGE (5' TO 20' SPAN) | UNKNOWN | UNKNOWN | UNKNOWN |
| DAM | UNKNOWN | UNKNOWN | UNKNOWN |
| LOCK AND DAM | UNKNOWN | UNKNOWN | UNKNOWN |
| CITY CENTERS | UNKNOWN | UNKNOWN | UNKNOWN |
| STATE CAPITAL | UNKNOWN | UNKNOWN | UNKNOWN |
| COUNTY SEAT | UNKNOWN | UNKNOWN | UNKNOWN |
| CITY CENTER | UNKNOWN | UNKNOWN | UNKNOWN |
| UNINCORPORATED COMMUNITY | UNKNOWN | UNKNOWN | UNKNOWN |
| PUBLIC SERVICE FEATURES | UNKNOWN | UNKNOWN | UNKNOWN |
| MNDOT OFFICE | UNKNOWN | UNKNOWN | UNKNOWN |
| MNDOT TRUCK STATION | UNKNOWN | UNKNOWN | UNKNOWN |
| HIGHWAY PATROL DISTRICT OFFICE | UNKNOWN | UNKNOWN | UNKNOWN |
| STATE TRAVEL INFORMATION CENTER | UNKNOWN | UNKNOWN | UNKNOWN |
| REST AREA (FULL SERVICE) | UNKNOWN | UNKNOWN | UNKNOWN |
| REST AREA (VAULT TOILET) | UNKNOWN | UNKNOWN | UNKNOWN |
| WAYSIDE (VAULT OR PITY TOILET) | UNKNOWN | UNKNOWN | UNKNOWN |
| PARK AND RIDE LOT | UNKNOWN | UNKNOWN | UNKNOWN |
| PORT OF ENTRY | UNKNOWN | UNKNOWN | UNKNOWN |
| PUBLIC ACCESS POINT | UNKNOWN | UNKNOWN | UNKNOWN |
| MN STATE COLLEGE AND UNIVERSITY SYSTEM (MNSCU) | UNKNOWN | UNKNOWN | UNKNOWN |
| UNIVERSITY OF MN SYSTEM | UNKNOWN | UNKNOWN | UNKNOWN |
| FARMS | UNKNOWN | UNKNOWN | UNKNOWN |
| CULTURAL FEATURES | UNKNOWN | UNKNOWN | UNKNOWN |
| STATE HISTORICAL MARKER | UNKNOWN | UNKNOWN | UNKNOWN |
| HISTORIC DISTRICT | UNKNOWN | UNKNOWN | UNKNOWN |
| HISTORIC SITE | UNKNOWN | UNKNOWN | UNKNOWN |
| MONUMENT | UNKNOWN | UNKNOWN | UNKNOWN |
| BOUNDARY FEATURES | UNKNOWN | UNKNOWN | UNKNOWN |
| TRIBAL LAND | UNKNOWN | UNKNOWN | UNKNOWN |
| STATE OF MINNESOTA | UNKNOWN | UNKNOWN | UNKNOWN |
| COUNTY | UNKNOWN | UNKNOWN | UNKNOWN |
| MUNICIPALITY | UNKNOWN | UNKNOWN | UNKNOWN |
| UNORGANIZED TERRITORY | UNKNOWN | UNKNOWN | UNKNOWN |
| FEDERAL ADJUSTED URBAN AREA (2014) | UNKNOWN | UNKNOWN | UNKNOWN |
| CIVIL TOWNSHIP | UNKNOWN | UNKNOWN | UNKNOWN |
| CONGRESSIONAL TOWNSHIP | UNKNOWN | UNKNOWN | UNKNOWN |
| SECTION | UNKNOWN | UNKNOWN | UNKNOWN |
| MILITARY | UNKNOWN | UNKNOWN | UNKNOWN |
| VOYAGEURS NATIONAL PARK | UNKNOWN | UNKNOWN | UNKNOWN |
| BOUNDARY WATERS CANOE AREA WILDERNESS | UNKNOWN | UNKNOWN | UNKNOWN |
| STATE PARK | UNKNOWN | UNKNOWN | UNKNOWN |
| REGIONAL PARK | UNKNOWN | UNKNOWN | UNKNOWN |
| NATIONAL FOREST | UNKNOWN | UNKNOWN | UNKNOWN |
| NATIONAL AND STATE FOREST | UNKNOWN | UNKNOWN | UNKNOWN |
| STATE FOREST | UNKNOWN | UNKNOWN | UNKNOWN |
| WILDLIFE REFUGUE AREA | UNKNOWN | UNKNOWN | UNKNOWN |
| WILDLIFE MANAGEMENT AREA | UNKNOWN | UNKNOWN | UNKNOWN |
| HYDROLOGIC FEATURES | UNKNOWN | UNKNOWN | UNKNOWN |
| RIVER OR STREAM (PERMANENT) | UNKNOWN | UNKNOWN | UNKNOWN |
| LAKE, POND OR RESERVOIR | UNKNOWN | UNKNOWN | UNKNOWN |
| STREAM (INTERMITTENT) | UNKNOWN | UNKNOWN | UNKNOWN |
| DRAINAGE DITCH | UNKNOWN | UNKNOWN | UNKNOWN |
| WETLAND | UNKNOWN | UNKNOWN | UNKNOWN |
| ISLAND OR LAND | UNKNOWN | UNKNOWN | UNKNOWN |
| REGIONAL WATERSHED | UNKNOWN | UNKNOWN | UNKNOWN |

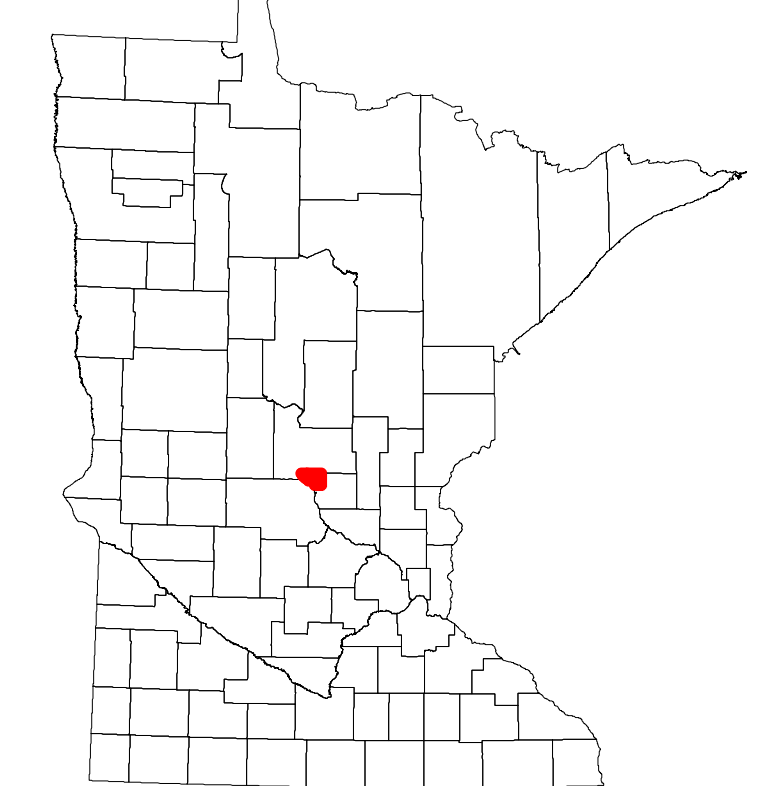

Population (U.S. Census 2010): 906

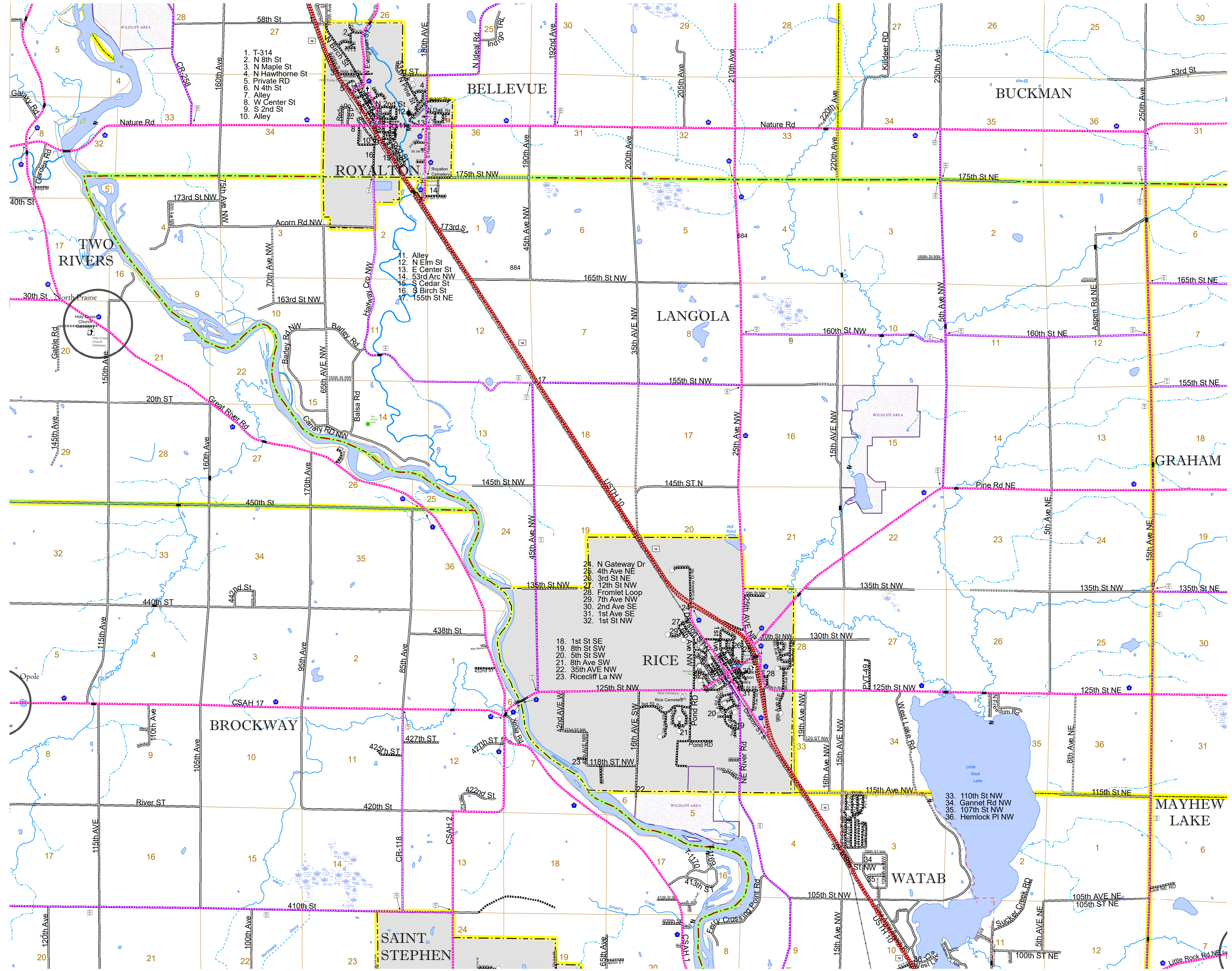

To request information from this document in an alternative format, call 651-366-4718 or 1-800-657-3774 (Greater Minnesota); 711 or 1-800-627-3529 (Minnesota Relay). You may also send an e-mail to ADRequest.dot@state.mn.us. (Please request at least one week in advance.)