

TOWNSHIP OF CAMBRIA

PREPARED BY THE
MINNESOTA DEPARTMENT OF TRANSPORTATION
OFFICE OF TRANSPORTATION SYSTEM MANAGEMENT

IN COOPERATION WITH
U.S. DEPARTMENT OF TRANSPORTATION
FEDERAL HIGHWAY ADMINISTRATION

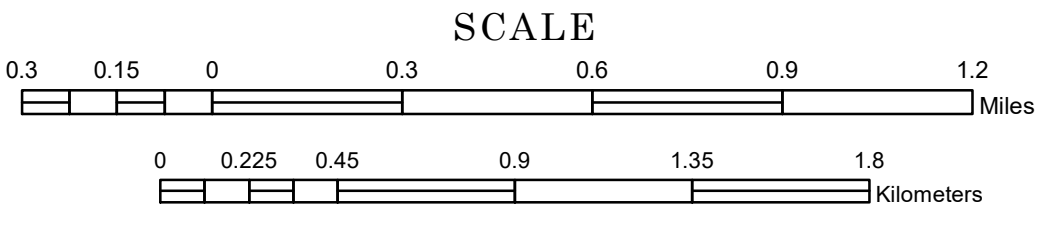

1 in = 1,600 ft
2023

Projection:
Transverse Mercator
NAD 1986
UTM Zone 15

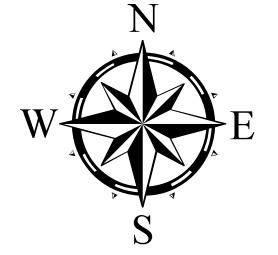

North American Datum
of 1986

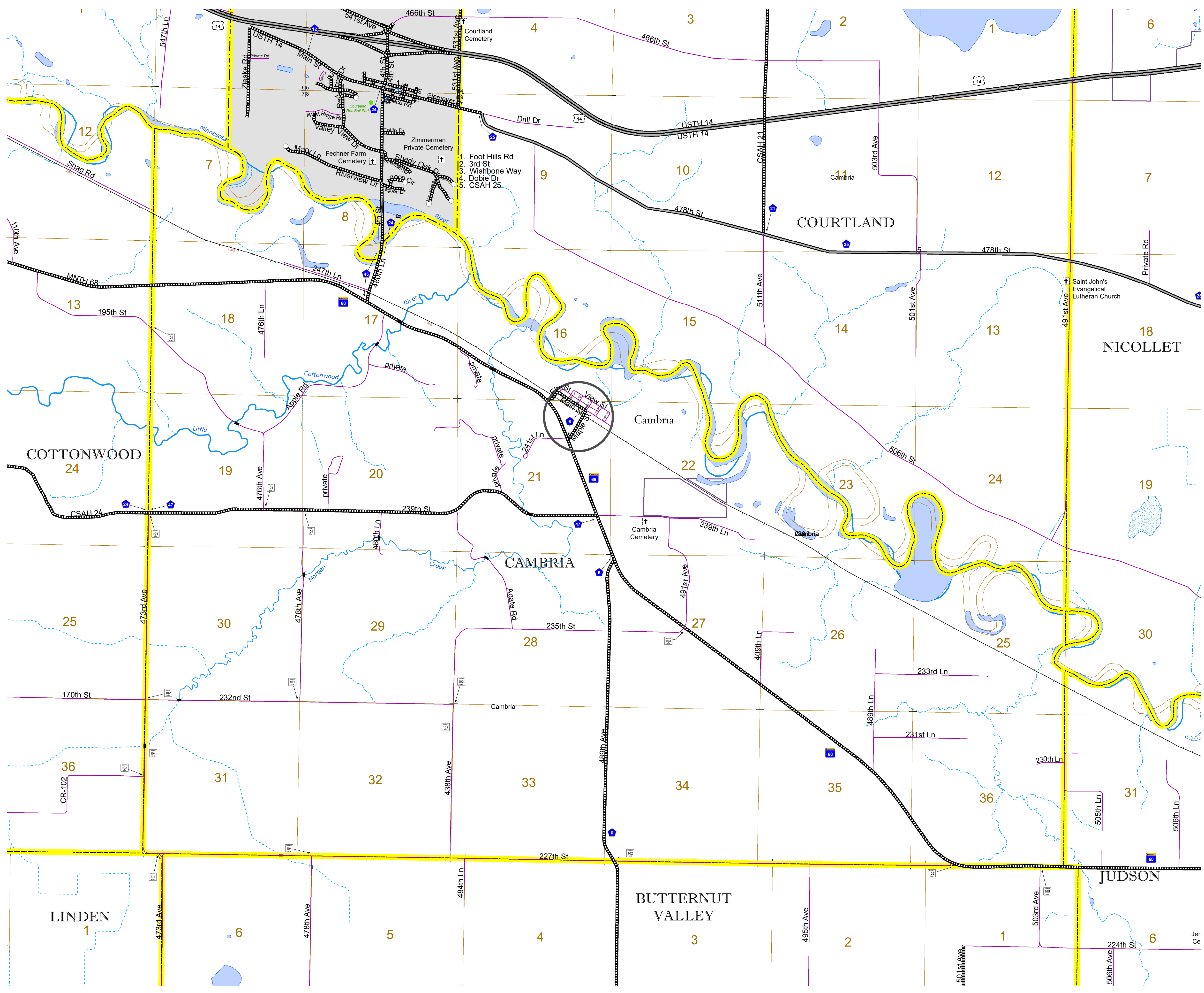

ROAD AND ROADWAY FEATURES		BOUNDARY FEATURES	
INTERSTATE	CONCRETE	TRIBAL LAND	SECTION
US HIGHWAY	BITUMINOUS	STATE OF MINNESOTA	MILITARY
MN HIGHWAY	GRAVEL	COUNTY	VOYAGEURS NATIONAL PARK
COUNTY STATE AID HIGHWAY	DIRT/UNIMPROVED	MUNICIPALITY	BOUNDARY WATERS CANOE AREA WILDERNESS
COUNTY ROAD	OTHER	UNORGANIZED TERRITORY	STATE PARK
TOWNSHIP ROAD	UNKNOWN	FEDERAL ADJUSTED URBAN AREA (2014)	REGIONAL PARK
UNORGANIZED TERRITORY ROAD		CIVIL TOWNSHIP	NATIONAL FOREST
OTHER ROADS:		CONGRESSIONAL TOWNSHIP	NATIONAL AND STATE FOREST
Municipal	RAMP OR CONNECTOR		STATE FOREST
Private	INTERSTATE EXIT		NATIONAL TRAIL
National Monument	GREAT RIVER ROAD		WILDLIFE REFUGE AREA
Nature Service			WILDLIFE MANAGEMENT AREA
National Wildlife Refuge			HYDROLOGIC FEATURES
State Game Preserve			RIVER OR STREAM (PERMANENT)
			LAKE, POND OR RESERVOIR
			STREAM (INTERMITTENT)
			DRAINAGE DITCH
			WETLAND
			ISLAND OR LAND
			REGIONAL WATERSHED

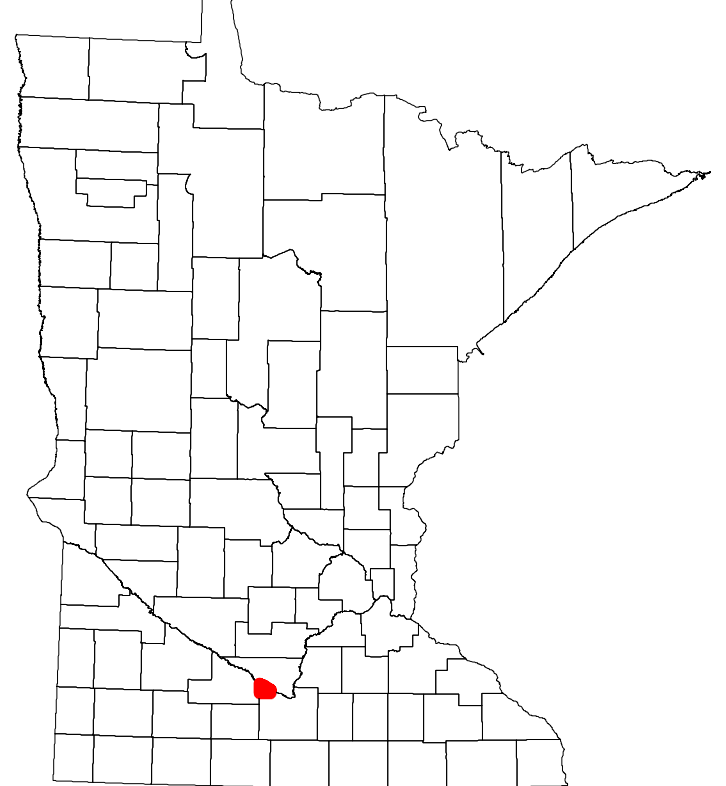

Population (U.S. Census 2010): 260

To request information from this document in an alternative format, call 651-366-4718 or 1-800-657-3774 (Greater Minnesota); 711 or 1-800-627-3529 (Minnesota Relay). You may also send an e-mail to ADRequest.dot@state.mn.us. (Please request at least one week in advance.)