

TOWNSHIP OF LONE TREE

PREPARED BY THE
MINNESOTA DEPARTMENT OF TRANSPORTATION
OFFICE OF TRANSPORTATION SYSTEM MANAGEMENT

IN COOPERATION WITH
U.S. DEPARTMENT OF TRANSPORTATION
FEDERAL HIGHWAY ADMINISTRATION



1 in = 1,600 ft

2022

Projection:
Transverse Mercator
NAD 1986
UTM Zone 15

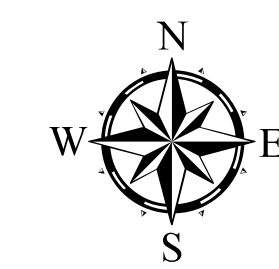

North American Datum
of 1986

ROAD AND ROADWAY FEATURES		BOUNDARY FEATURES	
INTERSTATE	CONCRETE	TRIBAL LAND	STATE OF MINNESOTA
US HIGHWAY	BITUMINOUS	COUNTY	MUNICIPALITY
MN HIGHWAY	GRAVEL	UNORGANIZED TERRITORY	FEDERAL ADJUSTED URBAN AREA (2014)
COUNTY STATE AID HIGHWAY	DIRT/UNIMPROVED	CIVIL TOWNSHIP	CONGRESSIONAL TOWNSHIP
COUNTY ROAD	OTHER	SECTION	MILITARY
TOWNSHIP ROAD	UNKNOWN	VOYAGEURS NATIONAL PARK	BOUNDARY WATERS CANOE AREA WILDERNESS
UNORGANIZED TERRITORY ROAD		STATE PARK	REGIONAL PARK
OTHER ROADS		NATIONAL FOREST	NATIONAL AND STATE FOREST
Municipal		STATE FOREST	NATIONAL TRAIL
Private		WILDLIFE REFUGE AREA	WILDLIFE MANAGEMENT AREA
National Monument		WILDLIFE REFUGE AREA	HYDROLOGIC FEATURES
National Wildlife Refuge		RIVER OR STREAM (PERMANENT)	LAKE, POND OR RESERVOIR
State Game Preserve		STREAM (INTERMITTENT)	DRAINAGE DITCH
RAILROAD AND RAILWAY FEATURES		WETLAND	ISLAND OR LAND
EMPIRE BUILDER STATION (AMTRAK)		REGIONAL WATERSHED	
NORTHSTAR STATION (COMPUTER)			
LIGHT RAIL			
BLUE LINE			
GREEN LINE			
INFRASTRUCTURE FEATURES			
LONG BRIDGE (200' OR GREATER SPAN)			
MAJOR BRIDGE (20' TO 200' SPAN)			
MINOR BRIDGE (5' TO 20' SPAN)			
DAM			
LOCK-AND-DAM			
CITY CENTERS			
STATE CAPITAL			
COUNTY SEAT			
CITY CENTER			
UNINCORPORATED COMMUNITY			
PUBLIC SERVICE FEATURES			
MNDOT OFFICE			
MNDOT TRUCK STATION			
HIGHWAY PATROL DISTRICT OFFICE			
STATE TRAVEL INFORMATION CENTER			
REST AREA (Full Service)			
REST AREA (Vault Toilet)			
WAYSIDE (Vault or Pit Toilet)			
PARK AND RIDE LOT			
PORT OF ENTRY			
PUBLIC ACCESS POINT			
MN STATE COLLEGE AND UNIVERSITY SYSTEM (MNSCU)			
UNIVERSITY OF MN SYSTEM			
FAIRGROUNDS			
CULTURAL FEATURES			
STATE HISTORICAL MARKER			
HISTORIC DISTRICT			
HISTORIC SITE			
MONUMENT			

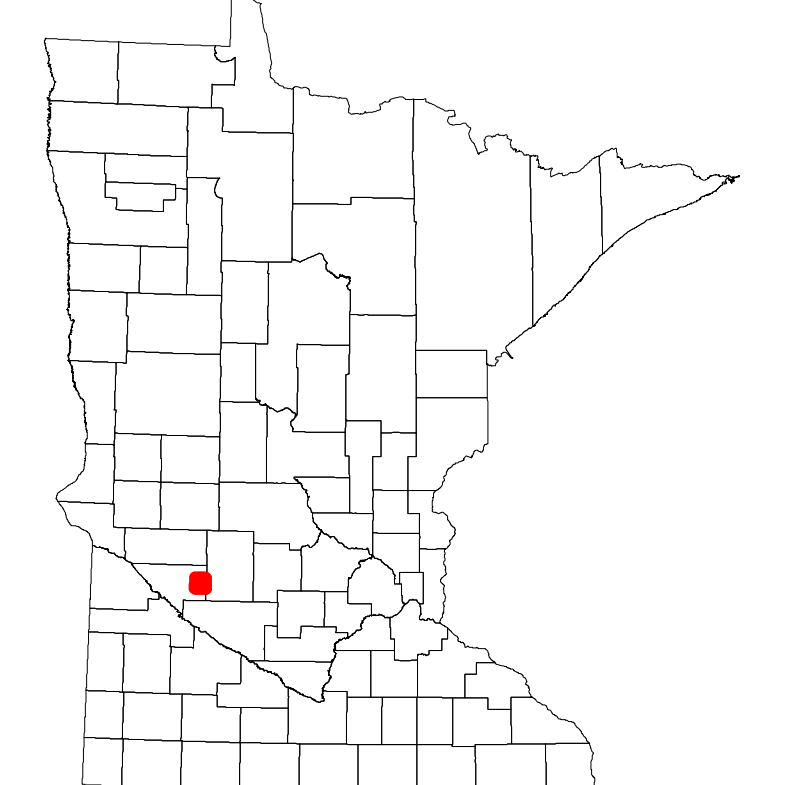

Population (U.S. Census 2010): 199

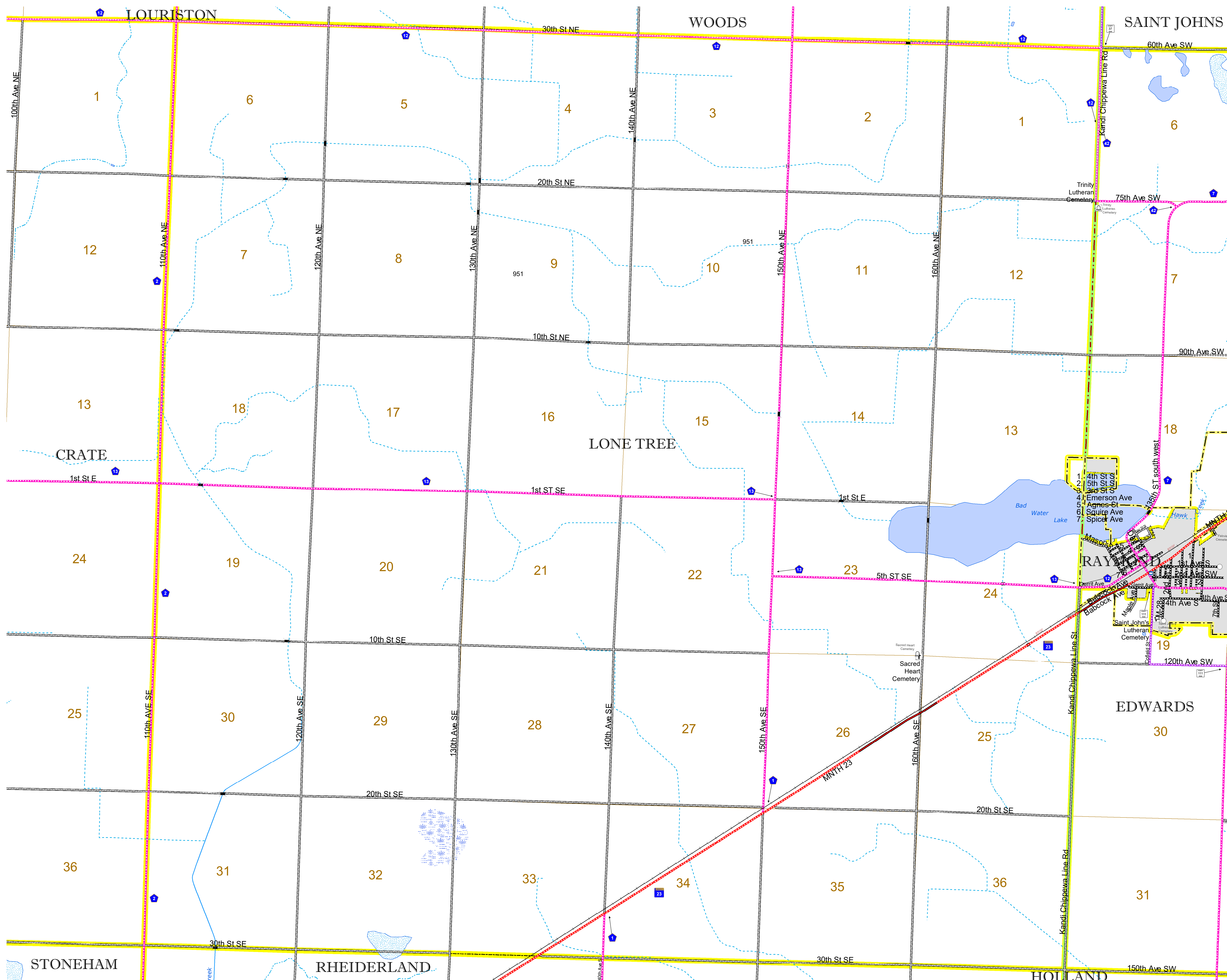

To request information from this document in an alternative format, call 651-366-4718 or 1-800-657-3774 (Greater Minnesota); 711 or 1-800-627-3529 (Minnesota Relay). You may also send an e-mail to ADRequest.dot@state.mn.us. (Please request at least one week in advance.)