

# TOWNSHIP OF MINNESOTA LAKE

PREPARED BY THE  
MINNESOTA DEPARTMENT OF TRANSPORTATION  
OFFICE OF TRANSPORTATION SYSTEM MANAGEMENT

IN COOPERATION WITH  
U.S. DEPARTMENT OF TRANSPORTATION  
FEDERAL HIGHWAY ADMINISTRATION



1 in = 1,600 ft

2022

Projection:  
Transverse Mercator  
NAD 1986  
UTM Zone 15

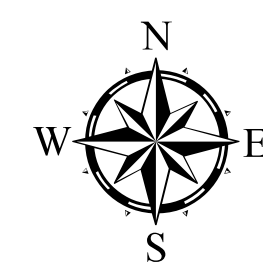

North American Datum  
of 1986

ROAD AND ROADWAY FEATURES		RAILROAD AND RAILWAY FEATURES		AVIATION FEATURES		BOUNDARY FEATURES	
INTERSTATE	CONCRETE	EMPIRE BUILDER STATION (AMTRAK)	COMMERCIAL AIRPORT	TRIBAL LAND	STATE OF MINNESOTA	COUNTY	MUNICIPALITY
US HIGHWAY	BITUMINOUS	NORTHSTAR STATION (COMMUTER)	GENERAL AIRPORT	STATE OF MINNESOTA	COUNTY	MUNICIPALITY	UNINCORPORATED COMMUNITY
MN HIGHWAY	GRAVEL	LIGHT RAIL	AIRSTRIP	STATE OF MINNESOTA	COUNTY	MUNICIPALITY	SECTION
COUNTY STATE AID HIGHWAY	DIRT/UNIMPROVED	BLUE LINE	SEAPLANE	STATE OF MINNESOTA	COUNTY	MUNICIPALITY	MILITARY
COUNTY ROAD	OTHER	GREEN LINE	AIRPORT RUNWAY	STATE OF MINNESOTA	COUNTY	MUNICIPALITY	VOYAGEURS NATIONAL PARK
TOWNSHIP ROAD	UNKNOWN	LONG BRIDGE (200' OR GREATER SPAN)		STATE OF MINNESOTA	COUNTY	MUNICIPALITY	BOUNDARY WATERS CANOE AREA WILDERNESS
UNORGANIZED TERRITORY ROAD		MAJOR BRIDGE (20' TO 200' SPAN)		STATE OF MINNESOTA	COUNTY	MUNICIPALITY	STATE PARK
OTHER ROADS		MINOR BRIDGE (5' TO 20' SPAN)		STATE OF MINNESOTA	COUNTY	MUNICIPALITY	REGIONAL PARK
Municipal		LOCK AND DAM		STATE OF MINNESOTA	COUNTY	MUNICIPALITY	NATIONAL FOREST
Private				STATE OF MINNESOTA	COUNTY	MUNICIPALITY	NATIONAL AND STATE FOREST
National Monument				STATE OF MINNESOTA	COUNTY	MUNICIPALITY	STATE FOREST
National Wildlife Refuge				STATE OF MINNESOTA	COUNTY	MUNICIPALITY	NATIONAL TRAIL
State Game				STATE OF MINNESOTA	COUNTY	MUNICIPALITY	WILDLIFE REFUGUE AREA
State Park				STATE OF MINNESOTA	COUNTY	MUNICIPALITY	WILDLIFE MANAGEMENT AREA
Preserve				STATE OF MINNESOTA	COUNTY <td MUNICIPALITY	HYDROLOGIC FEATURES	
				STATE OF MINNESOTA	COUNTY	MUNICIPALITY	RIVER OR STREAM (PERMANENT)
				STATE OF MINNESOTA	COUNTY	MUNICIPALITY	LAKE, POND OR RESERVOIR
				STATE OF MINNESOTA	COUNTY	MUNICIPALITY	STREAM (INTERMITTENT)
				STATE OF MINNESOTA	COUNTY	MUNICIPALITY	DRAINAGE DITCH
				STATE OF MINNESOTA	COUNTY	MUNICIPALITY	WETLAND
				STATE OF MINNESOTA	COUNTY	MUNICIPALITY	ISLAND OR LAND
				STATE OF MINNESOTA	COUNTY	MUNICIPALITY	REGIONAL WATERSHED

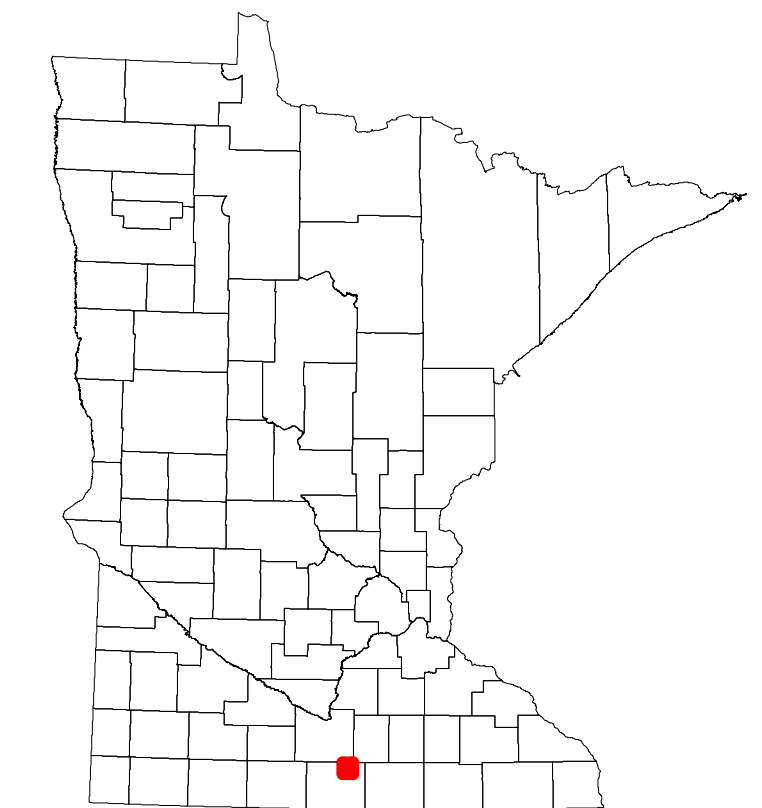

Population (U.S. Census 2010): 190

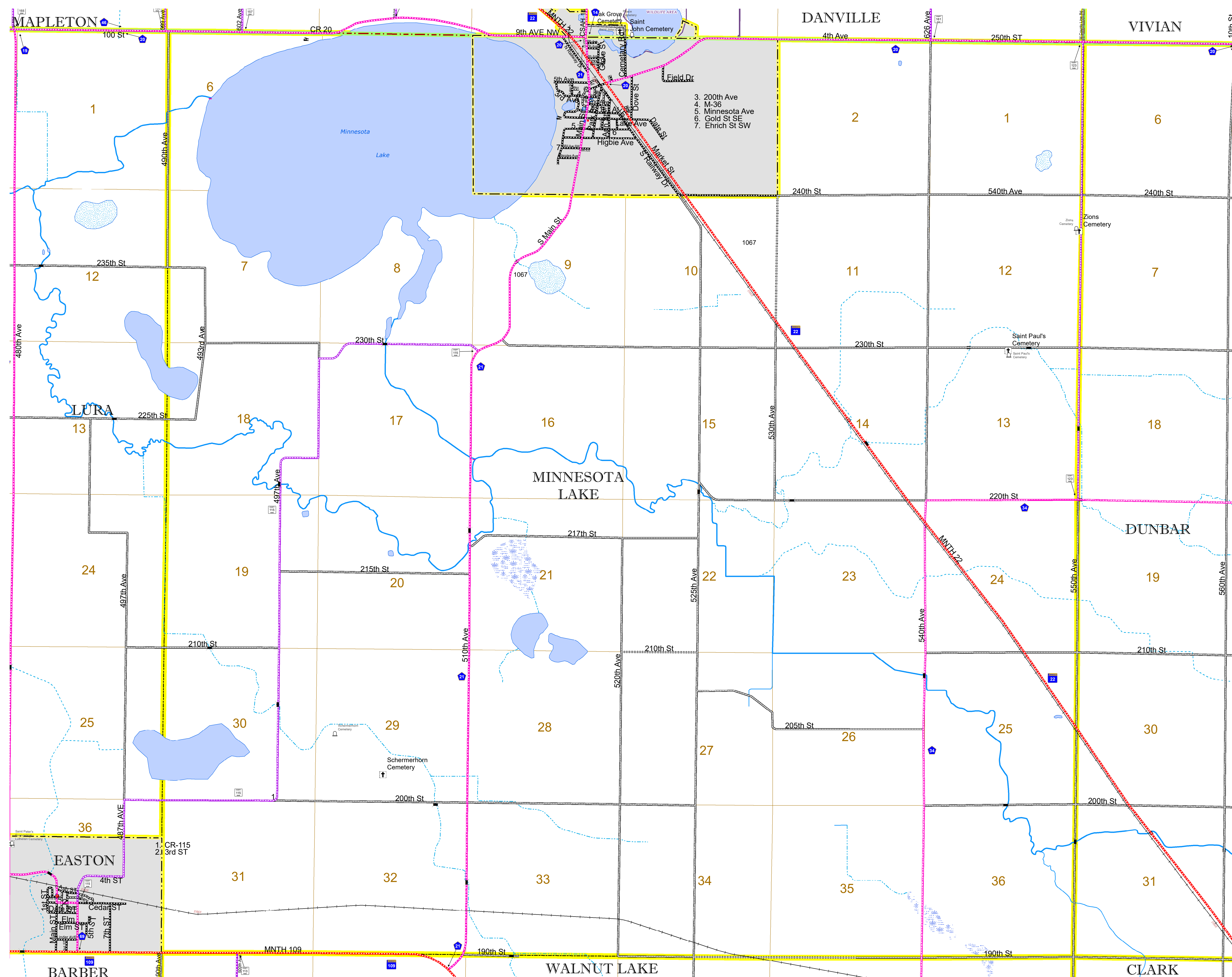

To request information from this document in an alternative format, call 651-366-4718 or 1-800-657-3774 (Greater Minnesota); 711 or 1-800-627-3529 (Minnesota Relay). You may also send an e-mail to ADRequest.dot@state.mn.us. (Please request at least one week in advance.)