

# TOWNSHIP OF CHRISTIANIA

PREPARED BY THE  
MINNESOTA DEPARTMENT OF TRANSPORTATION  
OFFICE OF TRANSPORTATION SYSTEM MANAGEMENT

IN COOPERATION WITH  
U.S. DEPARTMENT OF TRANSPORTATION  
FEDERAL HIGHWAY ADMINISTRATION

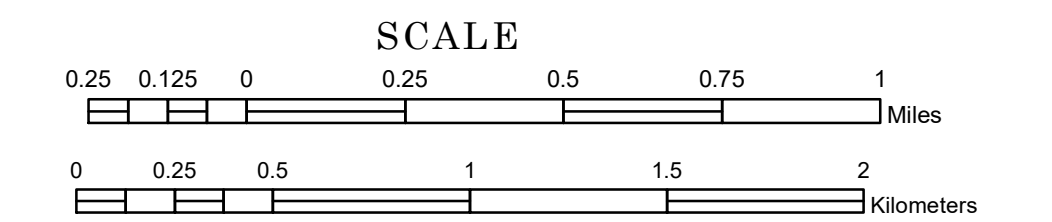

2023

Projection:  
Transverse Mercator  
NAD 1986  
UTM Zone 15



North American Datum  
of 1986

ROAD AND ROADWAY FEATURES		AVIATION FEATURES	
INTERSTATE		CONCRETE	
US HIGHWAY		BITUMINOUS	
MN HIGHWAY		GRAVEL	
COUNTY STATE AID HIGHWAY		DIRT/UNIMPROVED	
COUNTY ROAD		OTHER	
TOWNSHIP ROAD		UNKNOWN	
UNORGANIZED TERRITORY ROAD		RAMP OR CONNECTOR	
OTHER ROADS		INTERSTATE EXIT	
Municipal		GENERAL AIRPORT	
Private		AIRSTRIP	
National Monument		SEAPLANE	
National Park		AIRPORT RUNWAY	
National Wildlife		STATE PARK	
State Park		NATIONAL FOREST	
Preserve		NATIONAL AND STATE FOREST	
RAILROAD AND RAILWAY FEATURES		BOUNDARY FEATURES	
EMPIRE BUILDER STATION (AMTRAK)		TRIBAL LAND	
NORTHSTAR STATION (COMPUTER)		STATE OF MINNESOTA	
LIGHT RAIL		COUNTY	
BLUE LINE		MUNICIPALITY	
GREEN LINE		UNORGANIZED TERRITORY	
INFRASTRUCTURE FEATURES		FEDERAL ADJUSTED URBAN AREA (2014)	
LONG BRIDGE (200' OR GREATER SPAN)		CIVIL TOWNSHIP	
MAJOR BRIDGE (20' TO 200' SPAN)		CONGRESSIONAL TOWNSHIP	
MINOR BRIDGE (5' TO 20' SPAN)		SECTION	
DAM		MILITARY	
LOCK-AND-DAM		VOYAGEURS NATIONAL PARK	
CITY CENTERS		BOUNDARY WATERS CANOE AREA WILDERNESS	
STATE CAPITAL		STATE PARK	
COUNTY SEAT		REGIONAL PARK	
CITY CENTER		NATIONAL FOREST	
UNINCORPORATED COMMUNITY		NATIONAL AND STATE FOREST	
PUBLIC SERVICE FEATURES		STATE FOREST	
MNDOT OFFICE		NATIONAL TRAIL	
MNDOT TRUCK STATION		WILDLIFE REFUGUE AREA	
HIGHWAY PATROL DISTRICT OFFICE		WILDLIFE MANAGEMENT AREA	
STATE TRAVEL INFORMATION CENTER		HYDROLOGIC FEATURES	
REST AREA (Full Service)		RIVER OR STREAM (Perennial)	
REST AREA (Vault Toilets)		LAKE, POND OR RESERVOIR	
WAYSIDE (Vault or Pit Toilets)		STREAM (Intermittent)	
PARK AND RIDE LOT		DRAINAGE DITCH	
PORT OF ENTRY		HISTORIC DISTRICT	
PUBLIC ACCESS POINT		HISTORIC SITE	
MN STATE COLLEGE AND UNIVERSITY SYSTEM (MNSCU)		MONUMENT	
UNIVERSITY OF MN SYSTEM		REGIONAL WATERSHED	
FAIRGROUNDS			
CULTURAL FEATURES			
STATE HISTORICAL MARKER			
HISTORIC DISTRICT			
HISTORIC SITE			
MONUMENT			

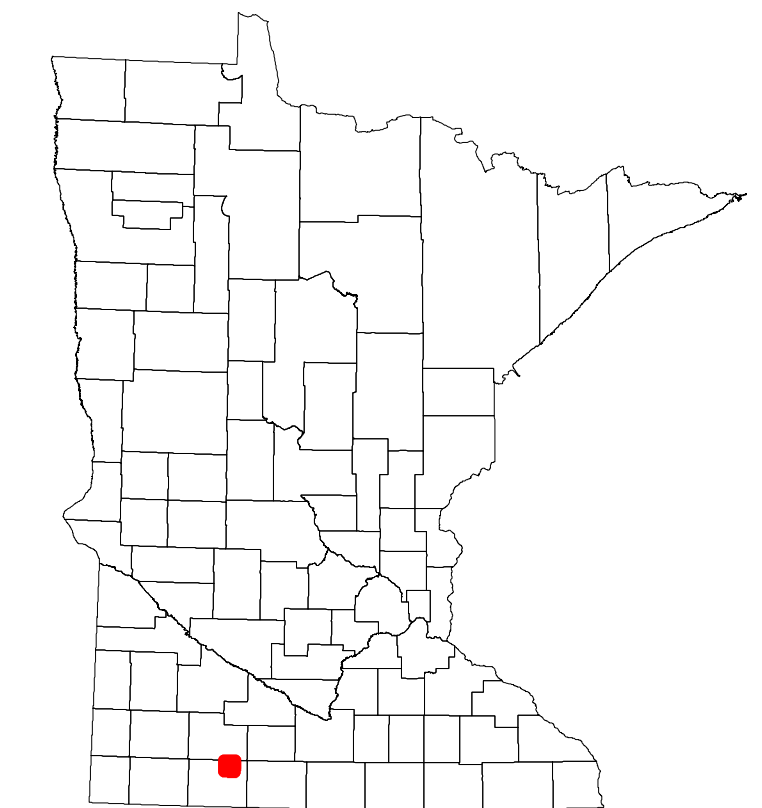

Population (U.S. Census 2010): 249

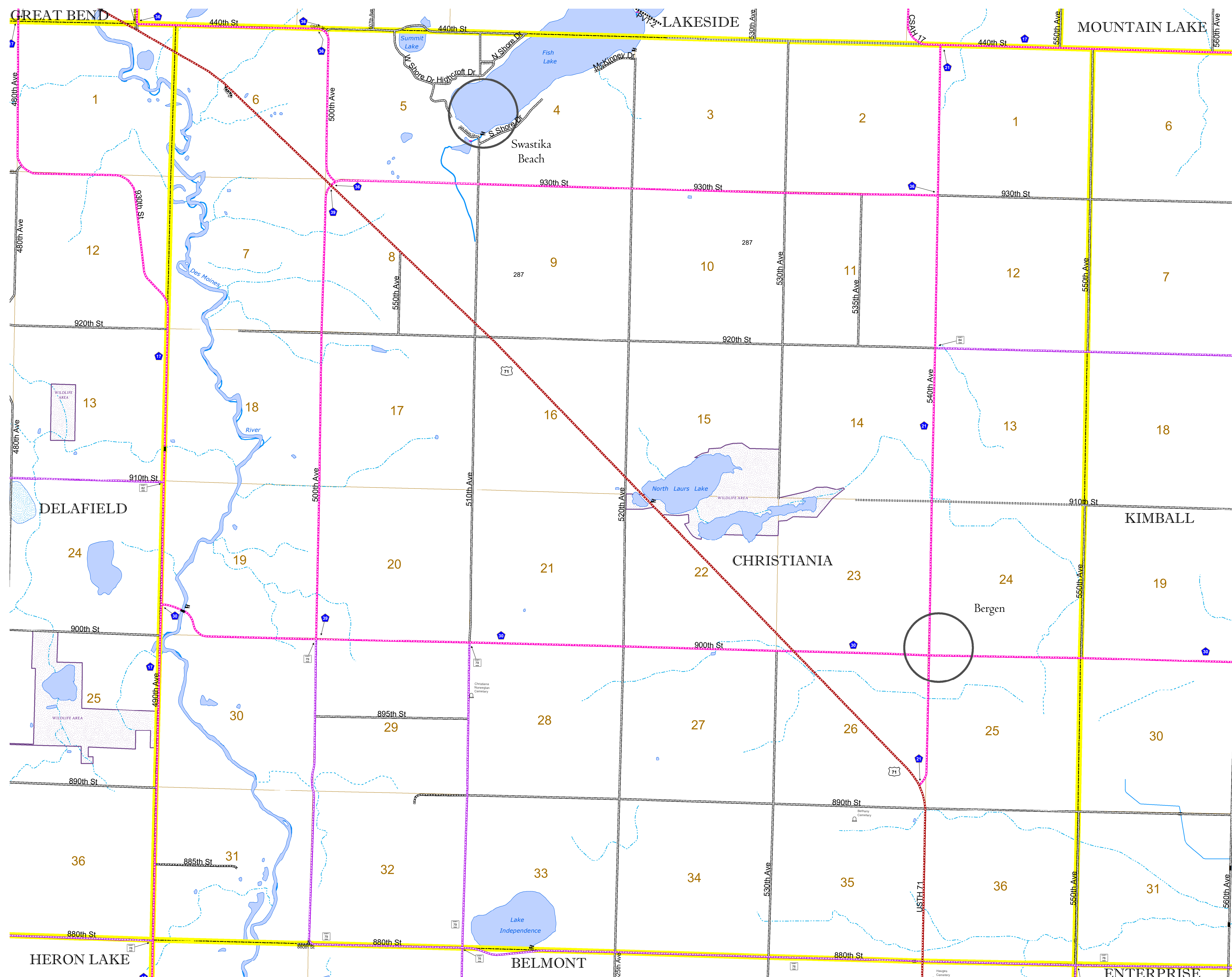

To request information from this document in an alternative format, call 651-366-4718 or 1-800-657-3774 (Greater Minnesota); 711 or 1-800-627-3529 (Minnesota Relay). You may also send an e-mail to ADRequest.dot@state.mn.us. (Please request at least one week in advance.)