

TOWNSHIP OF AUGUSTA

PREPARED BY THE
MINNESOTA DEPARTMENT OF TRANSPORTATION
OFFICE OF TRANSPORTATION SYSTEM MANAGEMENT

IN COOPERATION WITH
U.S. DEPARTMENT OF TRANSPORTATION
FEDERAL HIGHWAY ADMINISTRATION



2022

Projection:
Transverse Mercator
NAD 1986
UTM Zone 15



North American Datum
of 1986

ROAD AND ROADWAY FEATURES		AVIATION FEATURES	
INTERSTATE	CONCRETE	COMMERCIAL AIRPORT	GENERAL AIRPORT
US HIGHWAY	BITUMINOUS	AIRSTRIP	SEAPLANE
MN HIGHWAY	GRAVEL	AIRPORT RUNWAY	
COUNTY STATE AID HIGHWAY	DIRT/UNIMPROVED		
COUNTY ROAD	OTHER		
TOWNSHIP ROAD	UNKNOWN		
UNORGANIZED TERRITORY ROAD			
OTHER ROADS			
Municipal	RAMP OR CONNECTOR		
Private	INTERSTATE EXIT		
National Monument	GREAT RIVER ROAD		
National Park			
National Wildlife			
State Game			
Military			
RAILROAD AND RAILWAY FEATURES		BOUNDARY FEATURES	
EMPIRE BUILDER STATION (AMTRAK)	TRIBAL LAND	STATE OF MINNESOTA	COUNTY
NORTHSTAR STATION (COMMUTER)	STATE OF MINNESOTA	MUNICIPALITY	MUNICIPALITY
LIGHT RAIL	UNINCORPORATED COMMUNITY	UNINCORPORATED TERRITORY	FEDERAL ADJUSTED URBAN AREA (2014)
BLUE LINE		CIVIL TOWNSHIP	CIVIL TOWNSHIP
GREEN LINE		CONGRESSIONAL TOWNSHIP	SECTION
INFRASTRUCTURE FEATURES			MILITARY
LONG BRIDGE (200' OR GREATER SPAN)			VOYAGEURS NATIONAL PARK
MAJOR BRIDGE (20' TO 200' SPAN)			BOUNDARY WATERS CANOE AREA WILDERNESS
MINOR BRIDGE (5' TO 20' SPAN)			STATE PARK
LOCK AND DAM			REGIONAL PARK
			NATIONAL FOREST
			NATIONAL AND STATE FOREST
			STATE FOREST
			NATIONAL TRAIL
			WILDLIFE REFUGUE AREA
			WILDLIFE MANAGEMENT AREA
CITY CENTERS		HYDROLOGIC FEATURES	
STATE CAPITAL	STATE CAPITAL	RIVER OR STREAM (PERMANENT)	LAKE, POND OR RESERVOIR
COUNTY SEAT	COUNTY SEAT	STREAM (INTERMITTENT)	DRAINAGE DITCH
CITY CENTER	CITY CENTER		WETLAND
UNINCORPORATED COMMUNITY	UNINCORPORATED COMMUNITY		ISLAND OR LAND
			REGIONAL WATERSHED
PUBLIC SERVICE FEATURES			
MNDOT OFFICE	MNDOT OFFICE		
MNDOT TRUCK STATION	MNDOT TRUCK STATION		
HIGHWAY PATROL DISTRICT OFFICE	HIGHWAY PATROL DISTRICT OFFICE		
STATE TRAVEL INFORMATION CENTER	STATE TRAVEL INFORMATION CENTER		
REST AREA (Full Service)	REST AREA (Full Service)		
REST AREA (Vault Toilet)	REST AREA (Vault Toilet)		
WAYSIDE (Vault or Pit Toilet)	WAYSIDE (Vault or Pit Toilet)		
PARK AND RIDE LOT	PARK AND RIDE LOT		
PORT OF ENTRY	PORT OF ENTRY		
PUBLIC ACCESS POINT	PUBLIC ACCESS POINT		
MN STATE COLLEGE AND UNIVERSITY SYSTEM (MNSCU)	MN STATE COLLEGE AND UNIVERSITY SYSTEM (MNSCU)		
UNIVERSITY OF MN SYSTEM	UNIVERSITY OF MN SYSTEM		
FAIRGROUNDS	FAIRGROUNDS		
CULTURAL FEATURES			
STATE HISTORICAL MARKER	STATE HISTORICAL MARKER		
HISTORIC DISTRICT	HISTORIC DISTRICT		
HISTORIC SITE	HISTORIC SITE		
MONUMENT	MONUMENT		

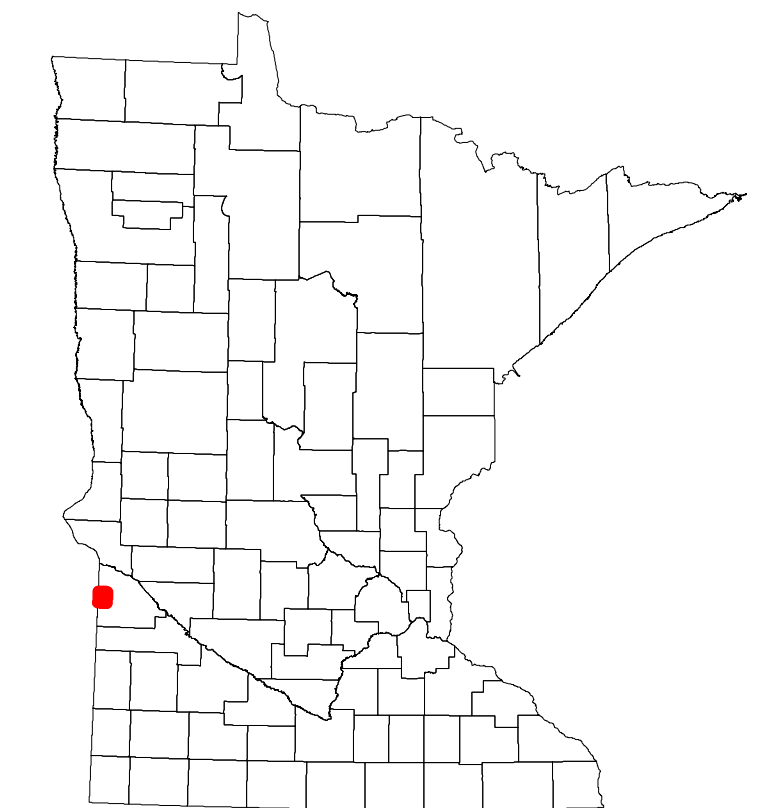

Population (U.S. Census 2010): 110

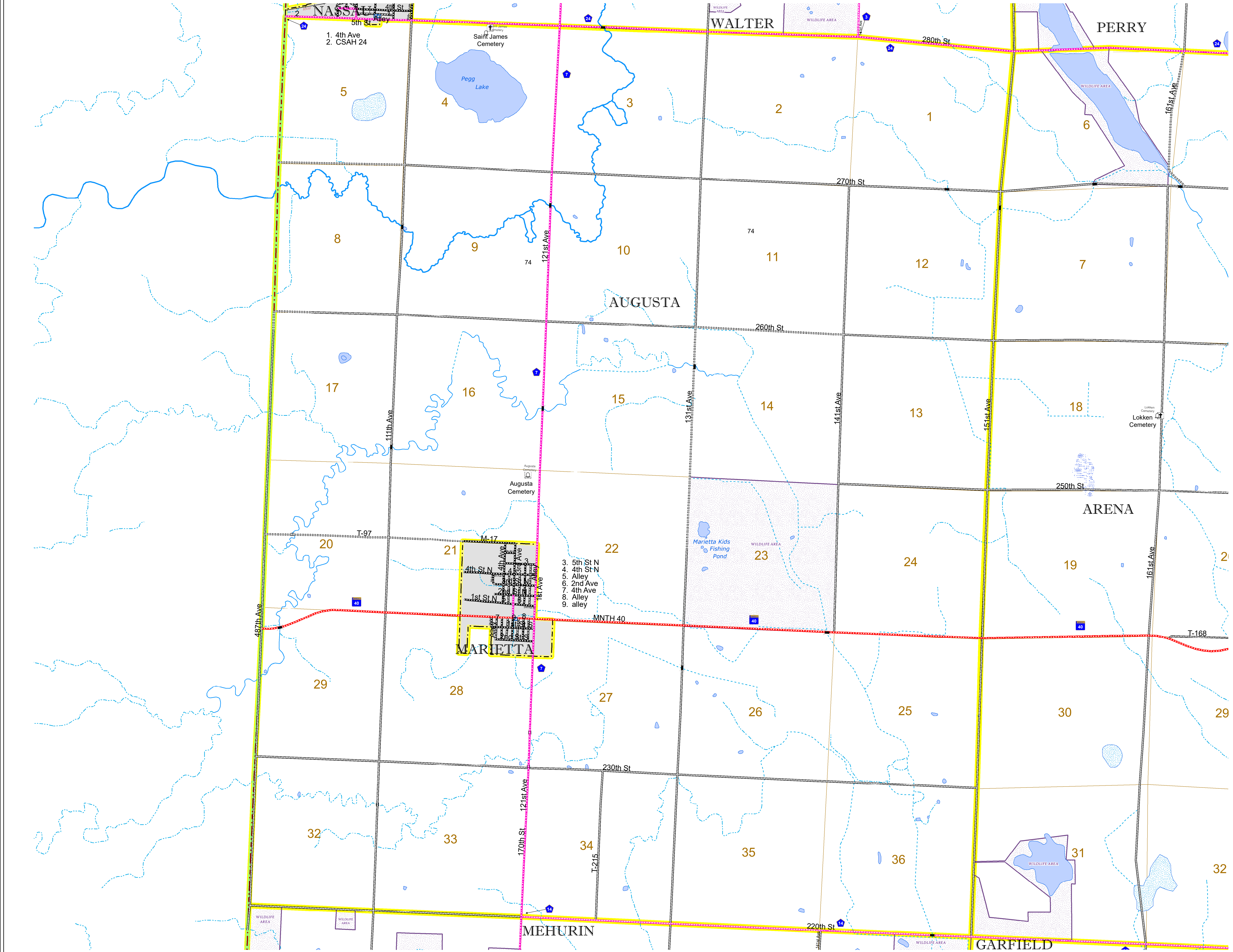

To request information from this document in an alternative format, call 651-366-4718 or 1-800-657-3774 (Greater Minnesota); 711 or 1-800-627-3529 (Minnesota Relay). You may also send an e-mail to ADRequest.dot@state.mn.us. (Please request at least one week in advance.)