

TOWNSHIP OF PRINCETON

PREPARED BY THE
MINNESOTA DEPARTMENT OF TRANSPORTATION
OFFICE OF TRANSPORTATION SYSTEM MANAGEMENT

IN COOPERATION WITH
U.S. DEPARTMENT OF TRANSPORTATION
FEDERAL HIGHWAY ADMINISTRATION



2022

Projection:
Transverse Mercator
NAD 1986
UTM Zone 15



North American Datum
of 1986

ROAD AND ROADWAY FEATURES		BOUNDARY FEATURES	
INTERSTATE	CONCRETE	TRIBAL LAND	STATE OF MINNESOTA
US HIGHWAY	BITUMINOUS	COUNTY	MUNICIPALITY
MN HIGHWAY	GRAVEL	UNINCORPORATED TOWNSHIP	CITY CENTER
COUNTY STATE AID HIGHWAY	DIRT/UNIMPROVED	SECTION	MILITARY
COUNTY ROAD	OTHER	VOYAGEURS NATIONAL PARK	BOUNDARY WATERS CANOE AREA WILDERNESS
TOWNSHIP ROAD	UNKNOWN	STATE PARK	REGIONAL PARK
UNORGANIZED TERRITORY ROAD		NATIONAL FOREST	NATIONAL AND STATE FOREST
OTHER ROADS		STATE FOREST	WILDLIFE REFUGUE AREA
Municipal	RAMP OR CONNECTOR	WILDLIFE MANAGEMENT AREA	HYDROLOGIC FEATURES
Private	INTERSTATE EXIT	RIVER OR STREAM (PERMANENT)	LAKE, POND OR RESERVOIR
National Monument	GREAT RIVER ROAD	STREAM (INTERMITTENT)	DRAINAGE DITCH
State Game	RAILROAD AND RAILWAY FEATURES	WETLAND	ISLAND OR LAND
State Park	RAILROAD	MONUMENT	REGIONAL WATERSHED
Preserve	EMPIRE BUILDER STATION (AMTRAK)		
	NORTHSTAR STATION (COMMUTER)		
	SEAPLANE		
	AIRPORT RUNWAY		
	COMMERCIAL AIRPORT		
	GENERAL AIRPORT		
	AIRSTRIP		
	AVIATION FEATURES		
	LONG BRIDGE (200' OR GREATER SPAN)		
	MAJOR BRIDGE (20' TO 200' SPAN)		
	MINOR BRIDGE (5' TO 20' SPAN)		
	DAM		
	LOCK AND DAM		
	INFRASTRUCTURE FEATURES		
	STATE CAPITAL		
	COUNTY SEAT		
	CITY CENTER		
	UNINCORPORATED COMMUNITY		
	PUBLIC SERVICE FEATURES		
	MNDOT OFFICE		
	MNDOT TRUCK STATION		
	HIGHWAY PATROL DISTRICT OFFICE		
	STATE TRAVEL INFORMATION CENTER		
	REST AREA (FULL SERVICE)		
	REST AREA (VAULT TOILET)		
	WAYSIDE (VAULT OR PITY TOILET)		
	PARK AND RIDE LOT		
	PORT OF ENTRY		
	PUBLIC ACCESS POINT		
	MN STATE COLLEGE AND UNIVERSITY SYSTEM (MNSCU)		
	UNIVERSITY OF MN SYSTEM		
	FAIRGROUNDS		
	CULTURAL FEATURES		
	STATE HISTORICAL MARKER		
	HISTORIC DISTRICT		
	HISTORIC SITE		
	MONUMENT		

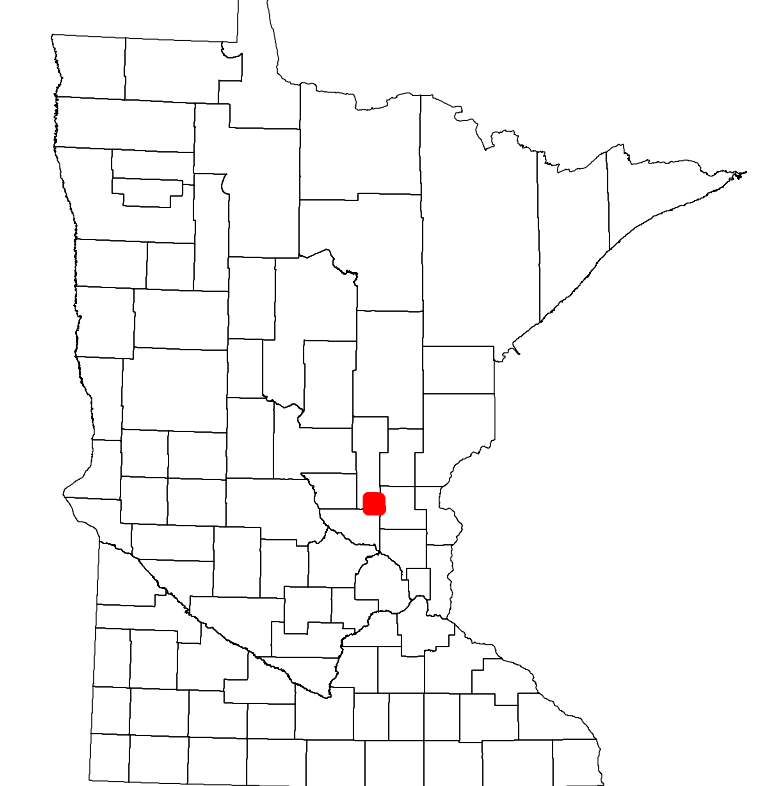

Population (U.S. Census 2010): 2256

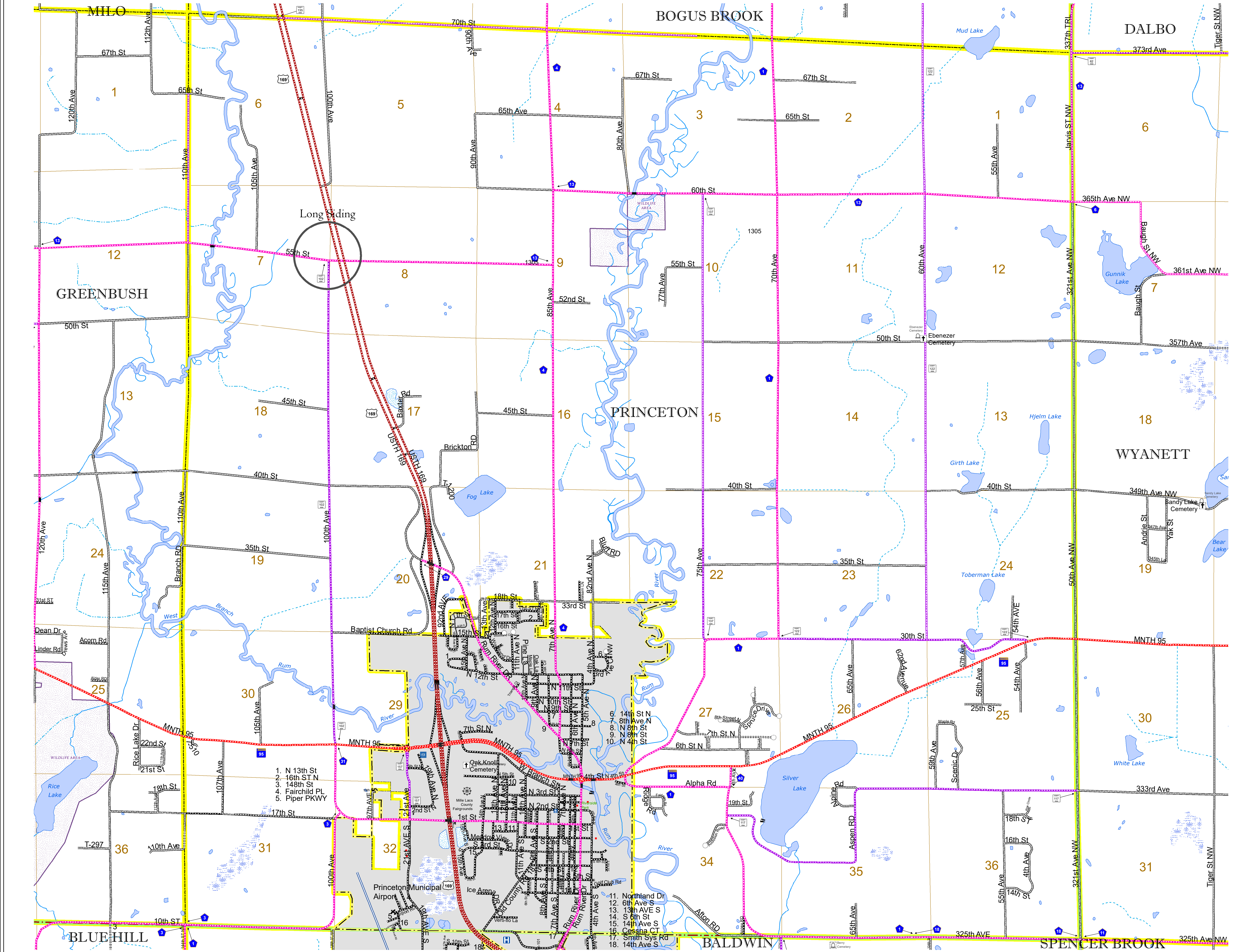

To request information from this document in an alternative format, call 651-366-4718 or 1-800-657-3774 (Greater Minnesota); 711 or 1-800-627-3529 (Minnesota Relay). You may also send an e-mail to ADARquest.dot@state.mn.us. (Please request at least one week in advance.)