

TOWNSHIP OF NEW SWEDEN

PREPARED BY THE
MINNESOTA DEPARTMENT OF TRANSPORTATION
OFFICE OF TRANSPORTATION SYSTEM MANAGEMENT

IN COOPERATION WITH
U.S. DEPARTMENT OF TRANSPORTATION
FEDERAL HIGHWAY ADMINISTRATION

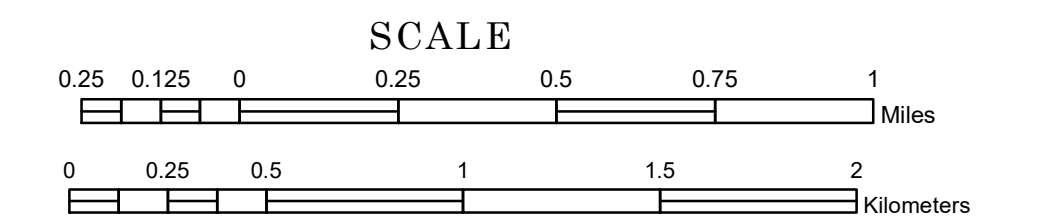

1 in = 1,600 ft

2022

Projection:
Transverse Mercator
NAD 1986
UTM Zone 15

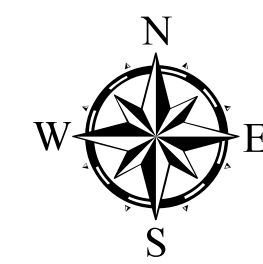

North American Datum
of 1986

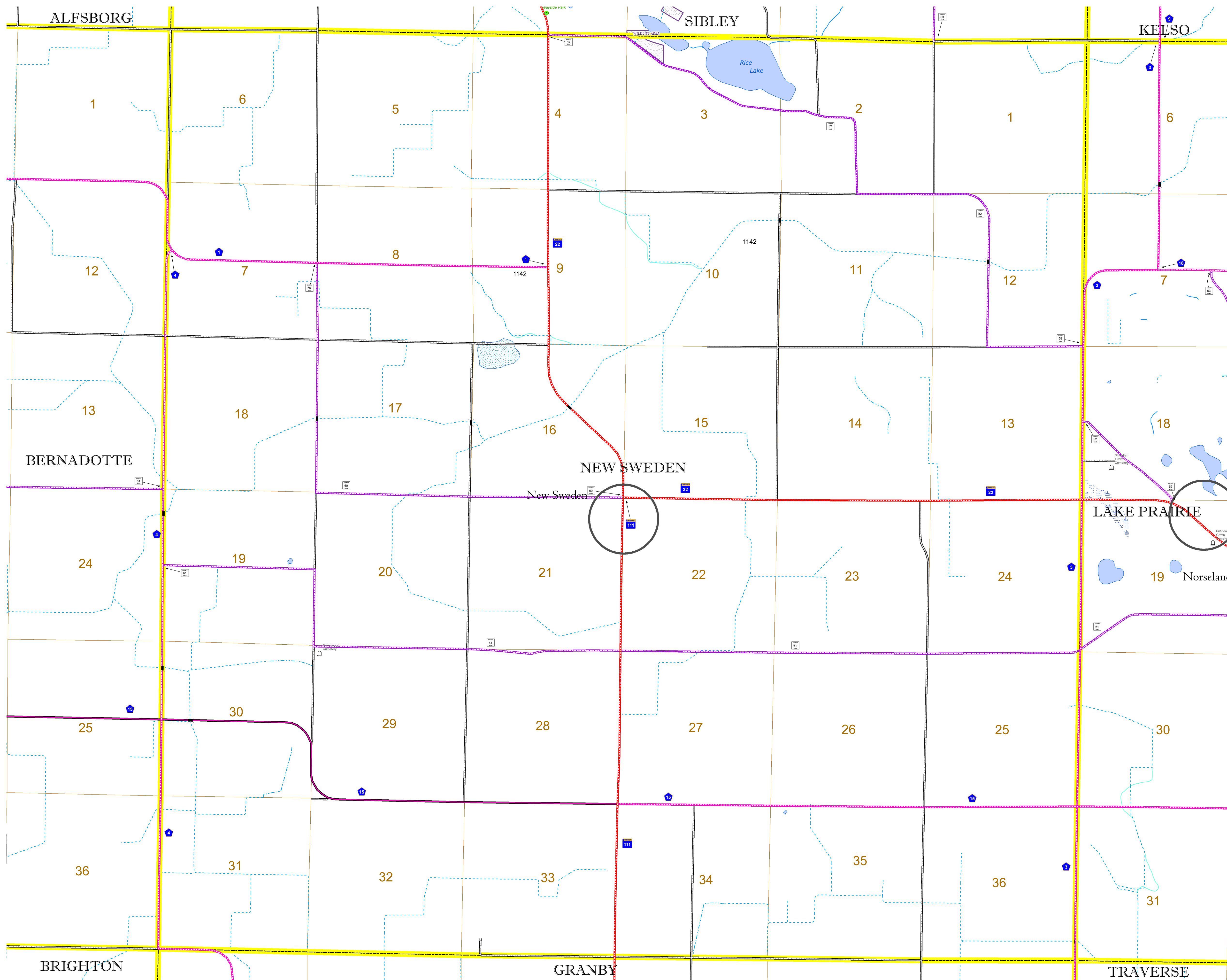

ROAD AND ROADWAY FEATURES		AVIATION FEATURES	
INTERSTATE	CONCRETE	COMMERCIAL AIRPORT	GENERAL AIRPORT
US HIGHWAY	BITUMINOUS	AIRSTRIP	SEAPLANE
MN HIGHWAY	GRAVEL	AIRPORT RUNWAY	AIRPORT RUNWAY
COUNTY STATE AID HIGHWAY	DIRT/UNIMPROVED		
COUNTY ROAD	OTHER		
TOWNSHIP ROAD	UNKNOWN		
UNORGANIZED TERRITORY ROAD			
OTHER ROADS			
Municipal	RAMP OR CONNECTOR		
Private	INTERSTATE EXIT		
Nature Service	GREAT RIVER ROAD		
National Park			
National Wildlife Refuge			
State Game Preserve			
RAILROAD AND RAILWAY FEATURES		BOUNDARY FEATURES	
EMPIRE BUILDER STATION (AMTRAK)	TRIBAL LAND	STATE OF MINNESOTA	COUNTY
NORTHSTAR STATION (COMMUTER)	STATE OF MINNESOTA	MUNICIPALITY	MUNICIPALITY
LIGHT RAIL	UNINCORPORATED TOWNSHIP	UNINCORPORATED TOWNSHIP	CIVIL TOWNSHIP
BLUE LINE	FEDERAL ADJUSTED URBAN AREA (2014)		
GREEN LINE	CIVIL TOWNSHIP		
	CONGRESSIONAL TOWNSHIP		
INFRASTRUCTURE FEATURES		PUBLIC SERVICE FEATURES	
LONG BRIDGE (200' or Greater Span)	MNDOT OFFICE	STATE CAPITAL	COUNTY SEAT
MAJOR BRIDGE (20' to 200' Span)	HIGHWAY PATROL DISTRICT OFFICE	CITY CENTER	CITY CENTER
MINOR BRIDGE (5' to 20' Span)	STATE TRAVEL INFORMATION CENTER	UNINCORPORATED COMMUNITY	UNINCORPORATED COMMUNITY
DAM	REST AREA (Full Service)		
LOCK AND DAM	REST AREA (Vault Toilet)		
	WAYSIDE (Vault or P/T Toilet)		
	PARK AND RIDE LOT		
	PORT OF ENTRY		
	PUBLIC ACCESS POINT		
	MN STATE COLLEGE AND UNIVERSITY SYSTEM (MNSCU)		
	UNIVERSITY OF MN SYSTEM		
	FAIRGROUNDS		
CULTURAL FEATURES		HYDROLOGIC FEATURES	
STATE HISTORICAL MARKER	STATE HISTORICAL MARKER	WETLAND	WETLAND
HISTORIC DISTRICT	HISTORIC DISTRICT	ISLAND OR LAND	ISLAND OR LAND
HISTORIC SITE	HISTORIC SITE	REGIONAL WATERSHED	REGIONAL WATERSHED
MONUMENT	MONUMENT		

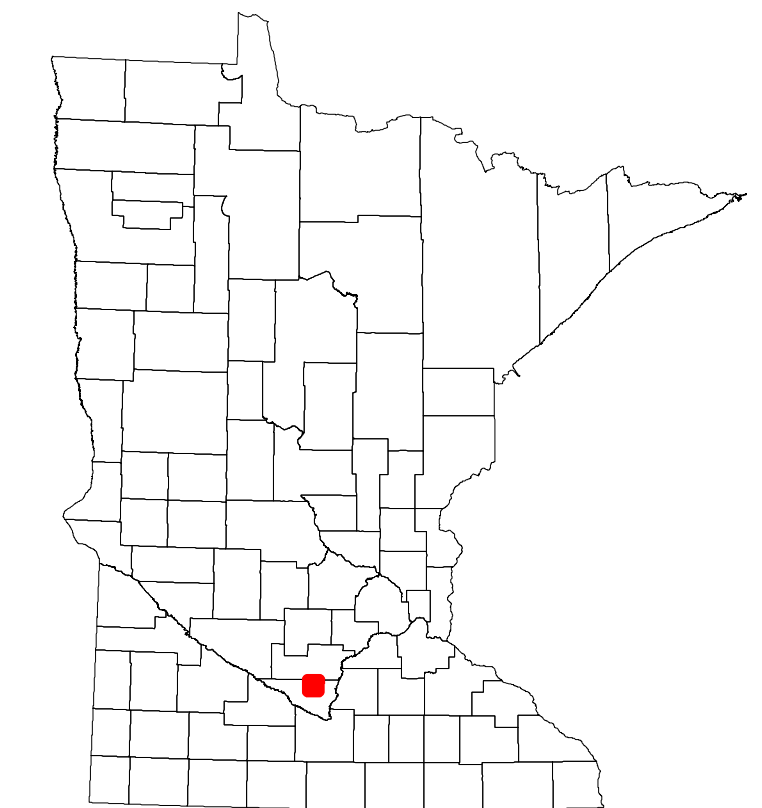

Population (U.S. Census 2010): 297

To request information from this document in an alternative format, call 651-366-4718 or 1-800-657-3774 (Greater Minnesota); 711 or 1-800-627-3529 (Minnesota Relay). You may also send an e-mail to ADArequest.dot@state.mn.us. (Please request at least one week in advance.)