

TOWNSHIP OF ORONOCO

PREPARED BY THE
MINNESOTA DEPARTMENT OF TRANSPORTATION
OFFICE OF TRANSPORTATION SYSTEM MANAGEMENT

IN COOPERATION WITH
U.S. DEPARTMENT OF TRANSPORTATION
FEDERAL HIGHWAY ADMINISTRATION



1 in = 1,600 ft

2023

Projection:
Transverse Mercator
NAD 1986
UTM Zone 15



North American Datum
of 1986

ROAD AND ROADWAY FEATURES	
INTERSTATE	CONCRETE
US HIGHWAY	BITUMINOUS
MN HIGHWAY	GRAVEL
COUNTY STATE AID HIGHWAY	DIRT/UNIMPROVED
COUNTY ROAD	OTHER
TOWNSHIP ROAD	UNKNOWN
UNORGANIZED TERRITORY ROAD	
OTHER ROADS	
Municipal	RAMP OR CONNECTOR
Private	INTERSTATE EXIT
National Monument	GREAT RIVER ROAD
National Park	
National Wildlife Refuge	
State Park	
Preserve	
RAILROAD AND RAILWAY FEATURES	
EMPIRE BUILDER STATION (AMTRAK)	COMMERCIAL AIRPORT
NORTHSTAR STATION (COMMUTER)	GENERAL AIRPORT
SEAPLANE	AIRSTRIP
SEAPLANE	SEAPLANE
AIRPORT RUNWAY	AIRPORT RUNWAY
BOUNDARY FEATURES	
TRIBAL LAND	STATE OF MINNESOTA
COUNTY	MUNICIPALITY
UNINCORPORATED TOWNSHIP	FEDERAL ADJUSTED URBAN AREA (2014)
CIVIL TOWNSHIP	CONGRESSIONAL TOWNSHIP
SECTION	MILITARY
VOYAGEURS NATIONAL PARK	BOUNDARY WATERS CANOE AREA WILDERNESS
STATE PARK	REGIONAL PARK
NATIONAL FOREST	NATIONAL AND STATE FOREST
STATE FOREST	WILDLIFE REFUGUE AREA
WILDLIFE MANAGEMENT AREA	HYDROLOGIC FEATURES
RIVER OR STREAM (PERENNIAL)	LAKE, POND OR RESERVOIR
STREAM (INTERMITTENT)	DRAINAGE DITCH
WETLAND	ISLAND OR LAND
REGIONAL WATERSHED	

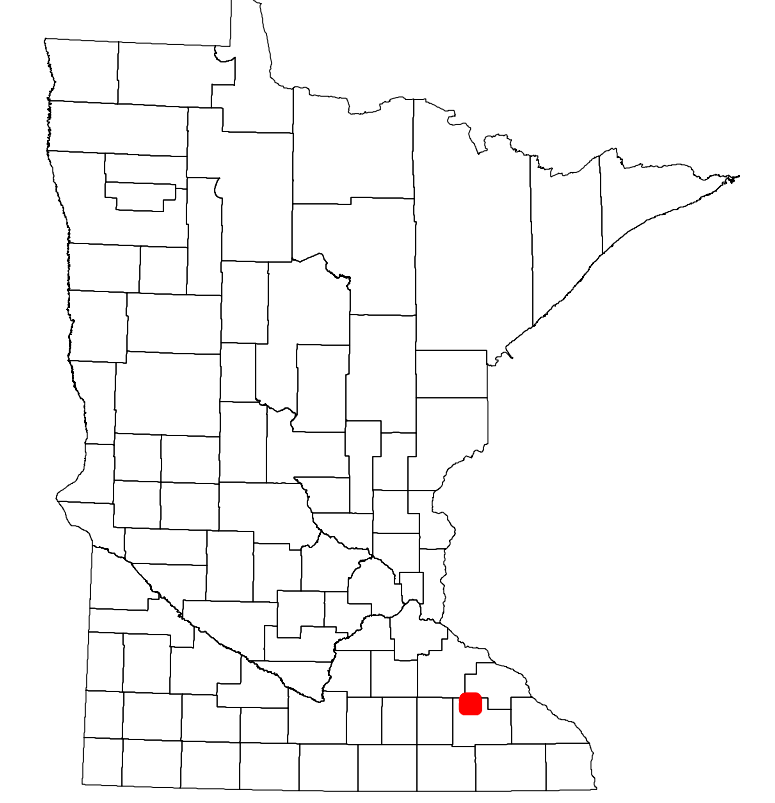

Population (U.S. Census 2010): 2220

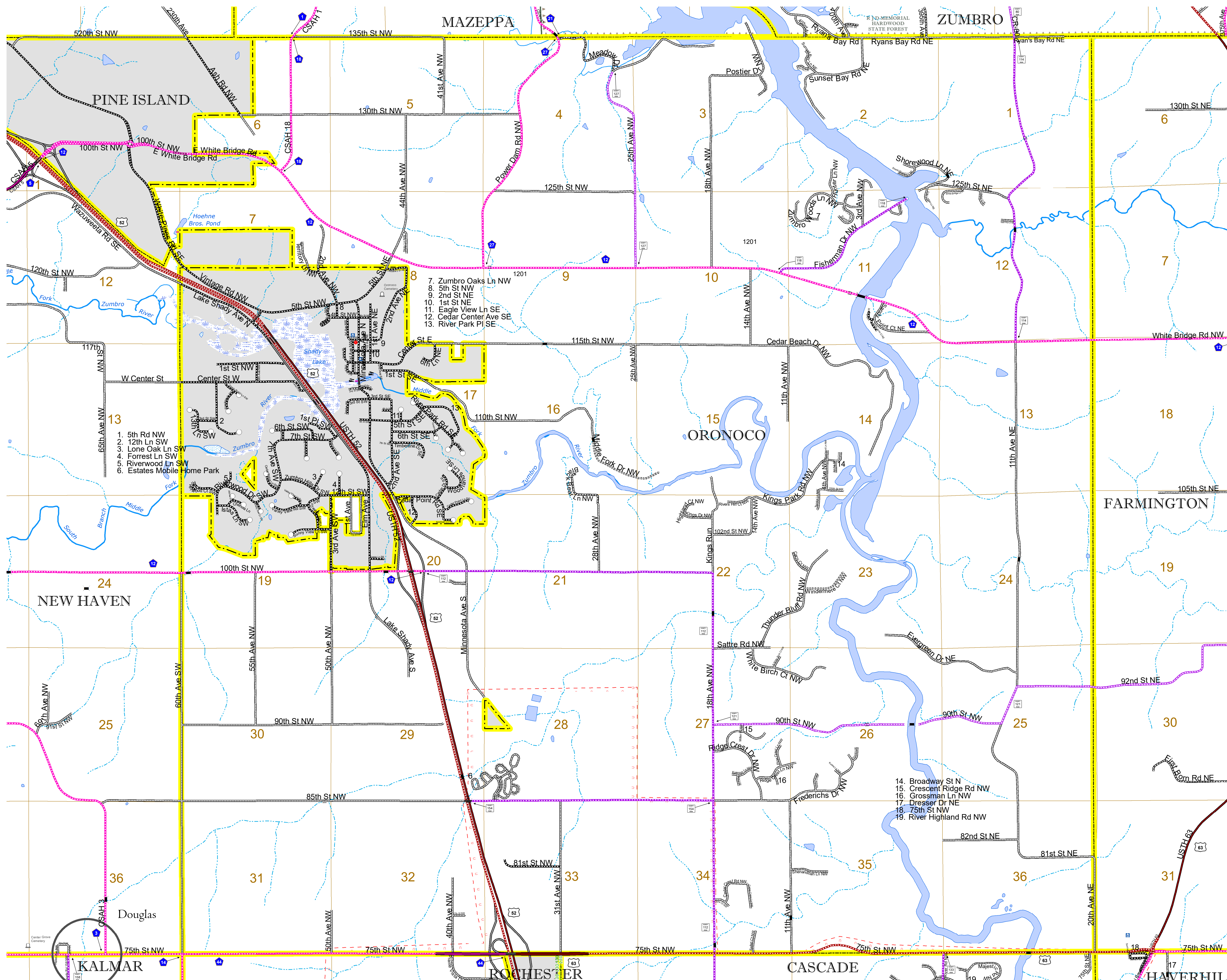

To request information from this document in an alternative format, call 651-366-4718 or 1-800-657-3774 (Greater Minnesota); 711 or 1-800-627-3529 (Minnesota Relay). You may also send an e-mail to ADRequest.dot@state.mn.us. (Please request at least one week in advance.)