

TOWNSHIP OF BANGOR

PREPARED BY THE
MINNESOTA DEPARTMENT OF TRANSPORTATION
OFFICE OF TRANSPORTATION SYSTEM MANAGEMENT

IN COOPERATION WITH
U.S. DEPARTMENT OF TRANSPORTATION
FEDERAL HIGHWAY ADMINISTRATION



2022

Projection:
Transverse Mercator
NAD 1986
UTM Zone 15

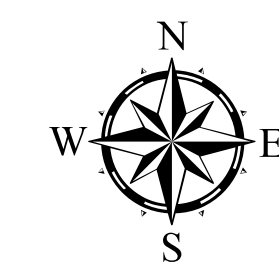

North American Datum
of 1986

ROAD AND ROADWAY FEATURES		BOUNDARY FEATURES	
INTERSTATE	CONCRETE	TRIAL LAND	TRIBAL LAND
US HIGHWAY	BITUMINOUS	STATE OF MINNESOTA	COUNTY
MN HIGHWAY	GRAVEL	MUNICIPALITY	UNINCORPORATED COMMUNITY
COUNTY STATE AID HIGHWAY	DIRT/UNIMPROVED	UNORGANIZED TERRITORY	FEDERAL ADJUSTED URBAN AREA (2014)
COUNTY ROAD	OTHER	CIVIL TOWNSHIP	CONGRESSIONAL TOWNSHIP
TOWNSHIP ROAD	UNKNOWN	SECTION	MILITARY
UNORGANIZED TERRITORY ROAD		VOYAGEURS NATIONAL PARK	BOUNDARY WATERS CANOE AREA WILDERNESS
OTHER ROADS		STATE PARK	REGIONAL PARK
Municipal	RAMP OR CONNECTOR	NATIONAL FOREST	NATIONAL AND STATE FOREST
Private	INTERSTATE EXIT	STATE FOREST	NATIONAL TRAIL
National Monument	GREAT RIVER ROAD	WILDLIFE REFUGUE AREA	WILDLIFE MANAGEMENT AREA
National Wildlife Refuge	AVIATION FEATURES	HYDROLOGIC FEATURES	RIVER OR STREAM (PERENNIAL)
State Park	COMMERCIAL AIRPORT	LAKE, POND OR RESERVOIR	STREAM (INTERMITTENT)
Preserve	GENERAL AIRPORT	DRAINAGE DITCH	WETLAND
	AIRSTRIP	ISLAND OR LAND	REGIONAL WATERSHED
	SEAPLANE		
	AIRPORT RUNWAY		

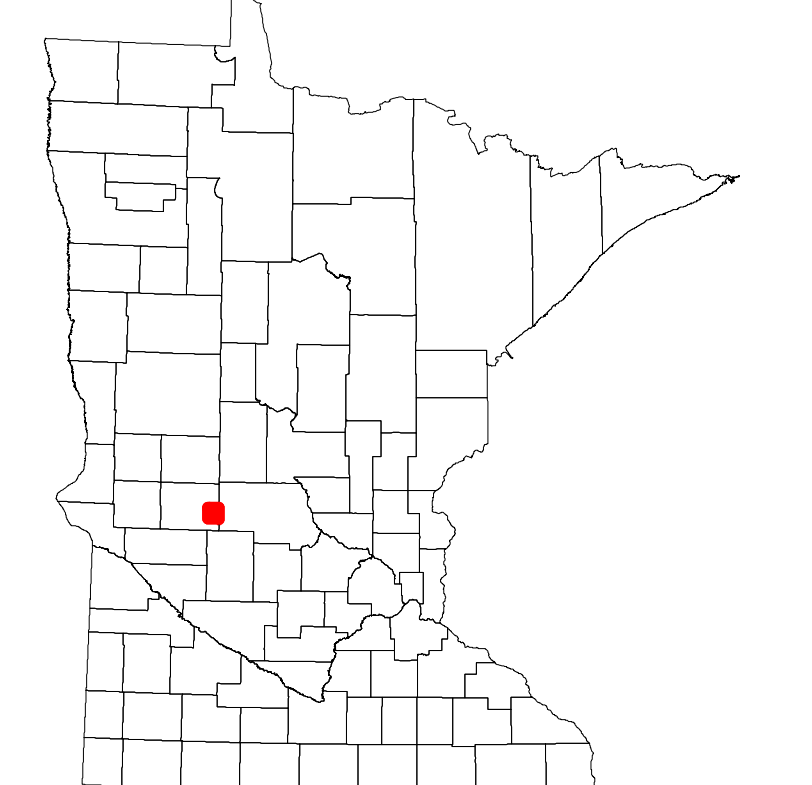

Population (U.S. Census 2010): 185

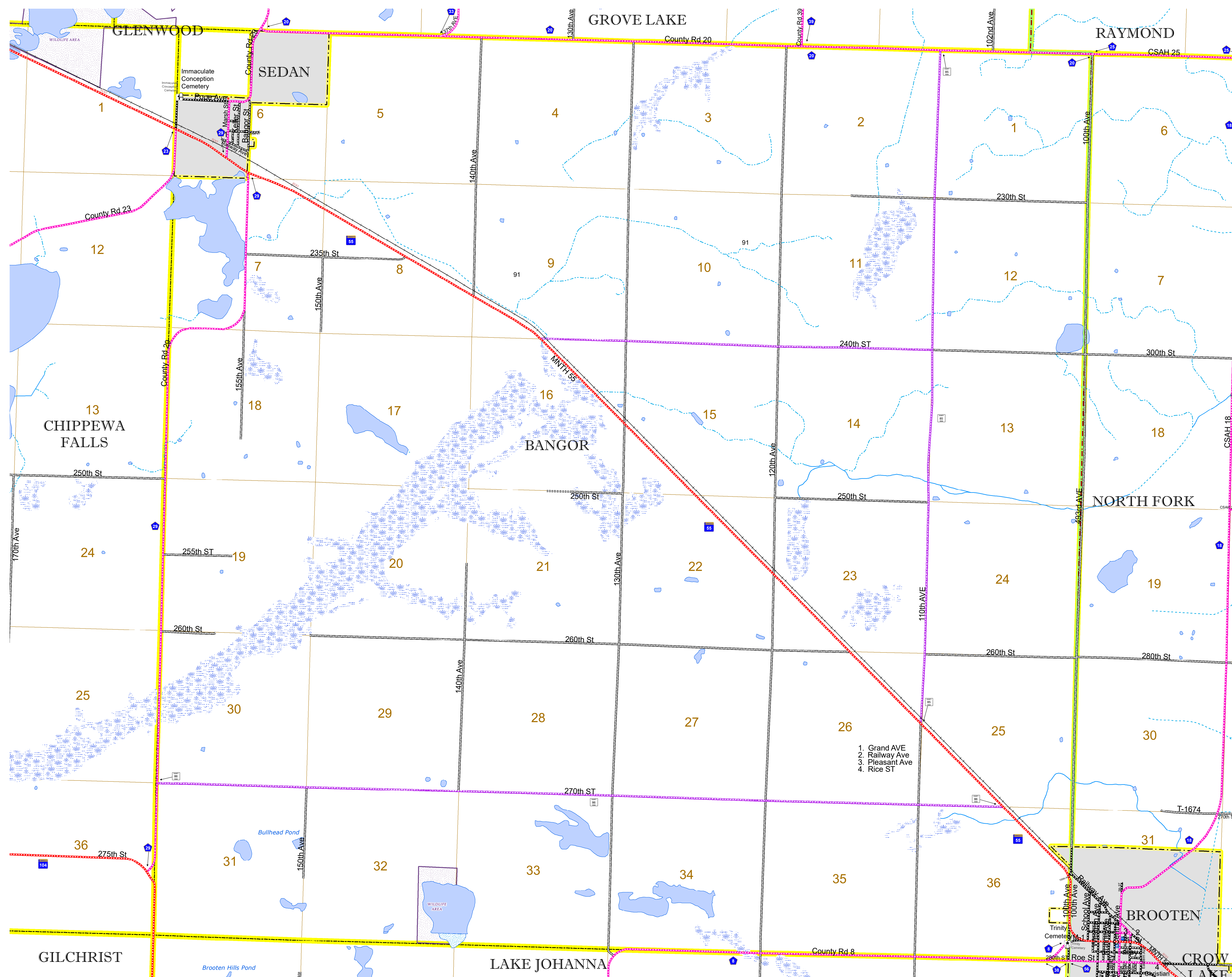

1. Grand AVE
2. Railway Ave
3. Pleasant Ave
4. Rice ST

To request information from this document in an alternative format, call 651-366-4718 or 1-800-657-3774 (Greater Minnesota); 711 or 1-800-627-3529 (Minnesota Relay). You may also send an e-mail to ADarequest.dot@state.mn.us. (Please request at least one week in advance.)