

TOWNSHIP OF BISMARCK

PREPARED BY THE
MINNESOTA DEPARTMENT OF TRANSPORTATION
OFFICE OF TRANSPORTATION SYSTEM MANAGEMENT

IN COOPERATION WITH
U.S. DEPARTMENT OF TRANSPORTATION
FEDERAL HIGHWAY ADMINISTRATION

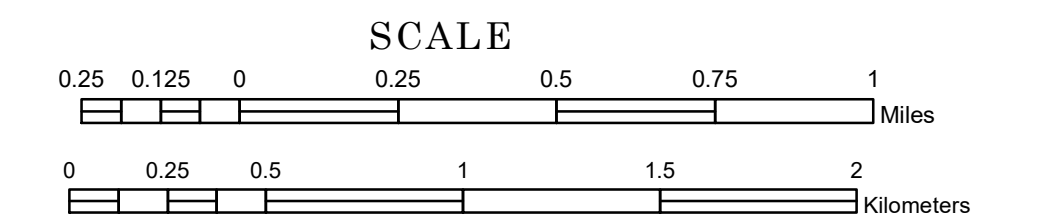

1 in = 1,600 ft
2022

Projection:
Transverse Mercator
NAD 1986
UTM Zone 15

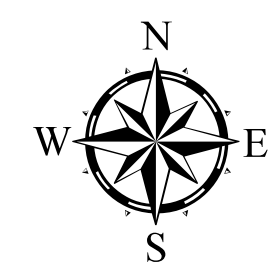

North American Datum
of 1986

ROAD AND ROADWAY FEATURES	
INTERSTATE	CONCRETE
US HIGHWAY	BITUMINOUS
MN HIGHWAY	GRAVEL
COUNTY STATE AID HIGHWAY	DIRT/UNIMPROVED
COUNTY ROAD	OTHER
TOWNSHIP ROAD	UNKNOWN
UNORGANIZED TERRITORY ROAD	
OTHER ROADS	
Municipal	RAMP OR CONNECTOR
Private	INTERSTATE EXIT
National Monument	AVIATION FEATURES
National Park	Commercial Airport
National Wildlife	General Airport
State Park	Airstrip
Preserve	Seaplane
RAILROAD AND RAILWAY FEATURES	
	Airport Runway
Empire Builder Station (Amtrak)	Commercial Airport
Northstar Station (Commuter)	General Airport
Light Rail	Airstrip
Blue Line	Seaplane
Green Line	Airport Runway
INFRASTRUCTURE FEATURES	
Long Bridge (200' or Greater Span)	Tribal Land
Major Bridge (20' to 200' Span)	State of Minnesota
Minor Bridge (5' to 20' Span)	County
Dam	Municipality
Lock and Dam	Unorganized Territory
CITY CENTERS	
State Capital	Federal Adjusted Urban Area (2014)
County Seat	Civil Township
City Center	Congressional Township
Unincorporated Community	Section
PUBLIC SERVICE FEATURES	
MNDOT Office	Military
MNDOT Truck Station	Voyageurs National Park
Highway Patrol District Office	Boundary Waters Canoe Area Wilderness
State Travel Information Center	State Park
Rest Area (Full Service)	National Forest
Rest Area (Vault Toilet)	National and State Forest
Wayside (Vault or Potty Toilet)	State Forest
Park and Ride Lot	National Trail
Port of Entry	Wildlife Refuge Area
Public Access Point	Wildlife Management Area
MN State College and University System (MNSCU)	Hydrologic Features
University of MN System	River or Stream (Perennial)
Fairgrounds	Lake, Pond or Reservoir
CULTURAL FEATURES	
State Historical Marker	Stream (Intermittent)
Historic District	Drainage Ditch
Historic Site	Wetland
Monument	Island or Land
	Regional Watershed

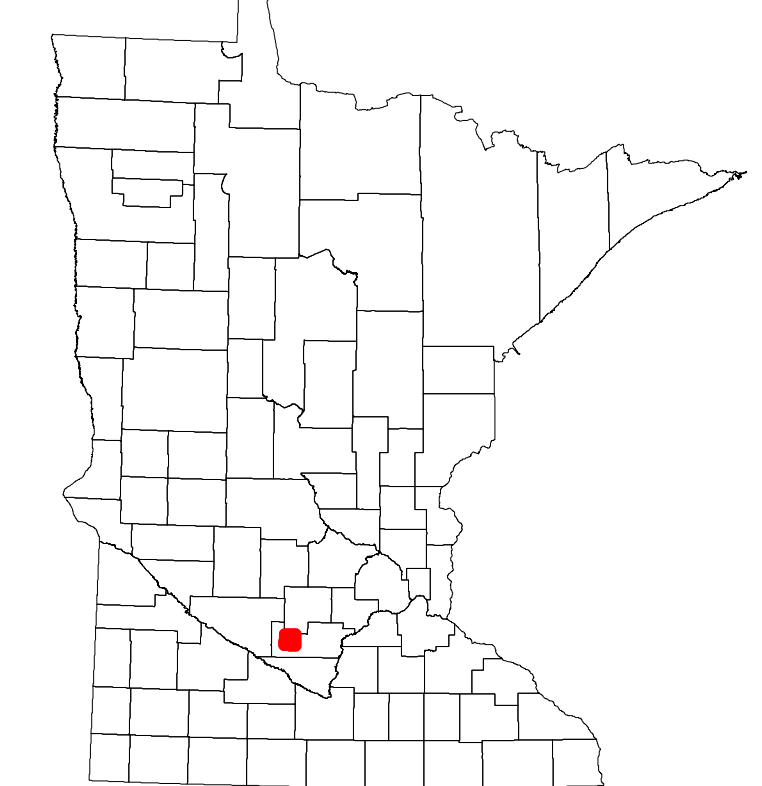

Population (U.S. Census 2010): 314

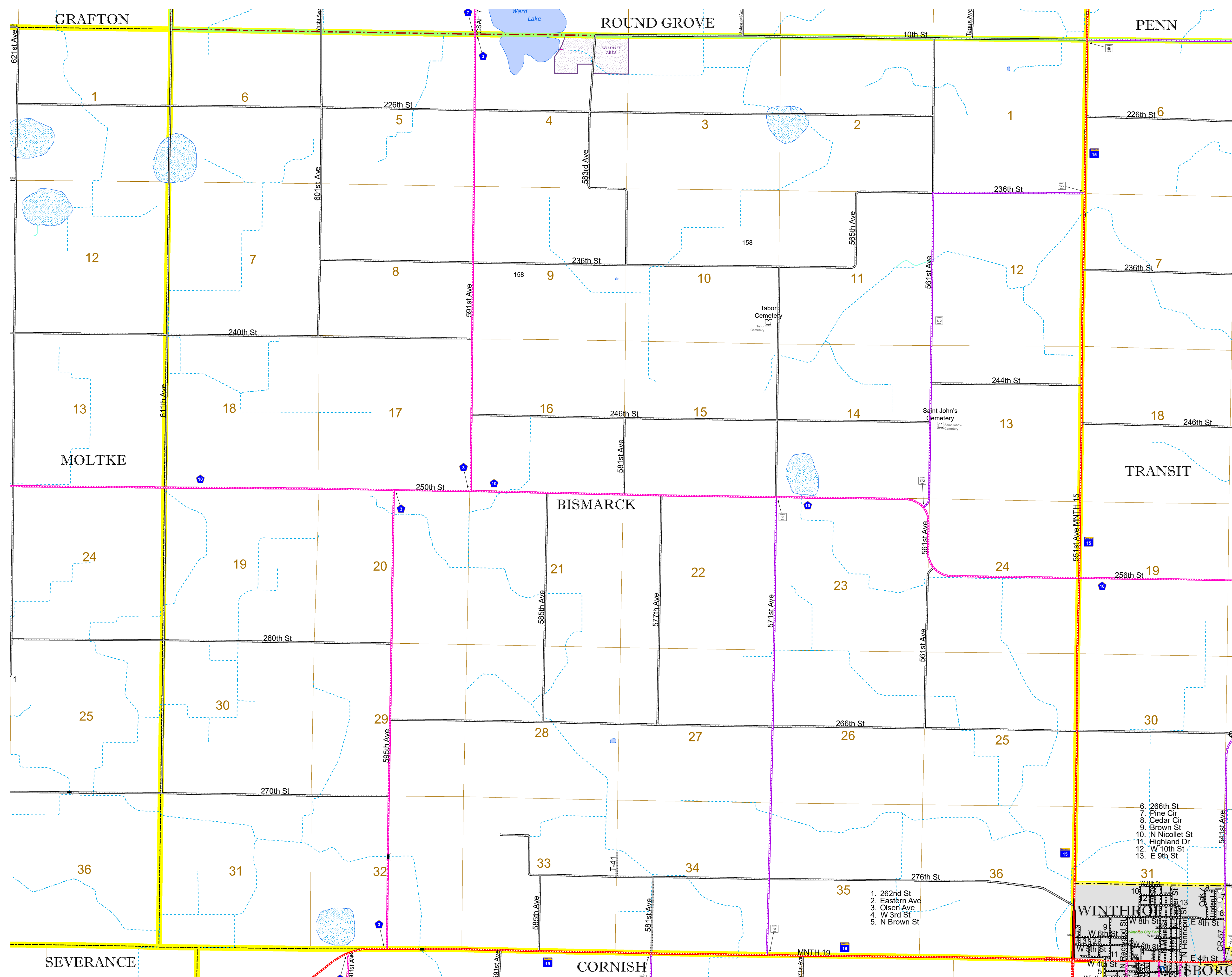

- 1. 262nd St
- 2. Eastern Ave
- 3. Olsen Ave
- 4. W 3rd St
- 5. N Brown St

- 6. 266th St
- 7. Pine Cir
- 8. Cedar Cir
- 9. Brown St
- 10. N Nicollet St
- 11. Highland Dr
- 12. W 10th St
- 13. E 9th St

To request information from this document in an alternative format, call 651-366-4718 or 1-800-657-3774 (Greater Minnesota); 711 or 1-800-627-3529 (Minnesota Relay). You may also send an e-mail to ADarequest.dot@state.mn.us. (Please request at least one week in advance.)