

# TOWNSHIP OF MAZEPPA

PREPARED BY THE  
MINNESOTA DEPARTMENT OF TRANSPORTATION  
OFFICE OF TRANSPORTATION SYSTEM MANAGEMENT

IN COOPERATION WITH  
U.S. DEPARTMENT OF TRANSPORTATION  
FEDERAL HIGHWAY ADMINISTRATION



1 in = 1,600 ft

2022

Projection:  
Transverse Mercator  
NAD 1986  
UTM Zone 15

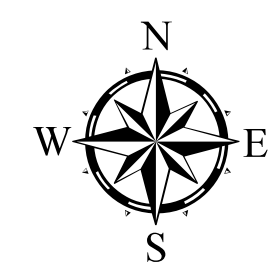

North American Datum  
of 1986

ROAD AND ROADWAY FEATURES		BOUNDARY FEATURES	
INTERSTATE	CONCRETE	TRIBAL LAND	STATE OF MINNESOTA
US HIGHWAY	BITUMINOUS	COUNTY	MUNICIPALITY
MN HIGHWAY	GRAVEL	UNINCORPORATED TOWNSHIP	CIVIL TOWNSHIP
COUNTY STATE AID HIGHWAY	DIRT/UNIMPROVED	CONGRESSIONAL TOWNSHIP	SECTION
COUNTY ROAD	OTHER	MILITARY	VOYAGEURS NATIONAL PARK
TOWNSHIP ROAD	UNKNOWN	UNINCORPORATED COMMUNITY	BOUNDARY WATERS CANOE AREA WILDERNESS
UNORGANIZED TERRITORY ROAD			STATE PARK
OTHER ROADS			REGIONAL PARK
Municipal	RAMP OR CONNECTOR		NATIONAL FOREST
Private	INTERSTATE EXIT		NATIONAL AND STATE FOREST
National Monument	GREAT RIVER ROAD		STATE FOREST
National Wildlife Refuge	RAILROAD AND RAILWAY FEATURES		WILDLIFE REFUGUE AREA
State Game Preserve	RAILROAD		WILDLIFE MANAGEMENT AREA
	EMPIRE BUILDER STATION (AMTRAK)		HYDROLOGIC FEATURES
	NORTHSTAR STATION (COMPUTER)		RIVER OR STREAM (PERMANENT)
	LIGHT RAIL		LAKE, POND OR RESERVOIR
	BLUE LINE		STREAM (INTERMITTENT)
	GREEN LINE		DRAINAGE DITCH
	INFRASTRUCTURE FEATURES		WETLAND
	LONG BRIDGE (200' OR GREATER SPAN)		ISLAND OR LAND
	MAJOR BRIDGE (20' TO 200' SPAN)		REGIONAL WATERSHED
	MINOR BRIDGE (5' TO 20' SPAN)		
	DAM		
	LOCK AND DAM		
	CITY CENTERS		
	STATE CAPITAL		
	COUNTY SEAT		
	CITY CENTER		
	UNINCORPORATED COMMUNITY		
	PUBLIC SERVICE FEATURES		
	MNDOT OFFICE		
	MNDOT TRUCK STATION		
	HIGHWAY PATROL DISTRICT OFFICE		
	STATE TRAVEL INFORMATION CENTER		
	REST AREA (FULL SERVICE)		
	REST AREA (VAULT TOILET)		
	WAYSIDE (VAULT OR PIT TOILET)		
	PARK AND RIDE LOT		
	PORT OF ENTRY		
	PUBLIC ACCESS POINT		
	MN STATE COLLEGE AND UNIVERSITY SYSTEM (MNSCU)		
	UNIVERSITY OF MN SYSTEM		
	FAIRGROUNDS		
	CULTURAL FEATURES		
	STATE HISTORICAL MARKER		
	HISTORIC DISTRICT		
	HISTORIC SITE		
	MONUMENT		

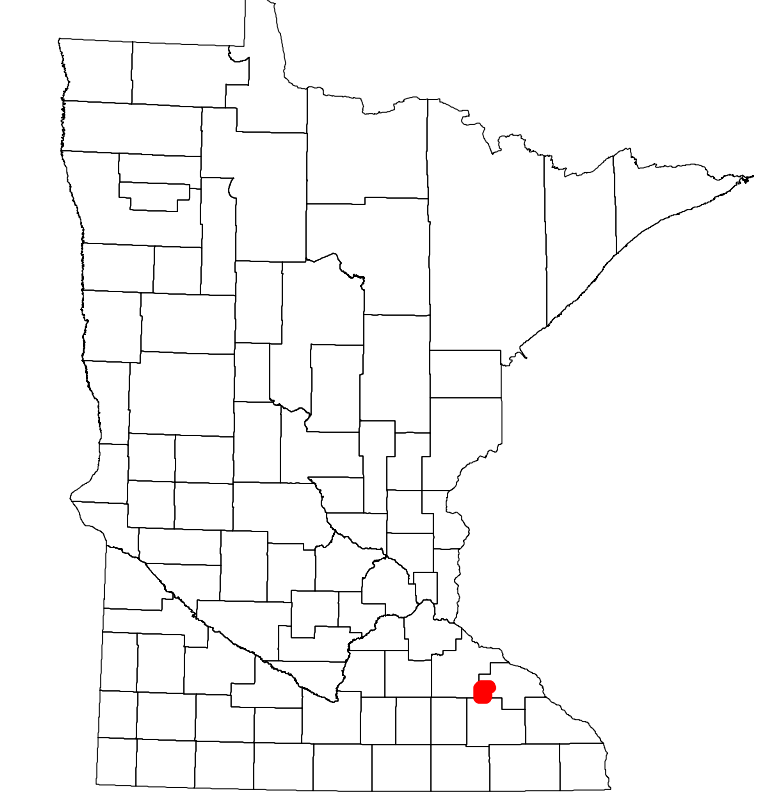

Population (U.S. Census 2010): 717

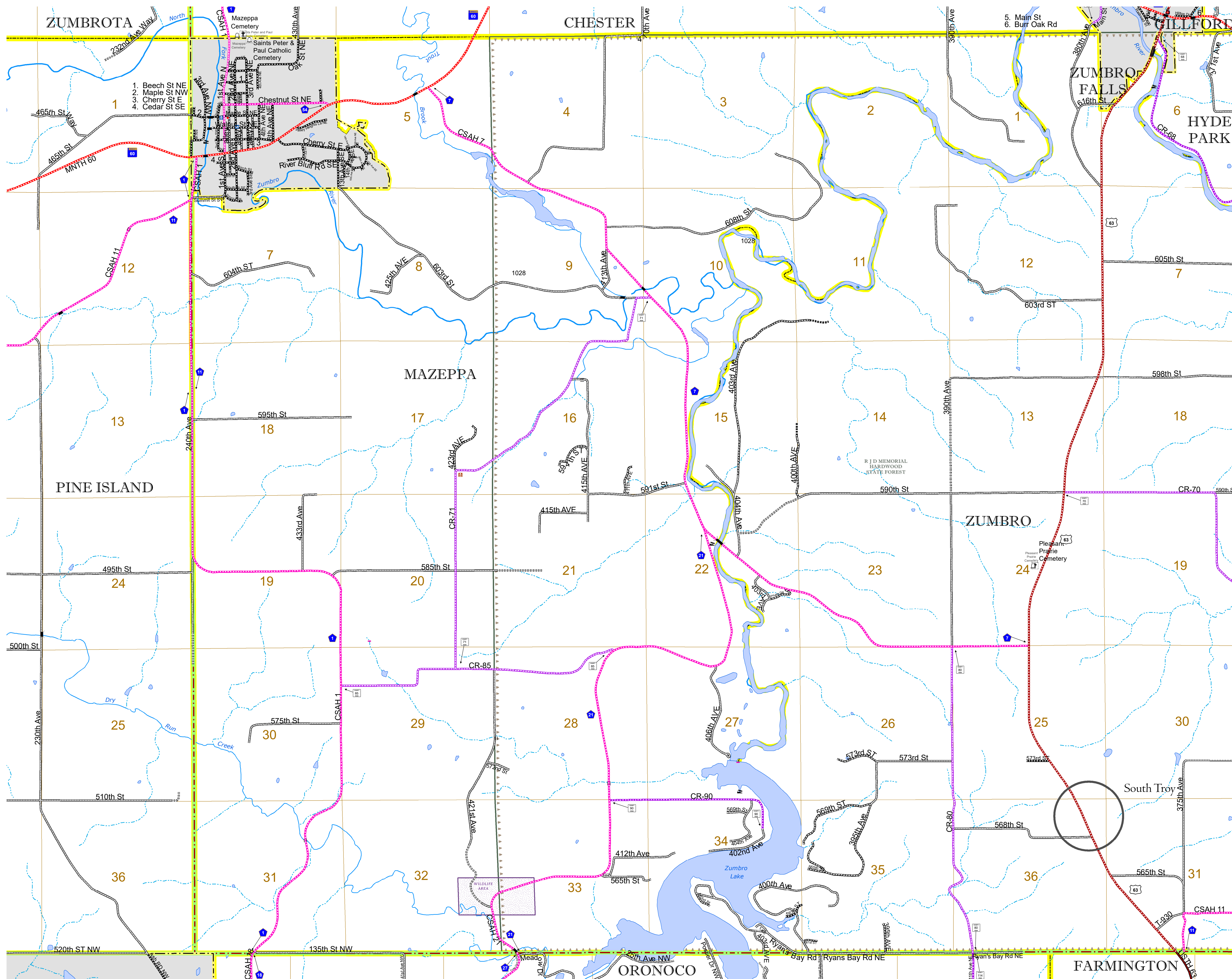

To request information from this document in an alternative format, call 651-366-4718 or 1-800-657-3774 (Greater Minnesota); 711 or 1-800-627-3529 (Minnesota Relay). You may also send an e-mail to ADAREquest.dot@state.mn.us. (Please request at least one week in advance.)