

PREPARED BY
HIGHWAY PLANNING SURVEY
IN COOPERATION WITH
U.S. PUBLIC ROADS ADMINISTRATION

STATE OF MINNESOTA
DEPARTMENT OF HIGHWAYS
ROAD LIFE STUDIES
CONSTRUCTION PROJECT LOG RECORD

CONTROL SECTION 1209
TRUNK HIGHWAY 40
COUNTY Chippewa
DISTRICT 8A

LIMITS: W. End of Bridge (Minn. River) - W. Jct. T.H. 29

YEAR BUILT	PROJECT N°	DESCRIPTION			CODE N°
		TYPE	WIDTH	THICKNESS	
		Gravel	20' 2"		No Record of Constr.
					Added in 1934.
1923		Grading	24'		Co. Job 2301. Added
		Gravel	20'		in 1934. 1200 C.Y./Mi.
		Br. X-173	16'		165' H.T. & W.S.
1931		Br. 5115	23'		Co. Job 3106.
					140' H.T.
					Added in 1934.
1936	40-145-22	Br. 5650, 5649, 5656 & 5651			W 106, W 104, W 128 & W 108.
1937	40-145-21-1	Grading	30' 4"		Direct Labor.
		Gravel	30'	1"	
1938	1209-01	Br. 5380	27'		160' H.T.
1938	A.F.E.19	Mixed Bitum.	24'	1"	Maint. Dept.
C	1941	A.F.E.29	26'	1 1/2"	Maint. Dept.
M	1942	A.F.E.5			RT 10.3402 Gal./Mi. Grav. 278 C.Y./Mi. Maint. Dept.
M	1942	A.F.E.6			259 C.Y./Mile. Maint. Dept.
M	1944	A.F.E.6			296 C.Y./Mi. Maint. Div.
M	1944	A.F.E.4			Bit. Surf. Repair
C	1947	1209-04	28'	1 3/4"	1000 C.Y./Mi.
C	1948	1209-05	32'	2 1/2"	1200 C.Y./Mi.

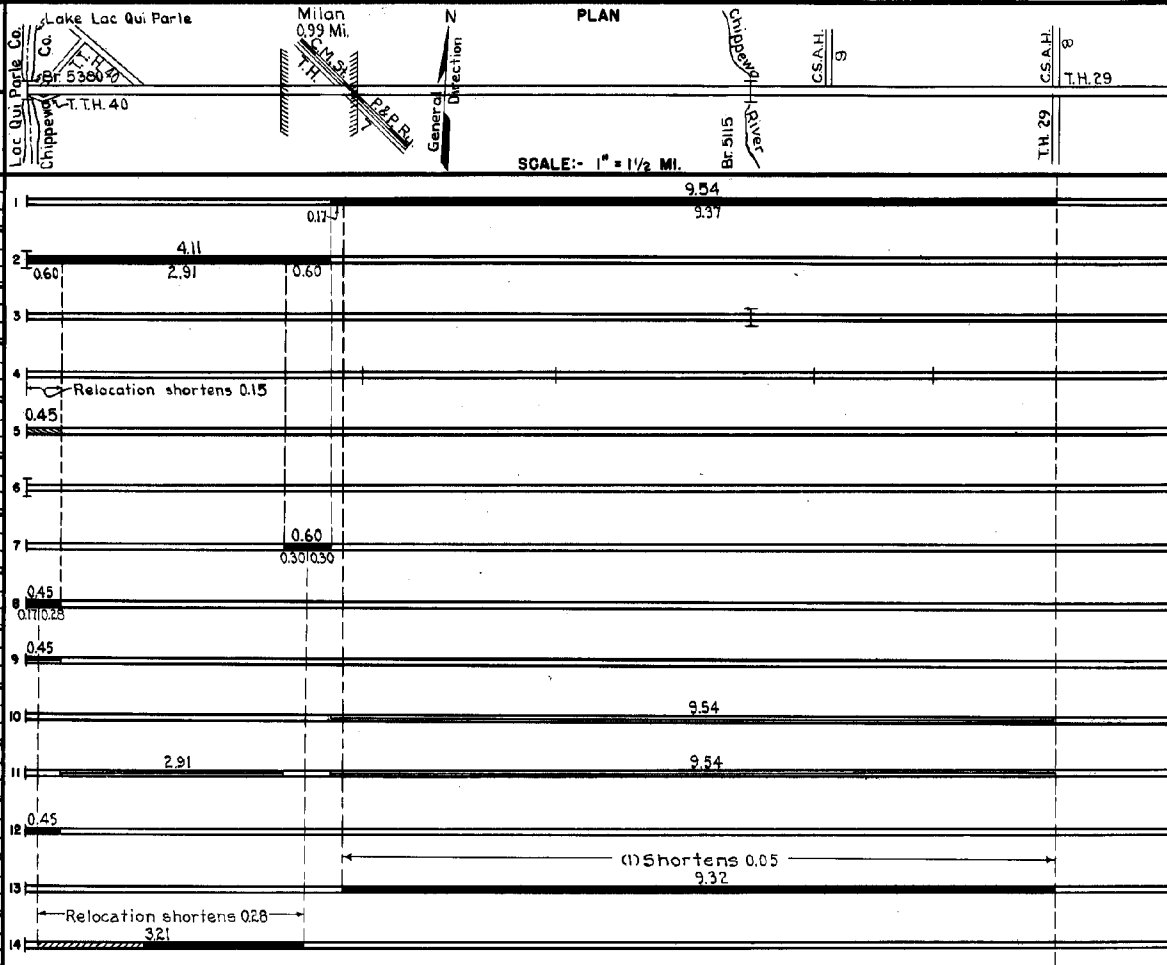

YEARS		TOTAL MILES	UNINCORPORATED		INCORPORATED		RURAL		URBAN	
FROM	TO		RDWY. MI.	BR. MI.	RDWY. MI.	BR. MI.	RDWY. MI.	BR. MI.	RDWY. MI.	BR. MI.
1934	1936	3.65	1.29	0.06	1.00	0.00	1.29	0.06	0.00	0.00
1937	1946	3.50	1.24	0.06	1.00	0.00	1.24	0.06	0.00	0.00
1947	1947	3.43	1.20	0.06	0.92	0.00	1.39	0.06	0.00	0.00
1948		13.17	12.12	0.06	0.99	0.00	13.11	0.06	0.00	0.00

REMARKS: Layout is to scale as of 1937 (1) C.S. now terminates at P.I. of W. Jct. T.H. 29
(2) Contract not final but work substantially complete in 1948.

PREPARED BY
HIGHWAY PLANNING SURVEY
IN COOPERATION WITH
U.S. PUBLIC ROADS ADMINISTRATION

STATE OF MINNESOTA
DEPARTMENT OF HIGHWAYS
ROAD LIFE STUDIES
CONSTRUCTION PROJECT LOG RECORD

CONTROL SECTION 1209
TRUNK HIGHWAY 40
COUNTY Chippewa
DISTRICT 6A

LIMITS: Yt. End of Bridge (Minn. River) - Yt. Jct. T.H. 29

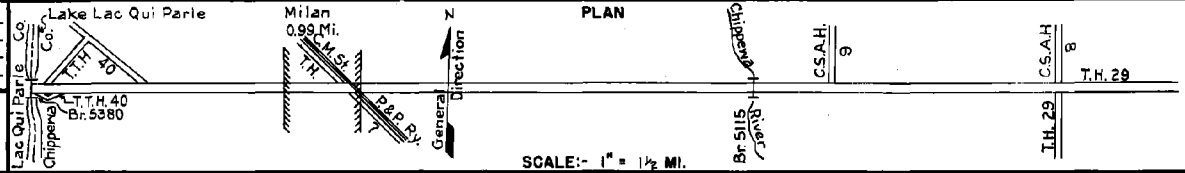

YEAR BUILT	PROJECT N°	DESCRIPTION				CODE N°	REMARKS
		TYPE	WIDTH	THICK-NESS	REMARKS		
C 1949	A.F.E. 16	Bit Surf. (12.70 Mi) Bit. Resurf. (0.47 Mi) Mixed Bit.	24'	1"	Bit. 142918 Gal. Agg. 7945 Tons Spot Subgr. Corr.	1	13.17
C 1951	A.F.E. 20	Bit. Resurfacing Mixed Bit. Spot Grade Lifts	23'	1" added	MC4, 125239 Gal. Agg. 9913 Tons	2	13.17
M 1952	A.F.E. 4	Spot Treat. Bit. Surf. Repair			MC2, 29972 Gal. Agg. 628 C.Y.	3	13.17 (Net 3.00)
M 1953	A.F.E. 604	Spot Treat. Bit. Surf. Repair	24'		MC3, 30181 Gal. Agg. 2358 Tons	4	9.50 (Net 4.00)
M 1954	A.F.E. 604 A.F.E. 605	Spot Treat. Bit. Surf. Repair Light Bit. Seal (817 M)	24'	24'	MC3&RS2, 37963 Gal. Agg. 1190 Tons & 865 C.Y.	5	13.17 (Net Repair 1.71)
M 1956	A.F.E. 604	Spot Treat. Bit. Surf. Repair	24'		MC3, 42210 Gal. Agg. 3444 Tons	6	13.17 (Net 5.92)
M 1957	A.F.E. 604	Spot Treat. Bit. Surf. Repair	24'		MC3, 14140 Gal. Agg. 1169 Tons	7	13.17 (Net 1.72)
M 1958	A.F.E. 604	Spot Treat. Bit. Surf. Repair	24'		MC3, 22872 Gal. Agg. 1610 Tons	8	13.17 (Net 3.44)
M 1960		Spot Treat. Bit. Surf. Repair	24'		MC-3 20052 Gal. Agg. 1485 Tons	9	6.63 (Net 2.34)
M 1961		Spot Treat. Bit. Surf. Repair	24'		MC-3, 17334 Gal. for Repair & 1343 Gal. for Tack	10	11.58 (Net 1.94)
M 1963		Spot Treat. Bit. Surf. Repair	24'		MC-3, 19843 Gal. Agg. 1642 Tons Tack. MC3, 1563 Gal.	11	10.14 (Net 2.23)
M 1964	C	Light Bit Seal	25'		RS-2K, 26682 Gal. Agg. 875 C.Y.	12	13.13
M 1967	SF	Bit. Surf. Repair	24'	1"	MC-800 Tack 2400 Gal. Bit. Surf. 2,982 Ton	13	12.42 (Net 4.27)
C 1973	1209-08	Bit Overlay Gravel Shoulders	23' 2.5'	3"		14	13.17

YEARS FROM	TOTAL MILES TO	UNINCORPORATED		INCORPORATED		RURAL		URBAN	
		ROWY. MI.	BR. MI.	ROWY. MI.	BR. MI.	ROWY. MI.	BR. MI.	ROWY. MI.	BR. MI.

REMARKS: See Sheet No. 1

