

PREPARED BY  
TRANSPORTATION & TRANSIT PLANNING & PROGRAMMING DIVISION  
IN COOPERATION WITH  
U.S. DEPARTMENT OF TRANSPORTATION-BUREAU OF PUBLIC ROADS

STATE OF MINNESOTA  
DEPARTMENT OF HIGHWAYS  
ROAD LIFE STUDIES  
CONSTRUCTION PROJECT LOG RECORD

CONTROL SECTION 1928  
TRUNK HIGHWAY 52  
COUNTY Dakota  
DISTRICT Metro

LIMITS: Jet TH 55 To South Limits of St. Paul  
Ref. Pt. 121+00.679 - 128+00.560

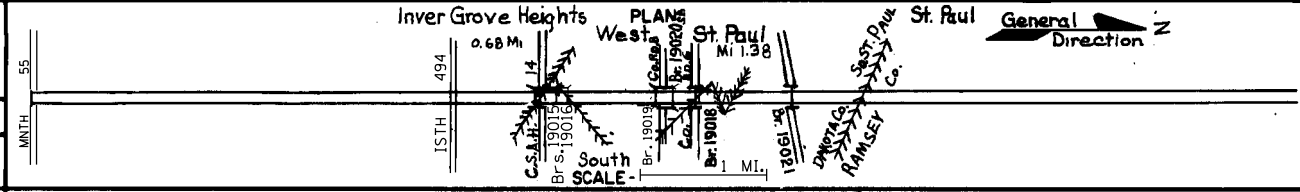

YEAR BUILT	PROJECT NO	DESCRIPTION			
		TYPE	WIDTH	THICKNESS	REMARKS
C	1975 1928-04 U044-1(99)	Grading Base RC. Conc.	24'-24"	8"	Divided Highway
C	1975 1928-04 U044-1(99)	Br. 19015 Br. 19016			163' P.P.G.-O.H. 163' P.P.G.-O.H.
C	1975 1928-08 U044-1(39)	Br. 19020, 19019 Br. 19018 Br. 19021			2 @ 141' P.P.G.-O.H. 265' P.P.G.-O.H. 160' P.P.G.-U.P.
C	1975 -14 U044-1(42)	GRADING, BASE P.L. MIX BIT. SURF. P.L. MIX BIT. SHLDRS	25'-74" 30'-36" 8'	16 1/2" 3"	TEMP. CONN.
C	1977 1928-75	CHANNELIZATION, TURN LANES, LIGHTING, TRAVELERS TEMP. SIGNAL SYSTEMS	12'	3"	
M	1985 1928- 19021	Br. 19021, Deck Repair & Overlay			
C	1985 -1985 -19856	Br. 19855 SB Br. 19856 NB			2-346.6' Bolted St. Cont. Bm. Sp.
C	1985 1985-67	Grading, Bit. Base Bit. Surfacing Bit. Shoulders	2-24' 2-24' 10'-4'	9" 2 1/4" 6"	Sp. 2331 Sp. 2331, 3/4" Sp. 2381 Sp. 2331
C	1988 1928-26 -27	Grading Bit. Surfacing	36' 24'	3" 1"	Spec. 2341 Spec. 2361
C	1990 1928-28	Grading Bit. Surfacing	24'	1"	Spec. 2341 Spec. 2361
C	1991 1928-29	Grading Bit. Surfacing	24'	3" 1"	Spec. 2331 Spec. 2341 Spec. 2361
C	1992 1928-30	Conc. Joint Repair			
C	1994 1928-35	Bit. Surfacing	45' 24'	Var.	Spec. 2331, 2341, 2361
S	2002 1928-47	Milling Bit. Overlay	24' 24'	2" 2"	Spec. 2360

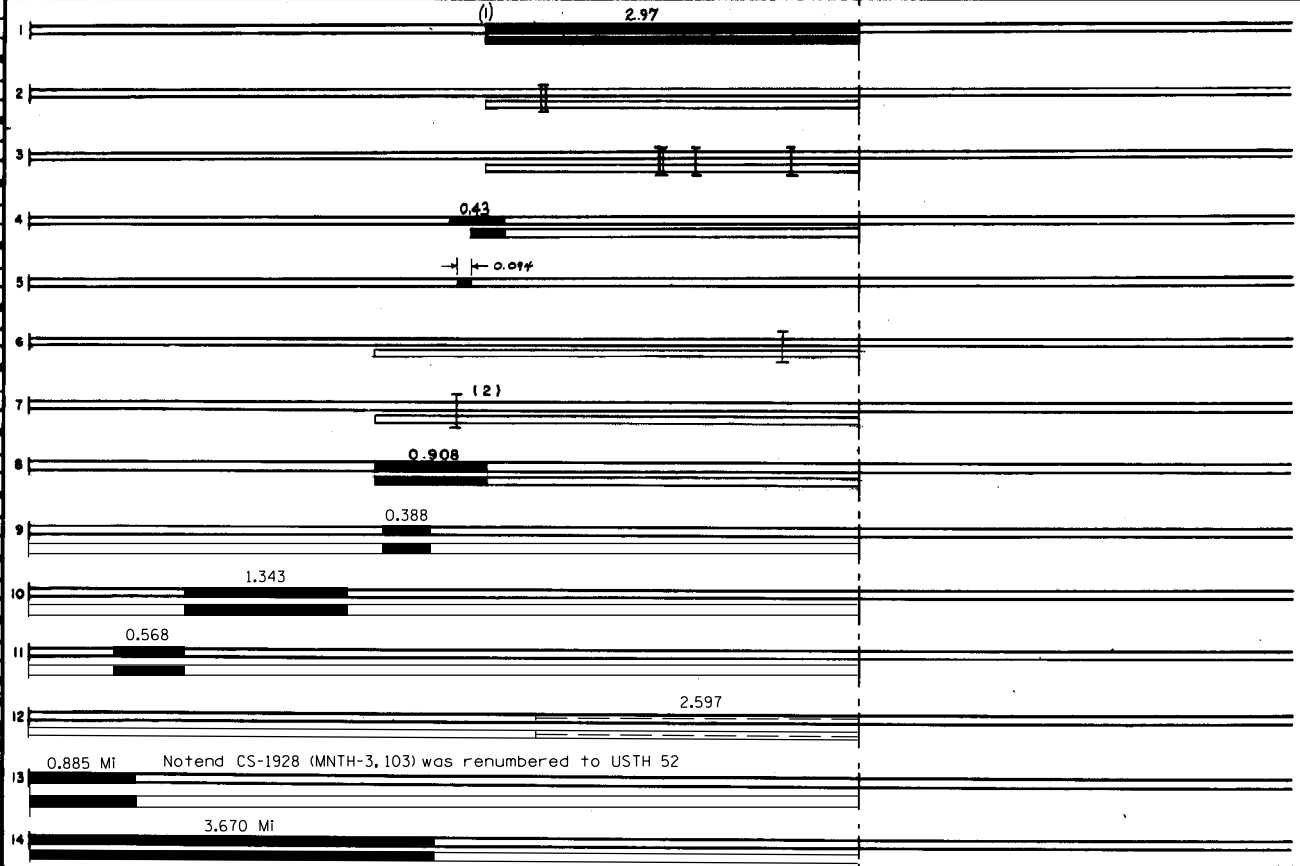

YEARS		TOTAL MILES	UNINCORPORATED		INCORPORATED		RURAL		URBAN	
FROM	TO		RDWY. MI.	BR. MI.	RDWY. MI.	BR. MI.	RDWY. MI.	BR. MI.	RDWY. MI.	BR. MI.
1975		3.24	-	-	3.13	0.11	-	-	3.13	0.11

REMARKS: Layout is to Scale as of 1975  
(1) THE 2.97 MI. INCLUDES 0.16 WHICH IS NOT IN USE IN 1975

