

PREPARED BY
HIGHWAY PLANNING SURVEY
IN COOPERATION WITH
U.S. PUBLIC ROADS ADMINISTRATION

STATE OF MINNESOTA
DEPARTMENT OF HIGHWAYS
ROAD LIFE STUDIES
CONSTRUCTION PROJECT LOG RECORD

CONTROL SECTION 2405
TRUNK HIGHWAY 95
COUNTY Freeborn
DISTRICT 68

LIMITS: E. Jct. T.H.16 - Temp. Conn. T.H.35

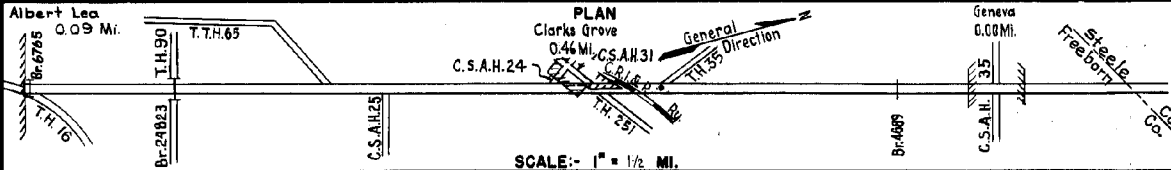

YEAR BUILT	PROJECT N°	DESCRIPTION			CODE N°
		TYPE	WIDTH	THICKNESS	
		Grading Gravel	22'2"	2"	Co. Job 1701
1928	65-1-51A&B	Grading Br. 4689	40'		W108 T
1929	65-1-51 A&B	Gravel	20'	2 1/2"	850 C.Y./Mile.
1929	65-1-51B	Concrete	20'	9-7-9	
1930	65-1-51A	Concrete	20'	9-7-9	
C	1933 A.F.E. 625	Misc. Drainage Structures			Co. Ditch No 30 1 M.N. of Clarks Grove.
C	1955 2405-05 2405-06	Grading Bit. Stab. Base Plant Mix Bit.	44' 44' 24'	6" 3"	on 12" Sand-Grav. Sub-base
C	1955 2405-03	Br. 6765	30'		213' B.S.-O.H.
C	1957 2405-02	Grading Bit. Stab. Base Mixed Bit.	44'78" 44'78" 2652'	6" 1 1/2"	0.49 Mi. Divided Highway on 12" Gravel Sub-base
C	1957 2405-07	Asphaltic Conc.	24'48"	3 1/2"	
M	1959 A.F.E. 605	Light Bit. Seal	25'		RS-2, 1887 Gal. Agg. 66 C.Y.
C&M	1964 C	Plant Mix Bit. Grav. Shoulders Light Bit Seal (0.77)	24' 20' 20'	3" 3" 3"	Seal Agg. 116 C.Y. RS-2K, 2361 Gal.
M	1964 SF	Shoulder repair	6'	2"	80 Gals. Tack. Agg. 110 Tons - 500 Gals
C	1967 C	Surface repair	20'	1"	Agg. 1153 Tons
M	1968 C	Bit. Surf. Repair	10'	1 1/4"	MC-250 Tack 280 Gal. Agg. 933 Ton

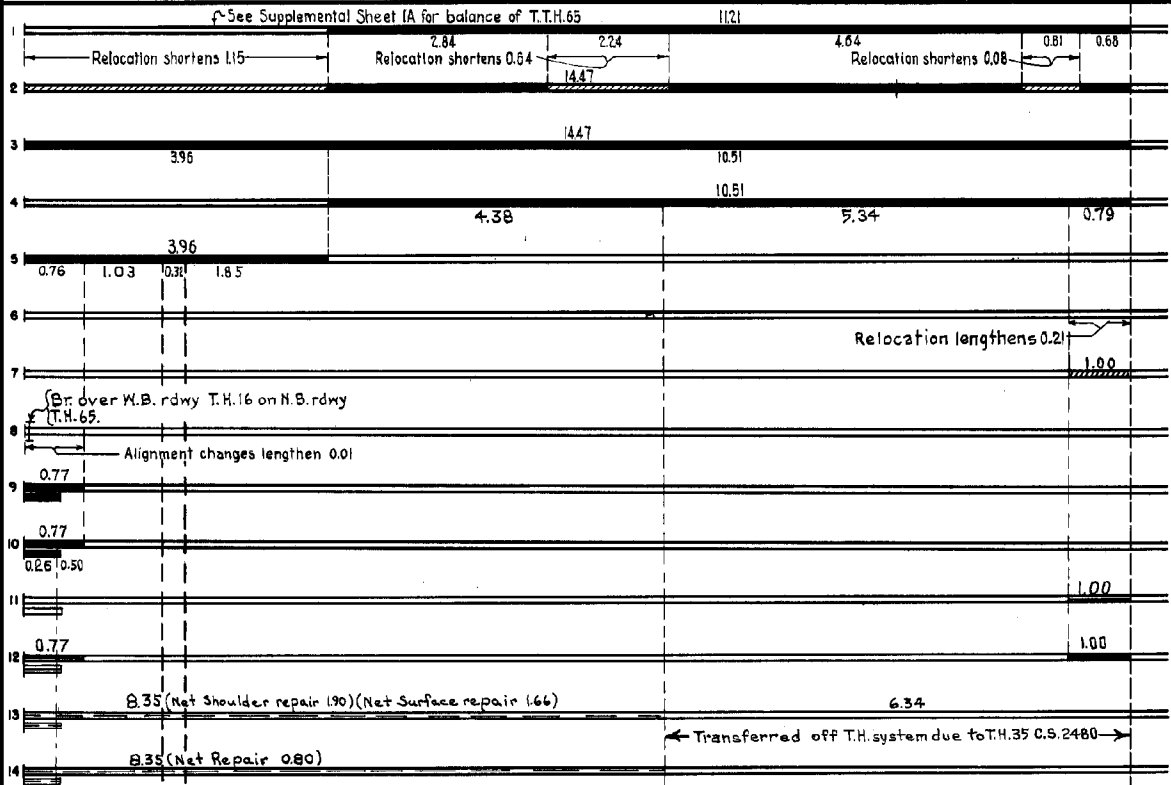

YEARS		TOTAL MILES	UNINCORPORATED		INCORPORATED		RURAL		URBAN		REMARKS: Layout is to scale as of 1932.
FROM	TO		RDWY. MI.	BR. MI.	RDWY. MI.	BR. MI.	RDWY. MI.	BR. MI.	RDWY. MI.	BR. MI.	
1921	1927	17.0	14.64	0.00	2.44	0.02	16.00	0.00	1.08	0.02	
1928	1928	19.23	13.96	0.00	1.85	0.02	14.47	0.00	0.74	0.02	
1929	1931	14.35	13.96	0.00	0.99	0.00	14.47	0.00	0.05	0.00	
1932	1934	14.41	13.95	0.00	0.31	0.00	14.47	0.00	0.02	0.00	
1935	1936	14.68	13.77	0.00	0.91	0.00	14.58	0.00	0.00	0.00	
1937	1962	14.69	13.74	0.04	0.91	0.00	14.65	0.04	0.00	0.00	
1963	1966	14.65	13.44	0.04	1.21	0.00	14.65	0.04	0.00	0.00	
1967	1967	8.35	7.85	0.04	0.46	0.00	8.31	0.04	0.00	0.00	

PREPARED BY
HIGHWAY PLANNING SURVEY
IN COOPERATION WITH
U. S. PUBLIC ROADS ADMINISTRATION

STATE OF MINNESOTA
DEPARTMENT OF HIGHWAYS
ROAD LIFE STUDIES
CONSTRUCTION PROJECT LOG RECORD

CONTROL SECTION 2405
TRUNK HIGHWAY 65
COUNTY Freeborn
DISTRICT 6B

LIMITS: E. Jct. T.H.16 - N. Co. Line

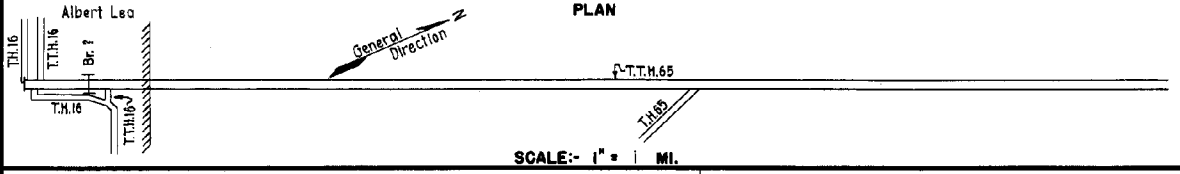

YEAR BUILT	PROJECT N°	DESCRIPTION			CODE N°
		TYPE	WIDTH	THICKNESS	
		Wood Block			No Record of Constr. Transferred to T.H. 16 in 1932.
		Wood Block			No Record of Constr. Transferred to T.H. 16 in 1929.
		Wood Block			No Record of Constr. Retired in 1929.
		Gravel Br. 1	30'		125' Br.
1919		Grading Gravel	24'	2"	Co. Job 1701. Retired in 1928.
1925	65=1-49	Concrete Br. 1	16'	7 1/2"	125' Br.(Br. Floor)
1925	65=1-49	Conc. Widening	2'-4"	7 1/2"	Widened by City.

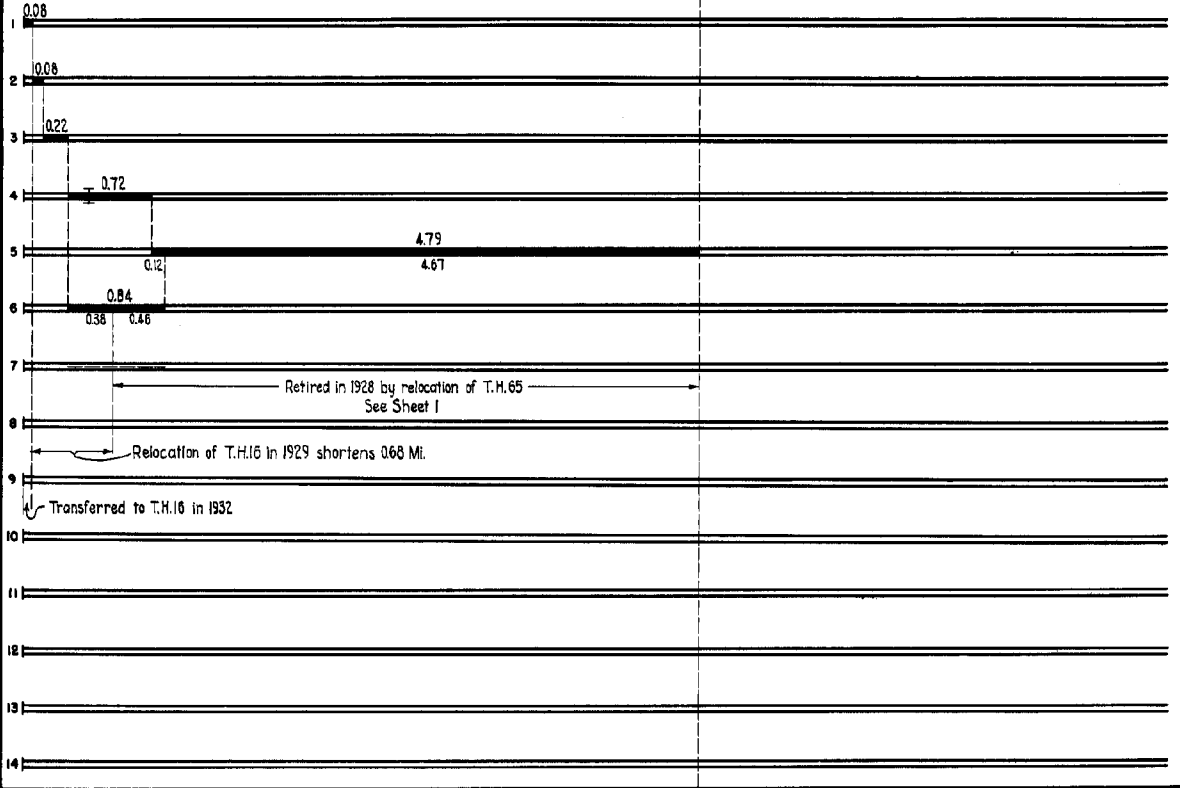

YEARS FROM TO		TOTAL MILES	UNINCORPORATED		INCORPORATED		RURAL		URBAN	
FROM	TO		RDWY. MI.	BR. MI.	RDWY. MI.	BR. MI.	RDWY. MI.	BR. MI.	RDWY. MI.	BR. MI.

REMARKS: Supplemental Sheet

See Sheet 1

PREPARED BY
TRAFFIC AND PLANNING DIVISION
IN COOPERATION WITH
U.S. DEPARTMENT OF COMMERCE
BUREAU OF PUBLIC ROADS

STATE OF MINNESOTA
DEPARTMENT OF HIGHWAYS
ROAD LIFE STUDIES
CONSTRUCTION PROJECT LOG RECORD

CONTROL SECTION 2405
TRUNK HIGHWAY 65
COUNTY Freeborn
DISTRICT 6B

LIMITS: E Jct. T.H. 16 (in Albert Lea) - N. Temp. Conn. T.H. 35

Albert Lea
0.09 Mi.

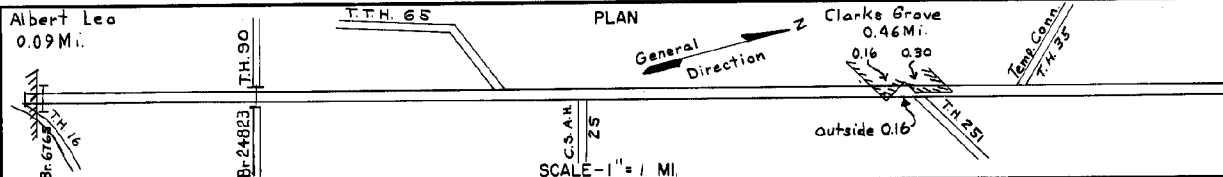

YEAR BUILT	PROJECT NO	DESCRIPTION			REMARKS
		TYPE	WIDTH	THICKNESS	
M 1969	SF & C	Spot Bit Overlay	20'	1"	AC-Task 300 Gal. Agg. 704 Tons
C 1970	2481-07	Grade Base Pl. Mix Bit Surf. Br. 24823*	24'	1 1/2"	*See C. 52481 for info
C 1971	2480-10	Grading & Base	2@5'	6"-20"	
C 1971	2480-25	Plant Mix Bit PC Concrete Bit Shoulders	2@24'	3 1/2"	0.66 Plant Mix Bit. 0.75 P.C.C.

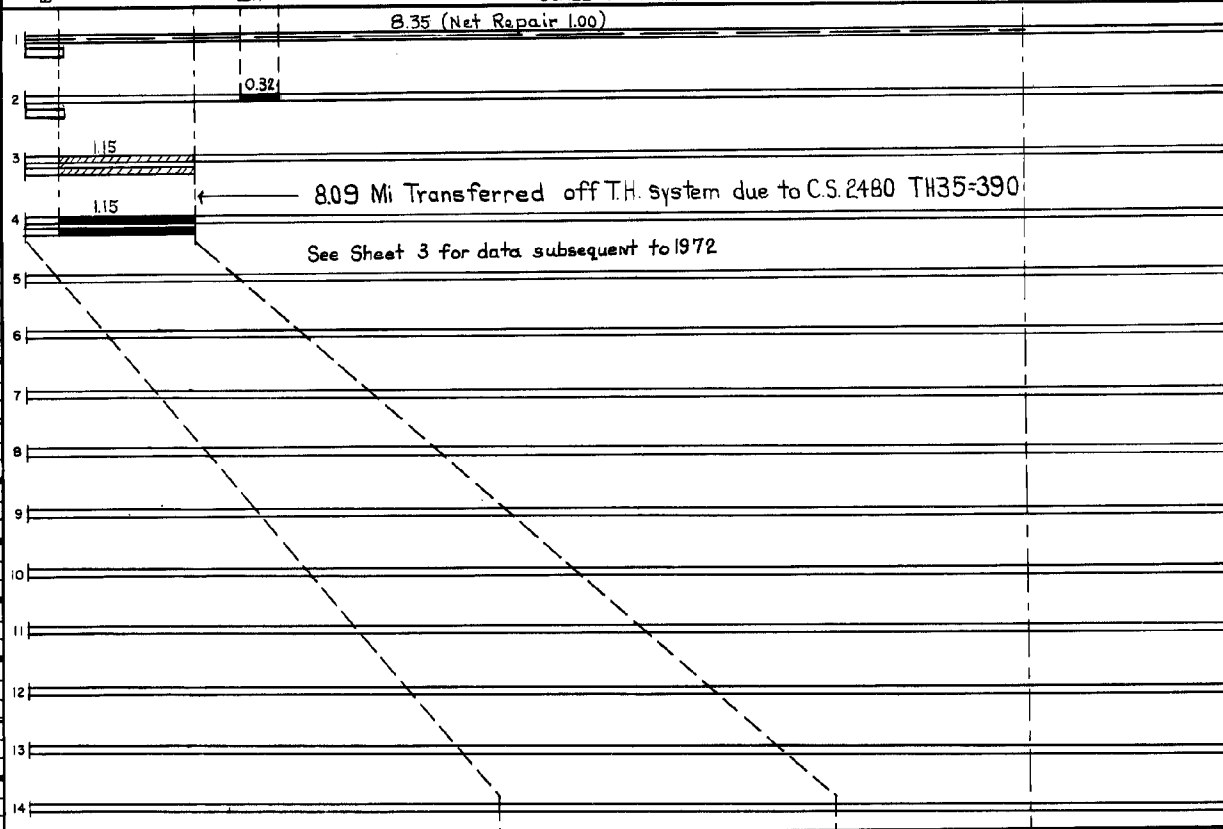

YEARS		TOTAL MILES	UNINCORPORATED		INCORPORATED		RURAL		URBAN	
FROM	TO		RDWY. MI.	BR. MI.	RDWY. MI.	BR. MI.	RDWY. MI.	BR. MI.	RDWY. MI.	BR. MI.
1968	1970	8.35	7.75	0.04	0.55	0.00	8.22	0.04	0.09	0.00
1971	1972	1.41	1.28	0.04	0.09	0.00	1.28	0.04	0.09	0.00

REMARKS: Layout is to Scale as of 1968

