

PREPARED BY
HIGHWAY PLANNING SURVEY
IN COOPERATION WITH
U. S. PUBLIC ROADS ADMINISTRATION

STATE OF MINNESOTA
DEPARTMENT OF HIGHWAYS
ROAD LIFE STUDIES
CONSTRUCTION PROJECT LOG RECORD

CONTROL SECTION 5615
TRUNK HIGHWAY 52
COUNTY Otter Tail
DISTRICT 4A

LIMITS: S. Jct. T.H. 59 - S. Co. Line.

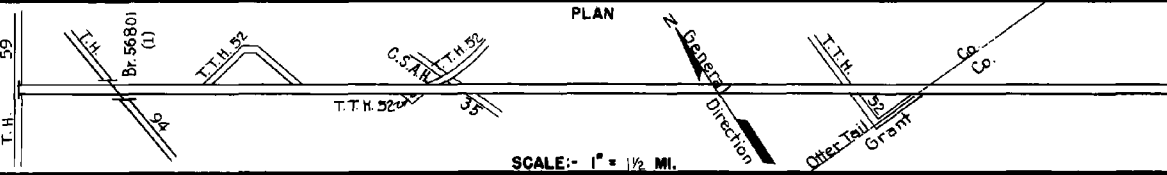

YEAR BUILT	PROJECT N°	DESCRIPTION			CODE N°
		TYPE	WIDTH	THICKNESS	
1920		Grading Gravel	24'	1 1/2" 2"	Co. Job 1910. Added in 1934.
1936	52-153-23-1A	Grading	32'		
1936	52-153-23-1C	Agg. Surfacing	24'	1 3/4"	800 C.Y./Mile.
1936	52-153-23-1B	Gravel	24'	1 3/4"	800 C.Y./Mile.
1936	52-153-23-1A	Gravel	24'	1 3/4"	800 C.Y./Mile.
1937	52-153-23-2	Grading Agg. Surfacing	32' 24'	1 3/4"	
C	1940 5615-02	8 in. Gravel Base Bit. Surf. Treat.	30' 28'	6" 3/4"	
M	1942 A.F.E. 5	Bit. Seal Coat	24'		RF-10, 3184 Gal./Mi. Agg. 114 CY/Mi. Maint. Dept.
M	1945 A.F.E. 4	Spot Treat. Bit. Surf. Repair	24'		MC-3, 1525 Gal./Mi. Grav. 65 C.Y./Mi. Maint. Div.
C	1947 A.F.E. 19	Bit. Resurfacing Mixed Bit.	24'	1" Added	MC-3, 100563 Gal. Agg. 8351 Tons
C	1948 A.F.E. 4	Bit. Fog Seal	24'		MC-2, 19504 Gal. Agg. 750 C.Y.
M	1970 A.F.E. 4	Spot Treat. Bit. Surf. Repair	24'		MC-3, 38310 Gal. Agg. 2820 Tons
M	1952 A.F.E. 4	Spot Treat. Bit. Surf. Repair	24'		MC-3, 45545 Gal. Agg. 3500 Tons
M	1954 A.F.E. 605	Light Bit. Seal	24'		RS-2, 23357 Gal. Agg. 720 C.Y.

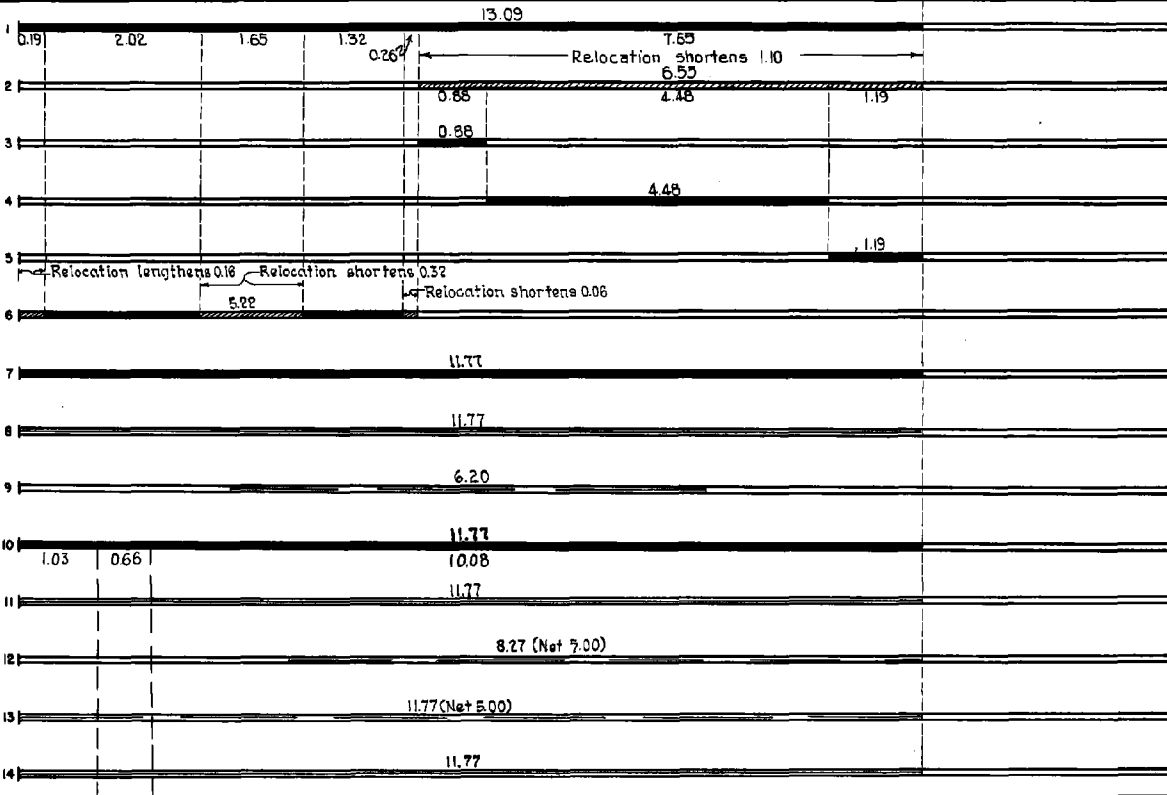

YEARS FROM	TO	TOTAL MILES	UNINCORPORATED		INCORPORATED		RURAL		URBAN	
			RDWY. MI.	BR. MI.	RDWY. MI.	BR. MI.	RDWY. MI.	BR. MI.	RDWY. MI.	BR. MI.
1934	1935	13.09	2.12	0.00	0.97	0.00	3.09	0.00	0.00	0.00
1936	1936	11.89	1.11	0.00	0.88	0.00	1.99	0.00	0.00	0.00
1937	1938	11.77	10.89	0.00	0.88	0.00	11.77	0.00	0.00	0.00
1959	1963	11.77	11.77	0.00	0.00	0.00	11.77	0.00	0.00	0.00
1964	1964	11.78	11.73	0.05	0.00	0.00	11.73	0.05	0.00	0.00
1965		0.00	0.00	0.00	0.00	0.00	0.00	0.00	0.00	0.00

REMARKS: Layout is to scale as of 1937.
(1) Br. 5680' a 27.5' B.S.T.H. 52 over T.H. 94 no intersection or interchange at this bridge.

PREPARED BY
HIGHWAY PLANNING SURVEY
IN COOPERATION WITH
U. S. PUBLIC ROADS ADMINISTRATION

STATE OF MINNESOTA
DEPARTMENT OF HIGHWAYS
ROAD LIFE STUDIES
CONSTRUCTION PROJECT LOG RECORD

CONTROL SECTION 5615
TRUNK HIGHWAY 52
COUNTY Otter Tail
DISTRICT 4A

LIMITS: S. Jct. T.H. 59 - S. Co. Line

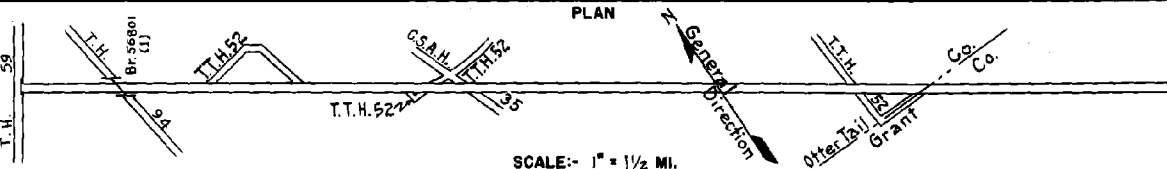

YEAR BUILT	PROJECT N°	DESCRIPTION			CODE N°
		TYPE	WIDTH	THICKNESS	
M 1956	A.F.E. 604	Spot Treat Bit. Surf. Repair	24'		
M 1958	A.F.E. 604	Spot Treat Bit. Surf. Repair	24'		
M 1959	A.F.E. 604	Spot Treat Bit. Surf. Repair	24'	1"	
M 1960		Spot Treat Bit. Surf. Repair	24'		
M 1961		Light Bit. Seal	24'		
M 1962		Spot Treat Bit. Surf. Repair	24'		
M 1963		Spot Treat Bit. Surf. Repair	24'	1"	
C 1964	5680-26&45	Grading, Sub-base or Bit. base Bit. Surf.	24'	5 1/4" 3 1/4"	
M 1965	C	Bit. Surf. Repair			

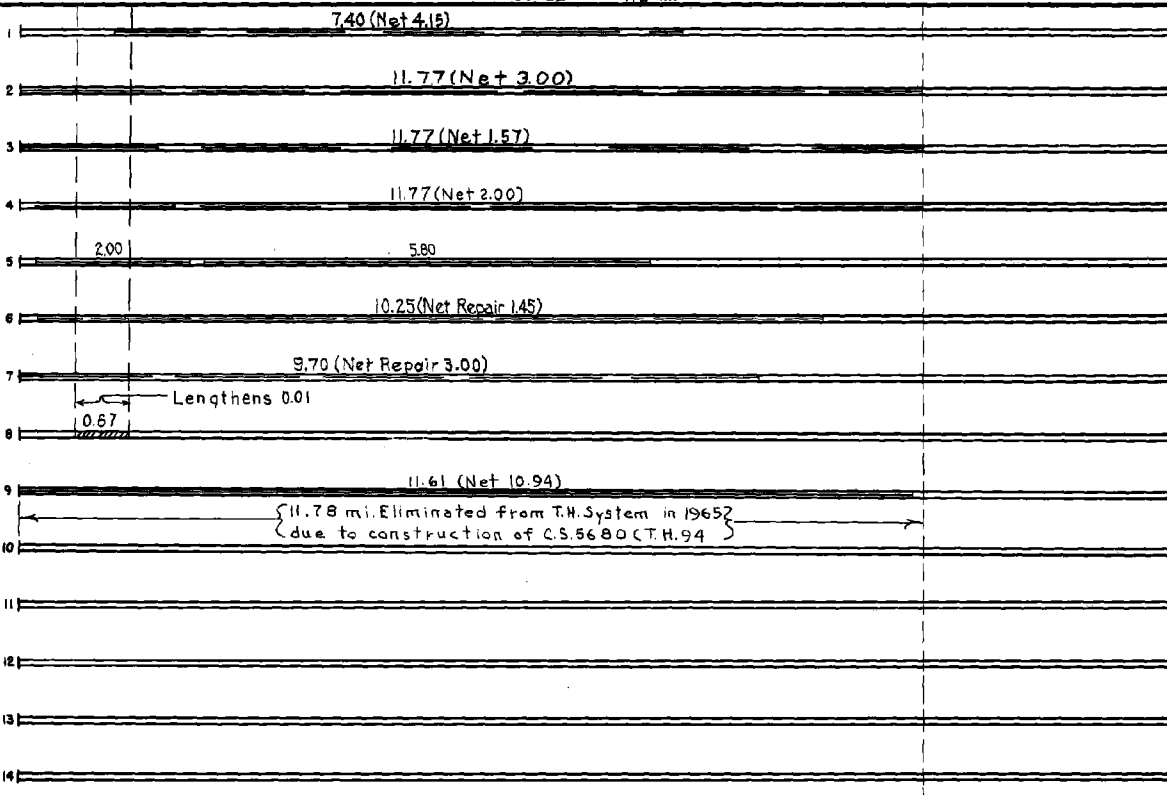

YEARS		TOTAL MILES	UNINCORPORATED		INCORPORATED		RURAL		URBAN		REMARKS
FROM	TO		RDWY. MI.	BR. MI.	RDWY. MI.	BR. MI.	RDWY. MI.	BR. MI.	RDWY. MI.	BR. MI.	
											See Sheet No. 1