

LIMITS: (In Duluth) Jet. T.H. 535 - W. Lim. Duluth

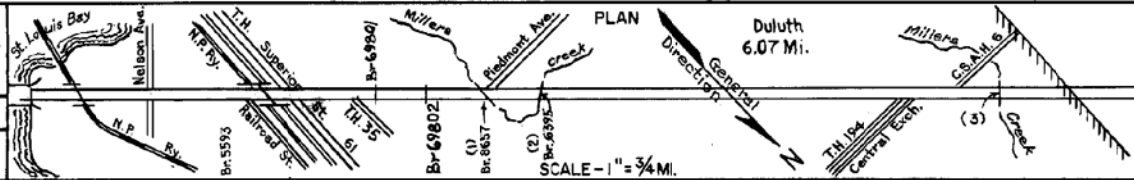

YEAR BUILT	PROJECT NO	DESCRIPTION			
		TYPE	WIDTH	THICKNESS	REMARKS
		Sand-Stone Block 165 M.			Entered into Highway System in 1934
		Concrete 395			
		Culvert W1010X 138			
1934	53-106-21	Soil Subgrade			
		Concrete	40'		
C	6915-01	Sand backfill		8"	
1938	6915-02	Concrete	41'	9-7-9	
C	6915-03	Grading	41'		
C	6915-04	Widening (New Lane)			
1939	6915-04	Agg. Base	28'	9'-12"	
C	6915-05	Br. 5593	41'		867' D.P.G. - O.H.
		Concrete			
C	6915-10	Extend Culvert			W1010X 138
1939	6915-11	Agg. Base	41'	20"	Extend 22' Lt.
		Mixed Bit.	28'	1"	6915-12- Seeding
C	6915-09	Grading Gravel Lift	28'	1'-1 1/2'	
		Concrete	22'	9-6-9	
		Gravel Shoulders	2"	10' Rt. & 5' Lt.	
C	6915-18	Concrete	20' 21"	9-6-9	
		Gravel Shoulders	8'		Rt. & Lt.
C	6915-19	Base Gravel	28'	4 3/4"	N.B. Rdwy
1942	6915-19	Concrete	22'	9-6-9	
		Gravel Shoulders	2'-3"	5' Lt. & 10' Rt.	
M	AFE 24	Removal of Lip Curbs			
		ditch Widening			
		Gravel Shoulders			
C	6915-33	Concrete in place	20' 22"	9-6-9	
		Pl Mix Bit Surf	20' 22"	3"	
		Gravel Shoulders	5'-10"		10' outside - 5' inside
M	AFE B28	Asphaltic Conc.	41'	3"	
C	6915-36	Bit. Stab. Gravel Base	40'	7"	#1 Rd Mix - 6" Gravel
		Plant Mix Bit.	24'	3"	
		Gravel Shoulders			

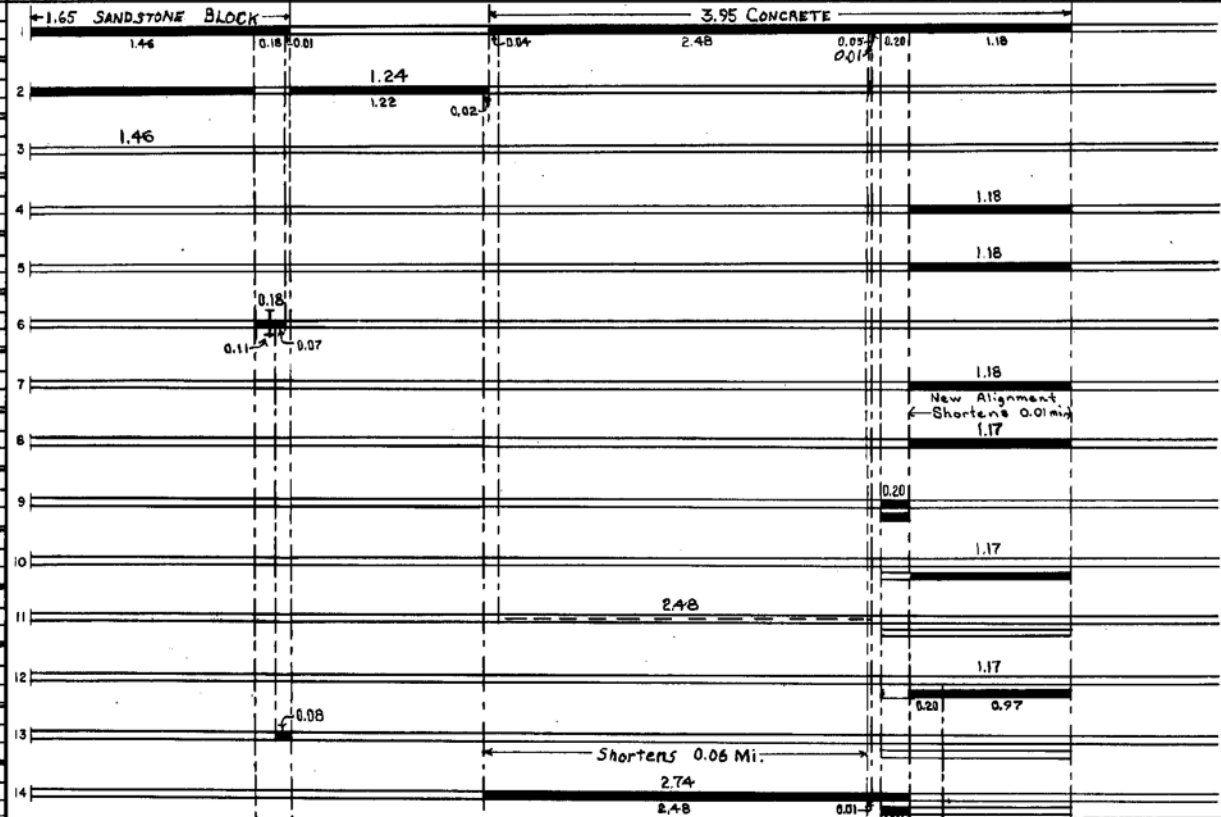

YEARS		TOTAL MILES	UNINCORPORATED		INCORPORATED		RURAL		URBAN	
FROM	TO		RDWY. MI.	BR. MI.	RDWY. MI.	BR. MI.	RDWY. MI.	BR. MI.	RDWY. MI.	BR. MI.
1934	1940	6.84	0.00	0.00	6.67	0.17	0.00	0.00	6.67	0.17
1940	1953	6.83	0.00	0.00	6.66	0.17	0.00	0.00	6.66	0.17
1953	1961	6.78	0.00	0.00	6.61	0.17	0.00	0.00	6.61	0.17
1961	1968	6.02	0.00	0.00	5.85	0.17	0.00	0.00	5.85	0.17
1968	1974	6.07	0.00	0.00	5.90	0.17	0.00	0.00	5.90	0.17
97		6.99			6.97	0.52			6.97	0.52

REMARKS: Layout is to scale as of 1969.
(1) 8657-W1213, 1'-5" span; (2) 6395-20' P.C. Arch.; (3) W1010

PREPARED BY
TRAFFIC AND PLANNING DIVISION
IN COOPERATION WITH
U.S. DEPARTMENT OF COMMERCE
BUREAU OF PUBLIC ROADS

STATE OF MINNESOTA
DEPARTMENT OF HIGHWAYS
ROAD LIFE STUDIES
CONSTRUCTION PROJECT LOG RECORD

CONTROL SECTION 6915
TRUNK HIGHWAY 53
COUNTY St. Louis
DISTRICT 1A1

LIMITS: (In Duluth) Jct. T.H. 535 - W. Lim. Duluth

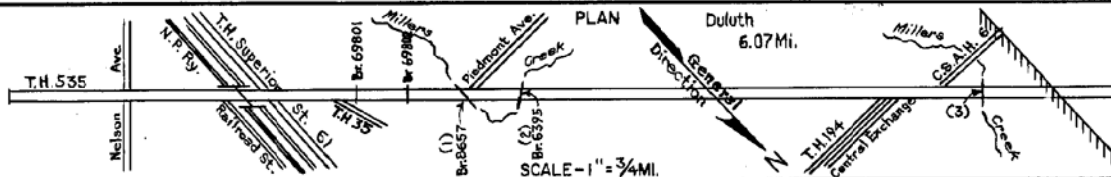

YEAR BUILT	PROJECT NO.	DESCRIPTION				REMARKS
		TYPE	WIDTH	THICKNESS		
M 1955	AFE-623	Asphaltic Conc. on Old Conc. in place	40'	3"		Divided 2@20' 0.16 mi
M 1956	AFE-621	Asphaltic Conc. on Old Conc. in place	40'	3"		
M 1961	6915-43	Repair of Traffic Control System				On Garfield Ave. at Jct. T.H. 61 (Superior St.)
M 1962	6915-42	Channelization of intersection at Jct. T.H. 61 (Superior St.)				Turn Lanes on N.B. & S.B. Lanes.
M 1963	6915-49	Traffic Signals				at Nelson Ave. & Garfield
M 1965	6915-50	Channelization & Lighting Misc. Construction				Jct. T.H. 53 & Maple Grove Rd (C.S.A.H. 6)
M 1966	Maint. Proj.	Plant Mix Bit	2022'	1 1/2"		0.23 exception at C.S.A.H. 6
C 1968	6915-60	Channelization Asphaltic Conc.	Var.	1 1/2"		0.07 Transferred in from C.S. 6935 in 1968
C 1970	6915-53 6915-63	Traffic Signals				at Railroad St. at Maple Grove Rd.
C 1970	6915-70	Asphaltic Concrete Gravel Shoulders	21'	5/8"		
C 1974	6980-16 I 535-7(25)25	Br. 69801	2021'			
C 1974	6980-27 I 535-7(25)26	Br. 69802 A	2034'			
C 1974	6915-56A	Br. 69802 B	2038'			
C 1971	-69	TRAFFIC SIGNALS				At T.H. 23/W. 1st. St.

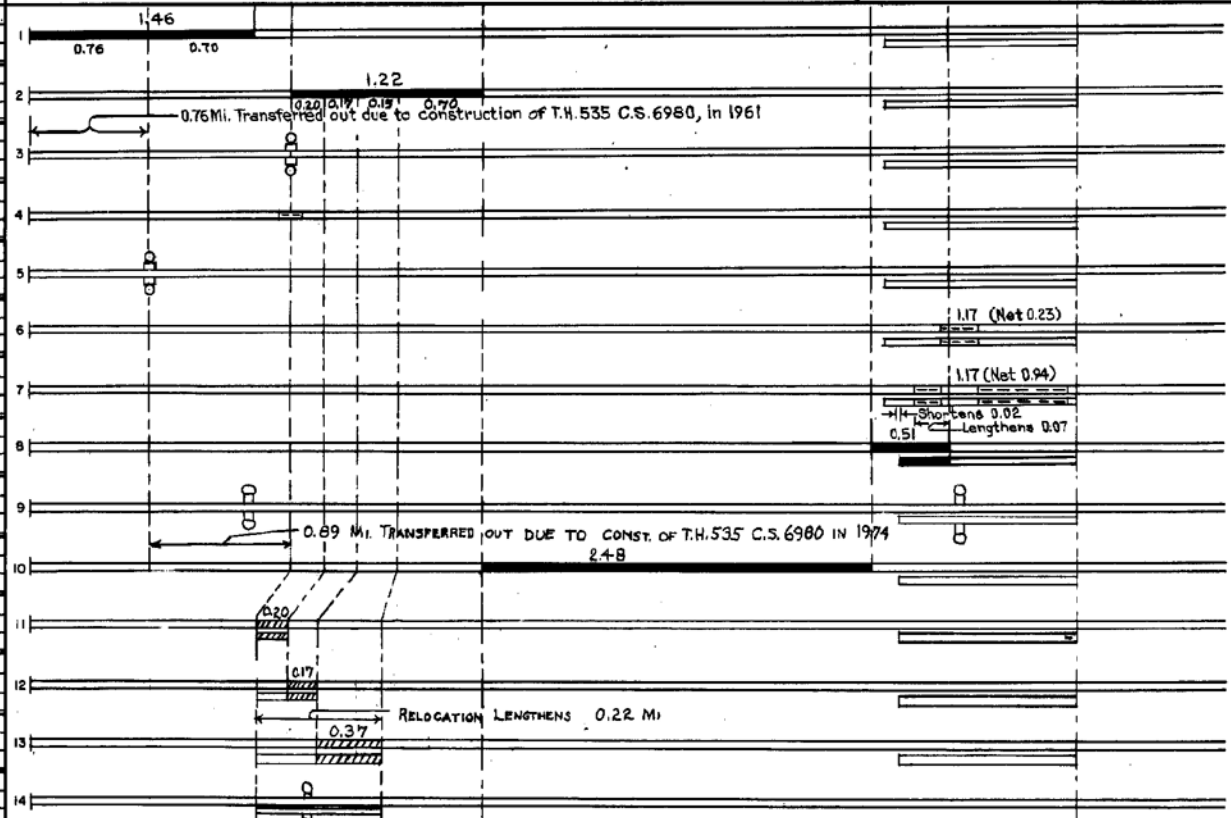

YEARS		TOTAL MILES	UNINCORPORATED		INCORPORATED		RURAL		URBAN	
FROM	TO		ROWY. MI.	BR. MI.	ROWY. MI.	BR. MI.	ROWY. MI.	BR. MI.	ROWY. MI.	BR. MI.

REMARKS: See sheet No. 1

PREPARED BY
TRANSPORTATION PLANNING AND PROGRAMMING DIVISION
IN COOPERATION WITH
U.S. DEPARTMENT OF TRANSPORTATION - FEDERAL HIGHWAY ADMINISTRATION

STATE OF MINNESOTA
DEPARTMENT OF HIGHWAYS
ROAD LIFE STUDIES
CONSTRUCTION PROJECT LOG RECORD

CONTROL SECTION 6915
TRUNK HIGHWAY 53
COUNTY ST. LOUIS
DISTRICT 1A1

LIMITS: (IN DULUTH) JCT. T.H. 535 - WEST LIMITS OF DULUTH
Ref. Pt. 001+00.541 - 006+00.862

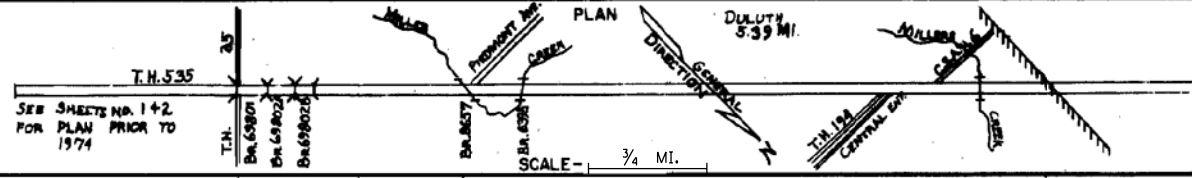

YEAR BUILT	PROJECT NO	DESCRIPTION	WIDTH	THICKNESS	REMARKS
C	-73	TRAFFIC SIGNALS			AT JCT. OF C.S.A.H. 91
1973	FO08-4(53)	RT. & LT. TURN LANES			
C	-83	ASPHALTIC CONC.	40'	1 1/2"	
1974					
C	-86	PL. MIX DPT. SHLDRS	10'		
1975					
C	6915-78	TRAFFIC CONTROL SIGNAL SYSTEM			ON TRAIL AT BIRKEN ST & MILLER MALL INTERSECTION
1974	1008-4(40)				
C	6915-74	TURN L.A. EXTN. AND CONCR. BIT OVERLAY, SHOULDER & SURF.	20' 2 1/2"	1 1/2"	STA. 40+80 TO STA. 40+80 TO 102+98.60
1973			13'		
C	6915-99	Bituminous Surfacing & Shouldering	24'	3/4"	288 Tons - Asphalt Concrete 3243 Tons -
1979	SF				
C	6900-19	Traffic Barrier Construction			
1981	MS0008(47)				
C	6915-69802	Repair Expansion Joints			Br. 69802 C Br. 69802 D Br. 69802 E
1984	SF	Contract No. 18117			
C	6915-101	Asp. & Bit. Base	2-30'	1 1/2"	
1984		Bit. Surfacing	2-24'	2 1/4"	
		Bit. Shoulders	10-3'	2"	
C	6915-101	Grading		1 1/2"	Spec. 2331
1986		Bit. Surfacing	24'	3/4"	Spec. 2361
C	6915-102	Mill & Bit Overlay	Var	1"	Spec. 2361
1987					
C	6915-110	Bit. Overlay	24'	1 1/2"	Spec. 2361
1991					
S	6933-81	Mill & Bit Overlay	24'	3"	Spec. 2350
2000			40'	3"	Spec. 2350
S	6915-104	Grading Bit Surface	24'	7"	Spec. 2350
2001					

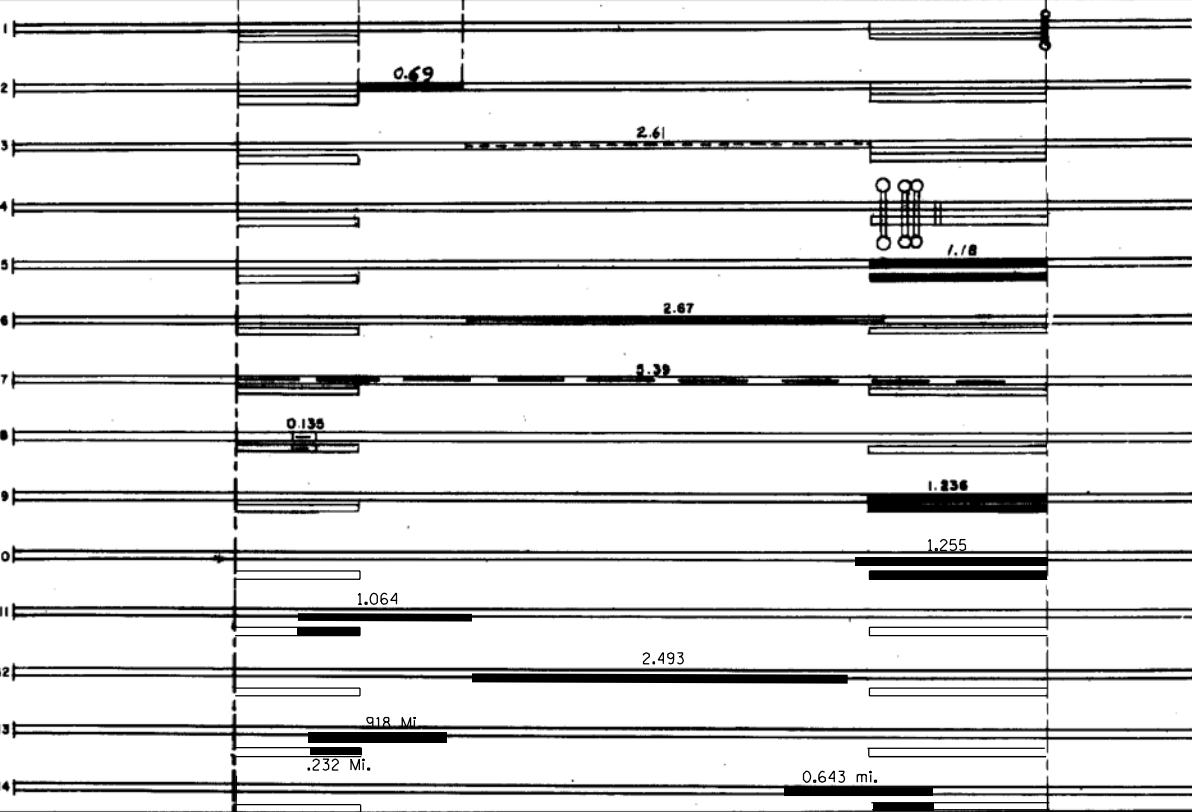

YEARS FROM TO		TOTAL MILES	UNINCORPORATED RDWY. MI.		INCORPORATED RDWY. MI.		RURAL RDWY. MI.		URBAN RDWY. MI.	
BR. MI.	BB. MI.	BR. MI.	BR. MI.	BR. MI.	BR. MI.	BR. MI.	BR. MI.	BR. MI.	BR. MI.	

REMARKS: SEE SHEET No. 1 .241

