

PREPARED BY
HIGHWAY PLANNING SURVEY
IN COOPERATION WITH
U.S. PUBLIC ROADS ADMINISTRATION

STATE OF MINNESOTA
DEPARTMENT OF HIGHWAYS
ROAD LIFE STUDIES
CONSTRUCTION PROJECT LOG RECORD

CONTROL SECTION 7909
TRUNK HIGHWAY 74
COUNTY Yabasha
DISTRICT 6A

LIMITS: S. Co. Line - Jct. T.H. 61
Ref. Pt. 051+00.989 - 055+00.393

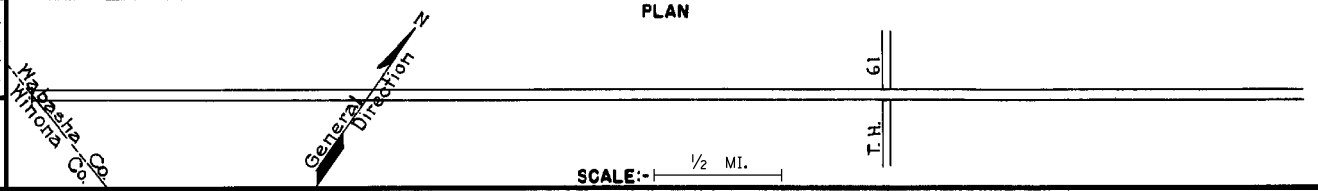

YEAR BUILT	PROJECT N°	DESCRIPTION			CODE N°
		TYPE	WIDTH	THICKNESS	
		Gravel	24'		No Record of Constr. Added in 1934
C	1947 A.F.E. 22	Regrading			Maint. Dept.
C	1947 A.F.E. 6	Crushed Rock Surfacing			709 C.Y./Mi. Maint. Dept.
	(D)	Bit. Surf.-Treated	24'	3/4"	
M	1949 A.F.E. 4	Bit. Surf. Repair	24'		MC-3, 858 Gal. Agg. 45 C.Y.
M	1949 A.F.E. 6	Crushed Rock Resurfacing (Spots)			470 C.Y.
M	1950 A.F.E. 6	Crushed Rock Resurfacing (Spots)	24'		782 Tons
M	1951 A.F.E. 4	Bit. Surf. Repair	24'		MC-3, 1880 Gal. Agg. 102 C.Y.
M	1952 A.F.E. 6	Crushed Rock Resurfacing	24'		1577 Tons
M	1953 A.F.E. 604	Bit. Surf. Repair	24'		MC-3, 240 Gal. Agg. 15 C.Y.
M	A.F.E. 866	Repair Culvert			
M	1954 A.F.E. 818	Bit. Surf. Repair	24'		MC-3, 3452 Gal. Agg. 260 Tons
C	7904-18	Grade - Bit. Base Surf.	24'	7"	
C	7904-25	P. Mix. Bit.	24'	2"	
		Gravel Shoulders	12'		
M	1978 SF	Bit. Overlay SAND SEAL	20'	3/4"	P. Mix AC 2241 300 T. RC 800 Tack 550 Gal.
C	1989 7909-01	Grading Bit. Overlay	23'	2"	Spec. 2331

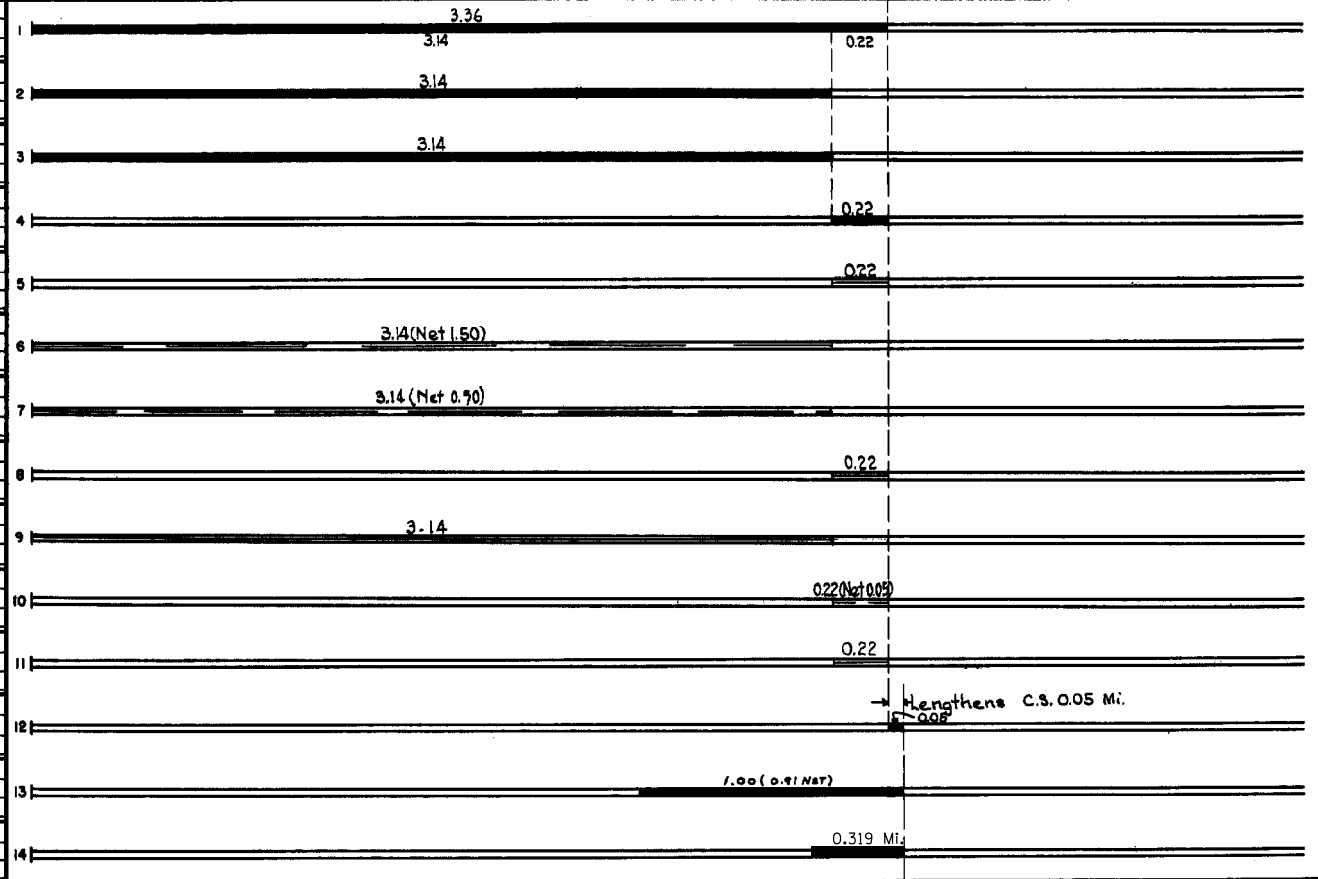

YEARS FROM	TOTAL MILES TO	UNINCORPORATED		INCORPORATED		RURAL		URBAN	
		RDWY. MI.	BR. MI.	RDWY. MI.	BR. MI.	RDWY. MI.	BR. MI.	RDWY. MI.	BR. MI.
1934	3.36	3.36	0.00	0.00	0.00	3.36	0.00	0.00	0.00

REMARKS: Layout is to scale as of 1934
(D) No record of this work. Maint. foreman indicates 1938.

