

PREPARED BY
HIGHWAY PLANNING SURVEY
IN COOPERATION WITH
U.S. PUBLIC ROADS ADMINISTRATION

STATE OF MINNESOTA
DEPARTMENT OF HIGHWAYS
ROAD LIFE STUDIES
CONSTRUCTION PROJECT LOG RECORD

CONTROL SECTION 8710
TRUNK HIGHWAY 75
COUNTY Yellow Medicine
DISTRICT 8B

LIMITS: S. Co. Line - Jct. T.H. 68 in Canby

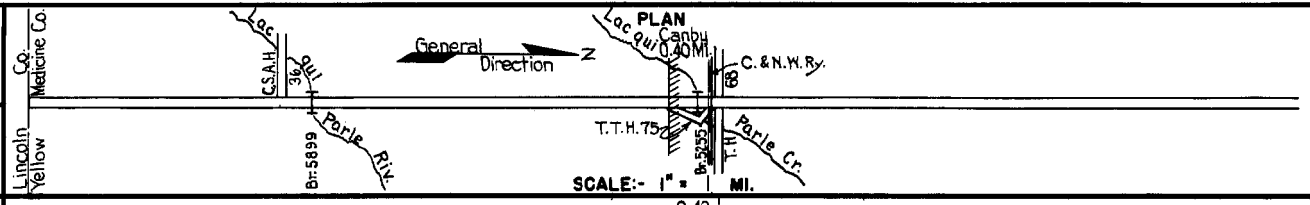

YEAR BUILT	PROJECT N ^o	DESCRIPTION			CODE N ^o
		TYPE	WIDTH	THICKNESS	
		Gravel			1
		Br. 537	20'		
		Grading	24'		
1920	75-6-20J&K	Gravel	24'	2 1/2"	2
		Br. 2237	18'		
	(1)				
1931	75-6-20K	Tar Tr. Gravel	22'	1"	3
1931		Tar Tr. Gravel	22 3/8'		4
		Tar Tr. Gravel	20'		5
1933	75-6-51-4	Grading	40'		
		Gravel	32'	4"	6
		Br. 5255	30'		
	(1)				
1934	75-6-51-4	Oil Tr. Gravel	20'		7
M					
1940	A.F.E. 40	Bit. Retreat			8
C					
1941	8710-02	Br. 5899	30'		9
C					
1941	8710-07	Ext. Mono. Culverts			
	8710-03	Grading	36'		10
		Gravel			
C					
1941	A.F.E. 56	Seeding			11
C					
1942	8710-08	Stab. Grav. Base	32'	6 1/2"	12
M					
1945	A.F.E. 5	Bit. Seal Coat			13
C					
1947	8710-10	Stab. Grav. Base	Var. 6 1/2"		14
		Plant Mix. Bit.	24'	1 1/2"	

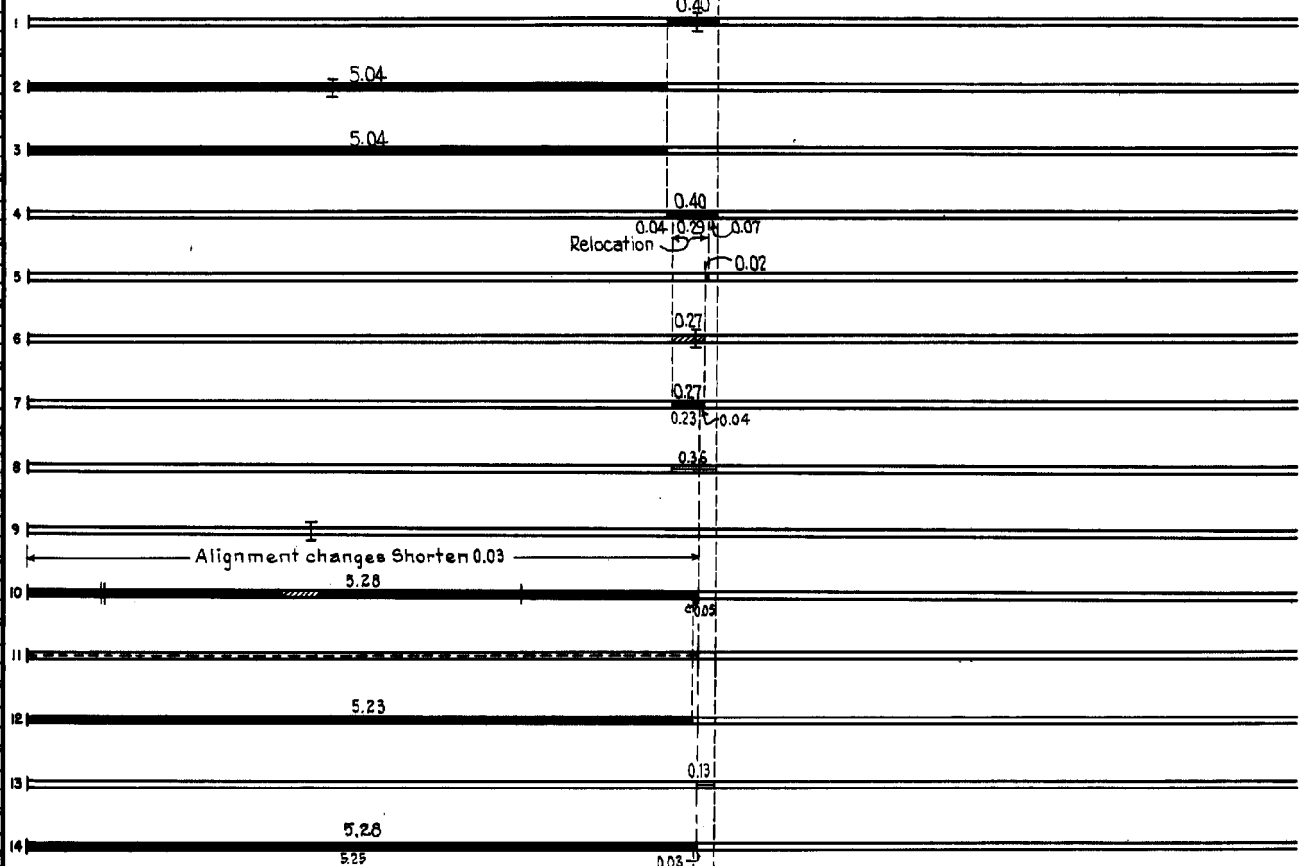

YEARS		TOTAL MILES	UNINCORPORATED		INCORPORATED		RURAL		URBAN	
FROM	TO		RDWY. MI.	BR. MI.	RDWY. MI.	BR. MI.	RDWY. MI.	BR. MI.	RDWY. MI.	BR. MI.
1927	1932	5.44	5.03	0.01	0.39	0.01	5.03	0.01	0.39	0.01
1933	1940	5.44	5.03	0.01	0.38	0.02	5.03	0.01	0.38	0.02
1941		5.41	5.00	0.01	0.38	0.02	5.00	0.01	0.38	0.02

REMARKS: Layout is to scale as of 1933.

(1) This work not done under these project numbers but lies within the limits of these projects.

PREPARED BY
HIGHWAY PLANNING SURVEY
IN COOPERATION WITH
U.S. PUBLIC ROADS ADMINISTRATION

STATE OF MINNESOTA
DEPARTMENT OF HIGHWAYS
ROAD LIFE STUDIES
CONSTRUCTION PROJECT LOG RECORD

CONTROL SECTION 8710
TRUNK HIGHWAY 75
COUNTY Yellow Medicine
DISTRICT 8B

LIMITS: S. Co. Line - Jct. T.H. 68 in Canby

Ref. Pt. 080+00.974 - 086+00.381

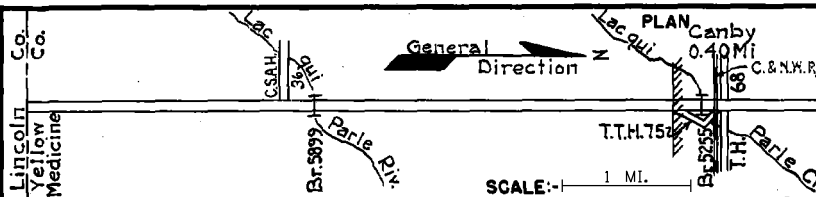

YEAR BUILT	PROJECT N°	DESCRIPTION			CODE N°
		TYPE	WIDTH	THICKNESS	
M	1948 A.F.E. 5	Bit. Seal Coat	24'		
				RC-3, 12102 Gal. Agg. 409 C.Y.	
C	1951 8710-11	Concrete	30' 8"		
	(2)			added thickness	
C	1953 8710-12	Bit. Stab. Base Plant Mix Bit.	32' 24'	6' 2"	
C	1967 8710-16	Plant Mix Bit. Gravel Shoulders	24'	2"	over surf. in place
C	1983 8710-19, 21	Bit. Surfacing Turn Lanes	28' 12'	3" 20"	
M	1988 SF	Bit. Sealing			
M	1991 SF	Joint Repair			
C	1997 8710-26	Grading Agg. Base Bit. Surfacing	51' 28' 28'	3' 3'	Class 5, Class 3 Spec. 2331, 2341
C	1997 8710-28	Grading Agg. Base Bit. Surfacing	56' 54' 48'	3' 4'	Class 5 Spec. 2331
C	2005 8710-29	Bit. Overlay Culvert Repair	24'	1.5"	Spec. 2360
M	2012 8828-143	Agg. Seal Fog Seal			FA-2
C	2019 8710-33	Grading Bit. Mill & Surfacing & RTL/Bypass Ln	28' 10'	2" 2"	Spec. 2360 3' shldr's agg. surf. cl.1

1	5.28	
2		0.16
3	5.25	
4	5.25	
5	Gross 5.259 (Net 5.22)	
6	5.253 Mi.	
7		0.171 Mi.
8	0.244 Mi.	
9		0.401 Mi.
10	4.98 Mi.	
11	5.006 Mi.	
12	4.973 Mi. net	
13		
14		

YEARS		TOTAL MILES	UNINCORPORATED		INCORPORATED		RURAL		URBAN	
FROM	TO		RDWY. MI.	BR. MI.	RDWY. MI.	BR. MI.	RDWY. MI.	BR. MI.	RDWY. MI.	BR. MI.

REMARKS: See Sheet N° 1
(2) Contract not final but work substantially complete.